

PART NUMBER	REVISION	DESCRIPTION
2276091-1	C	MID SIZE WIRE APPLICATOR-EF
7-2276091-1	C	MID SIZE WIRE APPLICATOR-EF AND CRIMP TOOLING KIT
7-2276091-7	C	SPECIAL SPARE KIT - MID SIZE

CRIMP DATA

TERMINAL DESCRIPTION
RING TONGUE

WIRE ADJUSTMENT DISC POSITION	CRIMP HEIGHT	WIRE SIZE
A8	5.05 mm (.200 in)	6 AWG
C6	4.65 mm (.183 in)	8 AWG
E4	4.25 mm (.167 in)	10 AWG

WIRE STRIP LENGTH 10.0 MM ± 0.3 MM	TERMINAL APPLICATION SPECIFICATION 114-2084

CRIMPER	CRIMP WIDTH	CRIMPER PROFILE	APPLICATOR FEED
WIRE CRIMPER	7.11 mm (.280 in)	F	31.50 MM
INS. CRIMPER	-	-	

INSULATION RANGE - MM	WIRE RANGE 10 - 6 AWG	GAUGE 1707132-4

TERMINALS APPLIED:

TERMINAL	SEAL	TERMINAL	SEAL
61546	-	-	-

NOTES:

- △ RECOMMENDED SPARE PARTS
- △ GREASE BEARING SURFACES LIGHTLY
- 3- UNLESS SPECIFIED OTHERWISE TORQUE VALUES SHALL BE USED PER DOCUMENT, 101-35000.
- 4- APPLICATOR TO BE USED ON BENCH TERMINATORS ONLY.
- 5- RECOMMENDED TERMINATOR:
G11+ TERMINATOR
PN 2844800-1 OR 2844800-2 (W/ COM).
*SEE CORRECT GUARD INSERT ACCORDING APPLICATOR STYLE INDICATED IN TERMINATORS CATALOG 2338133-1.

REVISIONS					
P	LTN	DESCRIPTION	DATE	OWN	APVD
A		RELEASED	07MAY2015	EAO	WAO
B		ECO-15-011150	19AUG2015	DLO	WAO
C		ECR-21-007255	16AUG2021	DLO	DLO

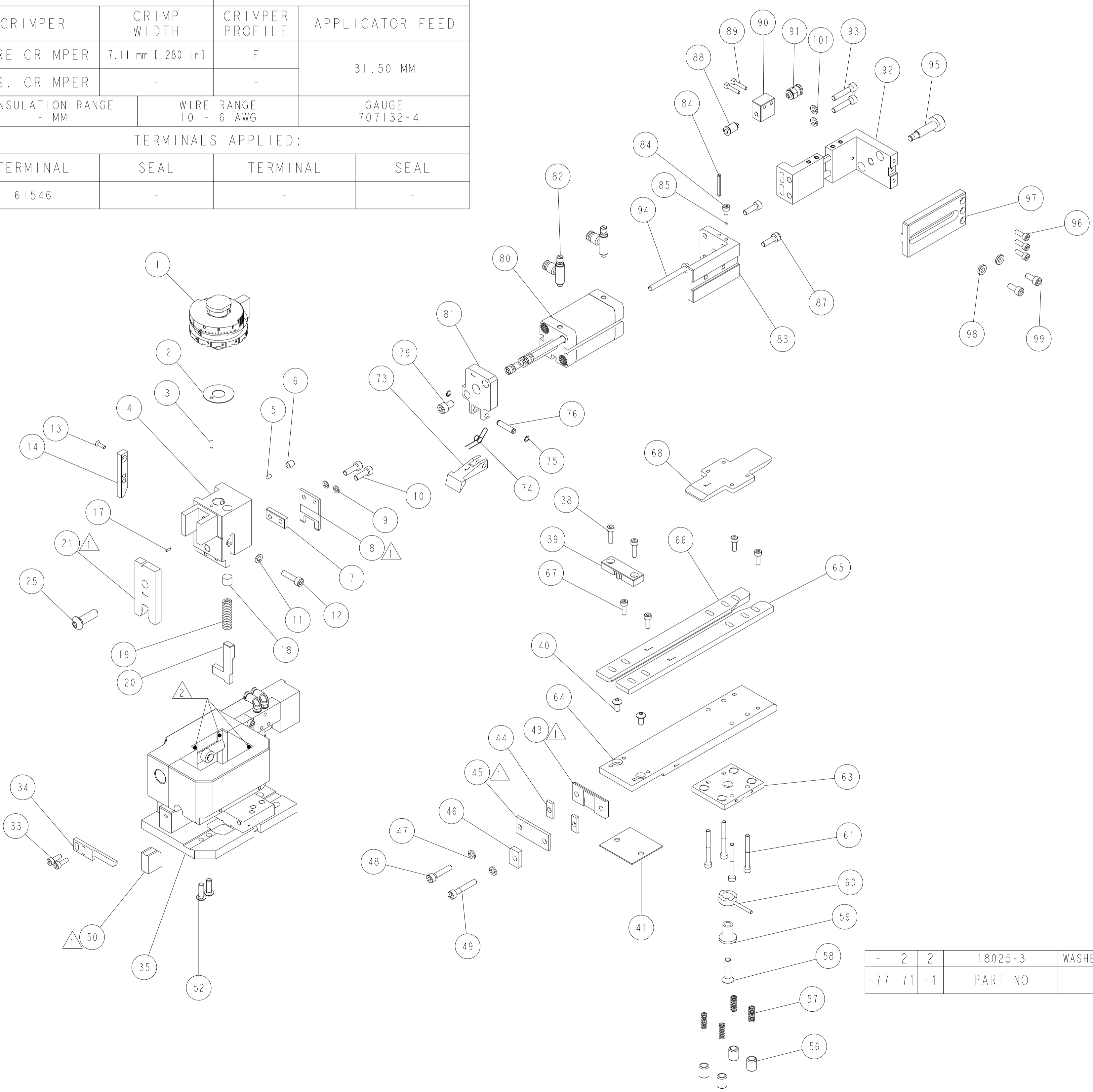

QTY	ITEM NO	PART NO	DESCRIPTION	ITEM NO
-	2	2	1-18023-9 SCR, SKT HD CAP M5 X 12.0	99
-	2	2	624445-2 WASHER FLAT, SPECIAL	98
-	1	1	2076138-1 PLATE, CYLINDER ADJUSTMENT	97
-	3	3	1-18023-2 SCR, SKT HD CAP M4 X 12.0	96
-	1	1	624368-2 SCREW, CYLINDER ADJUSTMENT	95
-	1	1	2-18018-2 SCR, PAN SLT HD MACH M5 X 50.0	94
-	2	2	2-18023-2 SCR, SKT HD CAP M5 X 25.0	93
-	1	1	2076798-2 SUPPORT, SET FEEDING	92
-	1	1	3-197574-9 COUPLING	91
-	1	1	624366-2 FAST COUPLER SUPPORT	90
-	2	2	18023-6 SCR, SKT HD CAP M3 X 16.0	89
-	1	1	9-197017-3 COUPLING	88
-	2	2	2-18023-0 SCR, SKT HD CAP M5 X 16.0	87
-	1	1	690191-5 PLUG, NYLON	85
-	1	1	18023-9 SCR, SKT HD CAP M4 X 6.0	84
-	1	1	5-21028-9 PIN, SLOTTED SPRING .125 X 1.000	84
-	1	1	2076137-1 CYLINDER SUPPORT	83
-	2	2	9-197017-1 FLOW CONTROL VALVE, GRILA-M5-QS-4-D	82
-	1	1	2076139-4 HOLDER, FEED FINGER	81
-	1	1	4-2076140-1 COMPACT CYLINDER, ADNGF-25-40-P-A	80
-	1	1	2-18023-6 SCR, SKT HD CAP M6 X 10.0	79
-	1	1	1707118-1 PIN, RETAIN, GROOVED	76
-	2	2	21045-3 RING, RETAIN, EXTERN, 3/16 CRESCENT	75
-	1	1	240638-1 SPRING, FEED FINGER	74
-	1	1	624871-1 FEED FINGER	73
-	1	1	2076077-1 TERMINAL DRAG, MID-EF	68
-	4	4	1-18023-2 SCR, SKT HD CAP M4 X 12.0	67
-	1	1	2076079-4 LEFT STRIP GUIDE, MID-EF	66
-	1	1	2076078-4 RIGHT STRIP GUIDE, MID-EF	65
-	1	1	2076075-1 STRIP GUIDE PLATE, MID-EF	64
-	1	1	2076076-1 DRAG SUPPORT, MID-EF	63
-	4	4	1-18023-7 SCR, SKT HD CAP M4 X 40.0	61
-	1	1	624534-2 LEVER, DRAG RELEASE	60
-	1	1	624535-2 BLOCK, DRAG SPACER	59
-	1	1	3-985575-4 SCR, FLT SKT HD CAP M6 X 25.0	58
-	4	4	2-22280-9 SPRING, COMPRESSION	57
-	4	4	624536-1 SPECIAL SCREW	56
-	2	2	1-18024-3 SCR, BTN SKT HD CAP (M5 X 16.0)	52
△	1	2	1 2076089-5 SPECIAL ANVIL-MID-SIZE	50
-	1	1	2-18023-3 SCR, SKT HD CAP M5 X 30.0	49
-	1	1	2-18023-2 SCR, SKT HD CAP M5 X 25.0	48
-	2	2	18025-3 WASHER, SPRG LOCK, REG M5	47
-	1	1	571239-8 HOLD DOWN SPACER	46
△	1	1	2076087-1 SHEAR PLATE, FRONT, MID-EF	45
-	2	2	3-624262-1 SPACER, SHEAR PLATE	44
△	1	1	2076086-2 SHEAR PLATE, REAR, MID-EF	43
-	1	1	2076095-3 SPACER, BASE BLOCK, MID-EF	41
-	2	2	1-18024-1 SCR, BTN SKT HD CAP (M5 X 10.0)	40
-	1	1	2076094-3 PLATE, STRIP HOLD DOWN, MID-EF	39
-	2	2	1-18023-3 SCR, SKT HD CAP M4 X 16.0	38
-	1	1	2077883-1 APPLICATOR BASIC ASSEMBLY, MID-EF	35
-	1	1	2076081-1 STRIPPER, MID-EF	34
-	2	2	1-18023-2 SCR, SKT HD CAP M4 X 12.0	33
-	1	1	2-18024-6 SCR, BTN SKT HD CAP (M8 X 25.0)	25
△	1	2	1 2076090-4 SPECIAL WIRE CRIMPER, MID-EF	21
-	1	1	2076082-3 HOLD DOWN, MID-EF	20
-	1	1	23846-2 SPRING, DIE	19
-	1	1	690480-1 SPRING SPACER AMP-O-MATOR	18
-	1	1	21028-2 PIN, SLOTTED SPRING .062 X .250	17
-	1	1	1707007-2 CAM	14
-	1	1	985575-3 SCR, FLT SKT HD CAP M3 X 10.0	13
-	1	1	2-18023-1 SCR, SKT HD CAP M5 X 20.0	12
-	1	1	18025-3 WASHER, SPRG LOCK, REG M5	11
-	2	2	2-18023-0 SCR, SKT HD CAP M5 X 16.0	10
-	2	2	18025-2 WASHER, SPRG LOCK, REG M4	9
△	1	1	2076084-3 BLADE, SLUG, MID-EF	8
-	1	1	2076083-6 SPACER, SLUG BLADE, MID-EF	7
-	1	1	18032-8 SCR, SET, FLT PNT, M6 X 8.0	6
-	1	1	690191-1 PLUG, NYLON	5
-	1	1	2076073-1 RAM, MID-EF	4
-	1	1	1-992946-4 PIN, DOWEL 3 X 8	3
-	1	1	1707150-2 WASHER, FLAT	2
-	1	1	1707670-1 WIRE DISC, FINE ADJUSTMENT	1

QTY	ITEM NO	PART NO	DESCRIPTION	ITEM NO
-	2	2	18025-3 WASHER, SPRG LOCK, REG M5	101
-77	-71	-1	PART NO DESCRIPTION	

THIS DRAWING IS A CONTROLLED DOCUMENT.

APPROVED: **C. LIMA** 16JAN2015

DATE: 16JAN2015

NAME: **MID SIZE WIRE APPLICATOR (END FEED)**

SIZE: A | CAGE CODE: 00779 | DRAWING NO: 2276091

SCALE: 2:5 | SHEET: 1 OF 1 | REV: C

STE TE Connectivity