

THIS COPY IS PROVIDED ON A RESTRICTED BASIS AND IS NOT TO BE USED IN ANY WAY DETRIMENTAL TO THE INTERESTS OF PANDUIT CORP.

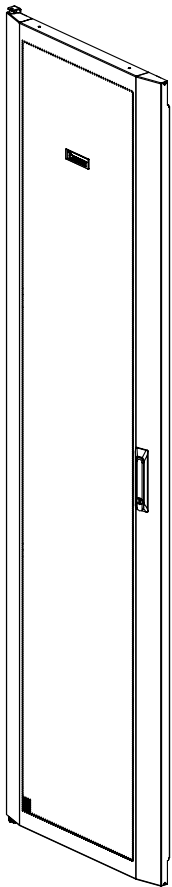

FRONT

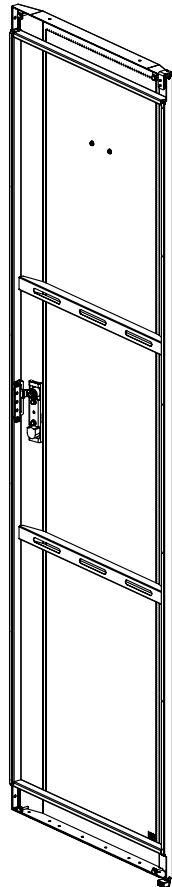

REAR

PANDUIT P/N	DESCRIPTION	WEIGHT
S62SHD*	S-TYPE 600mm X 42RU SINGLE HINGE DOOR	9.07 Kg/EACH [ 20.0 LBS/EACH ]
S65SHD*	S-TYPE 600mm X 45RU SINGLE HINGE DOOR	9.98 Kg/EACH [ 22.0 LBS/EACH ]
S68SHD*	S-TYPE 600mm X 48RU SINGLE HINGE DOOR	10.88 Kg/EACH [ 24.0 LBS/EACH ]
S72SHD*	S-TYPE 700mm X 42RU SINGLE HINGE DOOR	10.43 Kg/EACH [ 23.0 LBS/EACH ]
S75SHD*	S-TYPE 700mm X 45RU SINGLE HINGE DOOR	11.79 Kg/EACH [ 26.0 LBS/EACH ]
S78SHD*	S-TYPE 700mm X 48RU SINGLE HINGE DOOR	13.15 Kg/EACH [ 29.0 LBS/EACH ]
S82SHD*	S-TYPE 800mm X 42RU SINGLE HINGE DOOR	13.61 Kg/EACH [ 30.0 LBS/EACH ]
S85SHD*	S-TYPE 800mm X 45RU SINGLE HINGE DOOR	14.97 Kg/EACH [ 33.0 LBS/EACH ]
S88SHD*	S-TYPE 800mm X 48RU SINGLE HINGE DOOR	15.87 Kg/EACH [ 35.0 LBS/EACH ]

- VISIT OUR ON-LINE CATALOG AT [WWW.PANDUIT.COM](http://WWW.PANDUIT.COM) FOR A LIST OF CURRENT PARTS APPLICABLE FOR USE WITH THIS PRODUCT.
- PARTS SUPPLIED:  
 1- SINGLE HINGE DOOR ASSEMBLY  
 1- UPPER DOOR HINGE ASSEMBLY  
 1- LOWER DOOR HINGE BRACKET  
 1- LOWER DOOR HINGE PIN  
 1- DOOR CATCH  
 7- TORX SCREWS  
 1- INSTRUCTION SHEET
- PRIMARY DIMENSIONS ARE IN MILLIMETERS.
- \* DENOTES COLOR - ADD SUFFIX "B" FOR BLACK, "W" FOR WHITE, AND "G" FOR GRAY.

REV	DATE	BY	CHK	APR	DESCRIPTION	ECN	DRAWN BY	DATE	CHK	SCALE	SHT 1 OF 2	SIZE
00A	4-14-14	PBS	RCHA	TCN	RELEASED TO PRODUCTION	13V398ZX	PBS	4-14-14	RCHA	NONE		A

TITLE		S**SHD* (NET-ACCESS S-TYPE SINGLE HINGE DOOR)
ITEM REVISION NAME		CUSTOMER DRAWING
DATASET FILE NAME		13V398ZX_DC/00A
MATERIAL:		N/A
DRAWING NUMBER:		13V398ZX

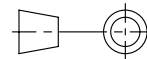

THIRD ANGLE PROJECTION

D10100DA/16

THIS COPY IS PROVIDED ON A RESTRICTED BASIS AND IS NOT TO BE USED IN ANY WAY DETRIMENTAL TO THE INTERESTS OF PANDUIT CORP.

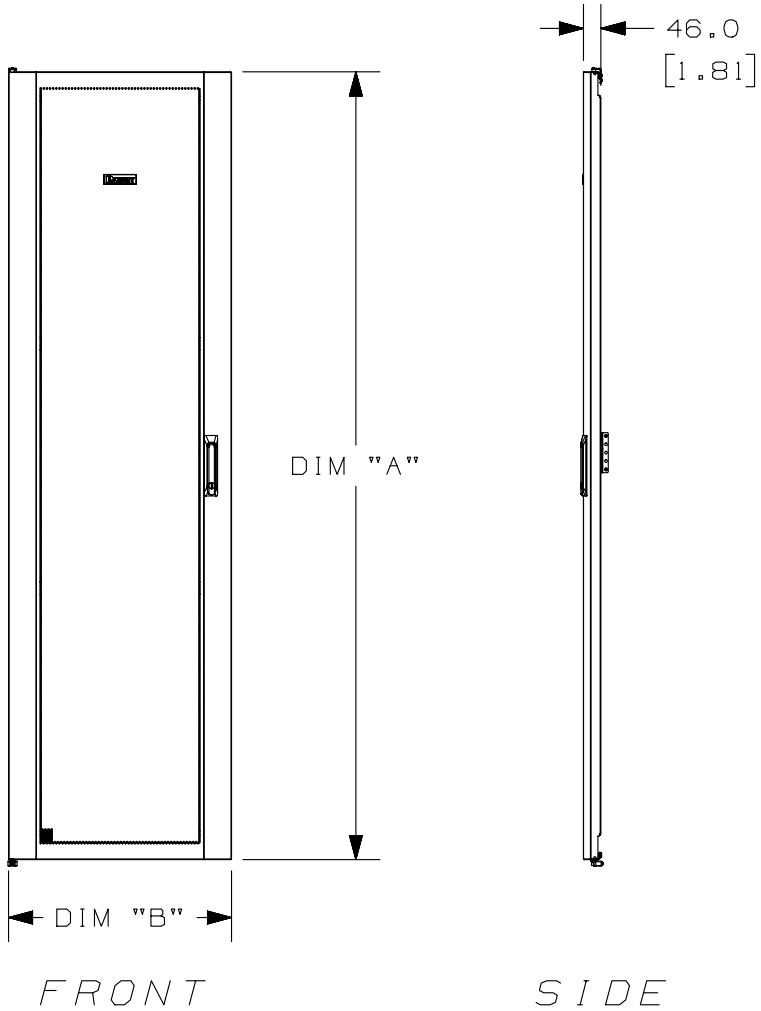

PANDUIT P/N	DESCRIPTION	"A"	"B"
S62SHD*	S-TYPE 600mm X 42RU SINGLE HINGE DOOR	1951.0 [ 76.01 ]	590.0 [ 23.23 ]
S65SHD*	S-TYPE 600mm X 45RU SINGLE HINGE DOOR	2084.4 [ 82.06 ]	590.0 [ 23.23 ]
S68SHD*	S-TYPE 600mm X 48RU SINGLE HINGE DOOR	2217.7 [ 87.31 ]	590.0 [ 23.23 ]
S72SHD*	S-TYPE 700mm X 42RU SINGLE HINGE DOOR	1951.0 [ 76.01 ]	690.0 [ 27.17 ]
S75SHD*	S-TYPE 700mm X 45RU SINGLE HINGE DOOR	2084.4 [ 82.06 ]	690.0 [ 27.17 ]
S78SHD*	S-TYPE 700mm X 48RU SINGLE HINGE DOOR	2217.7 [ 87.31 ]	690.0 [ 27.17 ]
S82SHD*	S-TYPE 800mm X 42RU SINGLE HINGE DOOR	1951.0 [ 76.01 ]	790.0 [ 31.10 ]
S85SHD*	S-TYPE 800mm X 45RU SINGLE HINGE DOOR	2084.4 [ 82.06 ]	790.0 [ 31.10 ]
S88SHD*	S-TYPE 800mm X 48RU SINGLE HINGE DOOR	2217.7 [ 87.31 ]	790.0 [ 31.10 ]

\* DENOTES COLOR  
 "B" = BLACK, "W" = WHITE, "G" = GRAY

REV	DATE	BY	CHK	APR	DESCRIPTION	ECN
00A	4-14-14	PBS	RCHA	TCN	SEE SHEET 1 OF 2 FOR REVISIONS	13V398ZX

TITLE		S**SHD* (NET-ACCESS S-TYPE SINGLE HINGE DOOR)	
CUSTOMER DRAWING			
ITEM REVISION NAME	13V398ZX/00	<b>PANDUIT</b>	
DATASET FILE NAME	13V398ZX_DC/00A		
MATERIAL:		N/A	
DRAWING NUMBER:		13V398ZX	
DRAWN BY	DATE	CHK	SCALE
PBS	4-14-14	RCHA	NONE
SHT 2 OF 2		A	

D10100DA/16