

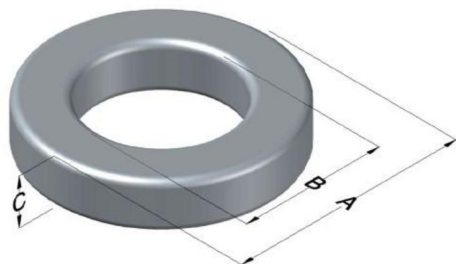

0076051A7

110 Delta Drive
 Pittsburgh, PA 15238
 NAFTA Sales: (1)800-245-3984
 HK Sales : (852)3102-9337
 magnetics@spang.com
 www.mag-inc.com



Kool M μ Hf Permeability (μ)	A _L (nH/T ²)	Core Marking			Coating Color
		Lot Number	Part Number	Inductance Grade	
60	27 \pm 8%	XXXXXX	051A7	N/A	Black

Dimensions					Packaging	
Uncoated			Coated Limits			
	(mm)	(in)	(mm)	(in)		
OD (A)	12.70	0.500	13.46	0.530	max	Bulk Pack 4 bags/box Box Qty = 5000 Pcs
ID (B)	7.62	0.300	6.99	0.275	min	
HT (C)	4.75	0.187	5.51	0.217	max	

Electrical Characteristics			Physical Characteristics						
Watt Loss @ 100kHz, 100mT (max, mW/cm ³)	DC Bias min (Oersteds)		Voltage Breakdown wire-to-wire min (V _{AC})	Break Strength (min, kg)	Window Area, W _A (mm ²)	Cross Section, A _e (mm ²)	Path Length, L _e (mm)	Volume V _e (mm ³)	Weight (g)
	80%	50%							
450	45.0	100	1250	14.9	38.3	10.9	31.2	340	2.2

Winding Information					Temperature Rating	
Winding Length per Turn				Wound Coil Dimensions (mm)		
Winding Factor	(mm)	Winding Factor	(mm)	40% Winding Factor	OD	14.6
					0%	17.5
20%	19.3	45%	21.7	Completely Full Window	Max OD	18.2
25%	19.8	50%	22.1		Max HT	11.5
30%	20.1	60%	23.2	Surface Area (mm ²)		
35%	20.7	70%	24.5	Unwound Core:	560	
				40% Wound:	800	

Temperature Rating	
Curie Temp (°C):	500 °C
Coating Temp: (Continuous, up to; °C)	200 °C
Notes:	

