

DO NOT SCALE FROM THIS PRINT

**DESIGNED & DIMENSIONED IN MILLIMETERS [INCHES]**

**SERIES**  
 GRF1-: GRF 50 OHM CONNECTORS (SEE NOTE 7)  
 GRF7-: GRF 75 OHM CONNECTORS (SEE SHT2, TABLE 1)

\* = NOT RELEASED FOR PRODUCTION

**GRFX-J-P-XX-XX-RA-XXX-X**

**INSERT OPTIONS**  
 -E: #1-64 THRU HOLE  
 THREADED INSERT (SEE FIG 2, SHT 2)

**TERMINATION**  
 -TH1: THRU HOLE  
 \* -SM1: SURFACE MOUNT  
 \* -MT1: MIXED TECHNOLOGY (SEE SHT 2, TABLE 3)

**ORIENTATION**  
 -RA: RIGHT ANGLE

**GENDER**  
 -J: JACK

**PCB**  
 -P: PCB MOUNT

**No OF POSITIONS**  
 -02, -04, -06, -08

**PLATING**  
 -E: 30μ" GOLD CENTER CONTACT, 3μ" GOLD OUTER CONTACT (GRF1 ONLY)  
 -HF: 30μ" GOLD CENTER CONTACT, 3μ" GOLD OUTER CONTACT (GRF7 ONLY)  
 -GF: 10μ" GOLD CENTER CONTACT, 3μ" GOLD OUTER CONTACT (SEE SHT 2, TABLE 2)

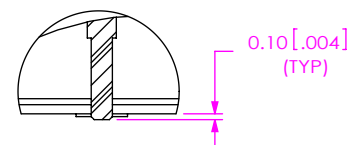
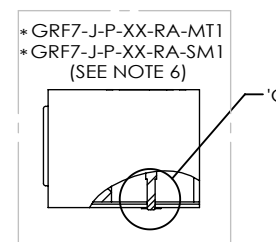
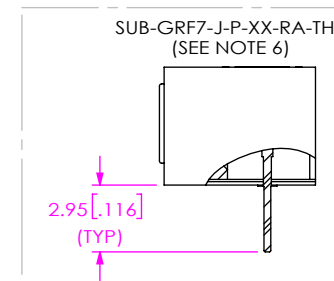
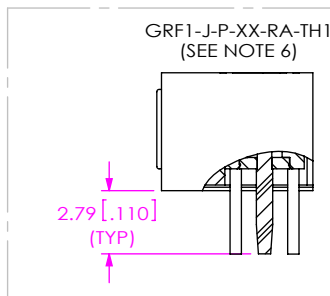
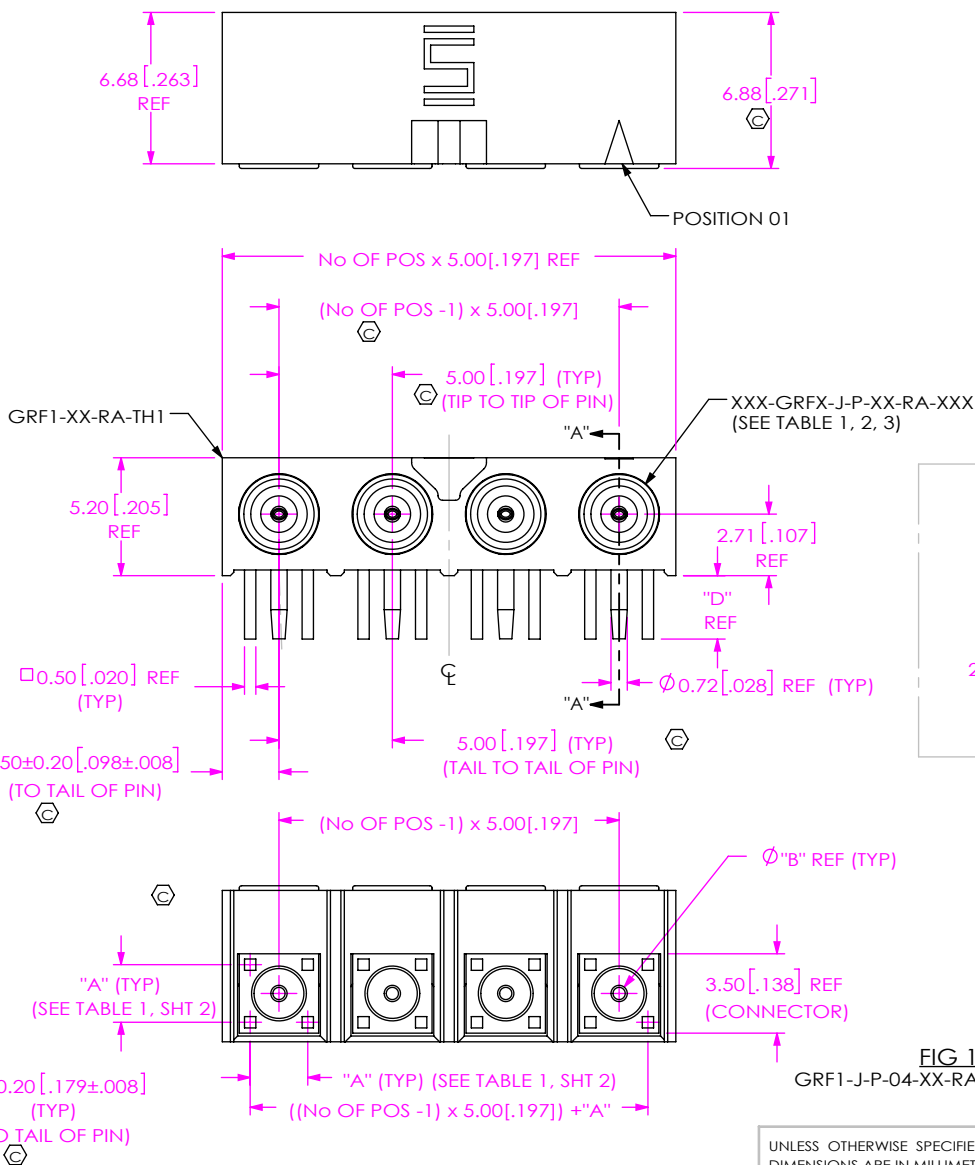
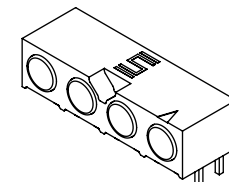

**DETAIL 'C'**  
 SCALE 8:1

**FIG 1**  
 GRF1-J-P-04-XX-RA-TH1 SHOWN

F:\dwg\sw\axisprod\assembly\rf\grf\grf1-j-p-xx-x-ra-th1-x\GRFX-J-P-XX-XX-RA-XXX-X-ASM.SLDDRW

**SECTION "A"- "A"**

**NOTES:**

1. REPRESENTS A CRITICAL DIMENSION.
2. MINIMUM PUSHOUT FORCE: 2.22N [.5 LB].
3. NOTE DELETED.
4. ALL PIN TO PIN DIMENSIONS TO BE MEASURED FROM TIP TO TIP.
5. PART TO BE SYMMETRIC ABOUT CENTERLINE WITHIN 0.25 [.010].
6. SOME FEATURES NOT SHOWN FOR CLARITY.
7. PLATING CODE "-E" IS FOR GRF1 ONLY, EXISTING DESIGNATION, PLATING CODE "-HF" IS FOR GRF7 ONLY.

UNLESS OTHERWISE SPECIFIED, DIMENSIONS ARE IN MILLIMETERS. TOLERANCES ARE:  
 DECIMALS ANGLES  
 X.X: ±0.3 [.01] 5°  
 X.XX: ±0.13 [.005]  
 X.XXX: ±0.050 [.0020]

**PROPRIETARY NOTE**  
 THIS DOCUMENT CONTAINS CONFIDENTIAL AND PROPRIETARY INFORMATION AND ALL DESIGN, MANUFACTURING, REPRODUCTION, USE, PATENT RIGHTS AND SALES RIGHTS ARE EXPRESSLY RESERVED BY SAMTEC, INC. THIS DOCUMENT SHALL NOT BE DISCLOSED, IN WHOLE OR PART, TO ANY UNAUTHORIZED PERSON OR ENTITY NOR REPRODUCED, TRANSFERRED OR INCORPORATED IN ANY OTHER PROJECT IN ANY MANNER WITHOUT THE EXPRESS WRITTEN CONSENT OF SAMTEC, INC.

**MATERIAL:**  
 BODY  
 INSULATOR: L.C.P. COLOR: BLACK  
 CONNECTORS  
 SHELL: BRASS  
 SOCKET: BeCu  
 INSULATOR: PTFE

DO NOT SCALE DRAWING SHEET SCALE: 3:1

**DESCRIPTION:**  
 GANGED RF RA JACK CONNECTOR

**DWG. NO.**  
 GRFX-J-P-XX-XX-RA-XXX-X

**BY:** DEAN P 01/17/2006 SHEET 1 OF 3



520 PARK EAST BLVD, NEW ALBANY, IN 47150  
 PHONE: 812-944-6733 FAX: 812-948-5047  
 e-Mail info@SAMTEC.com code 55322

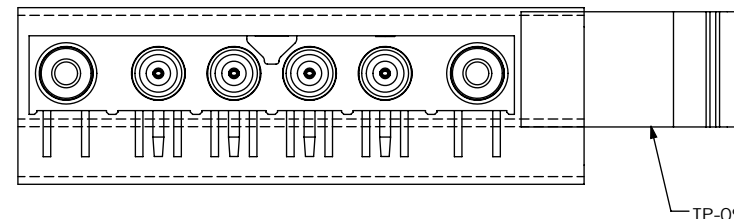
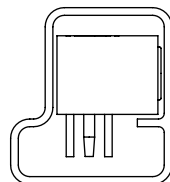
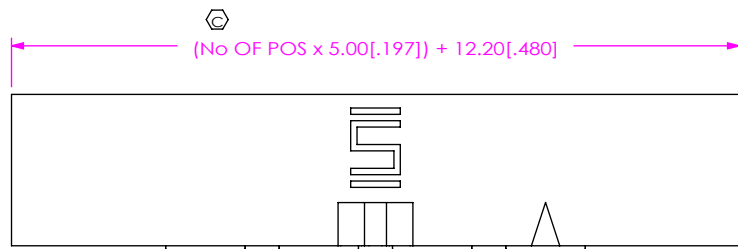

PACKAGING VIEW  
TUBE: PT-1-24-01-45  
PLUG: TP-09

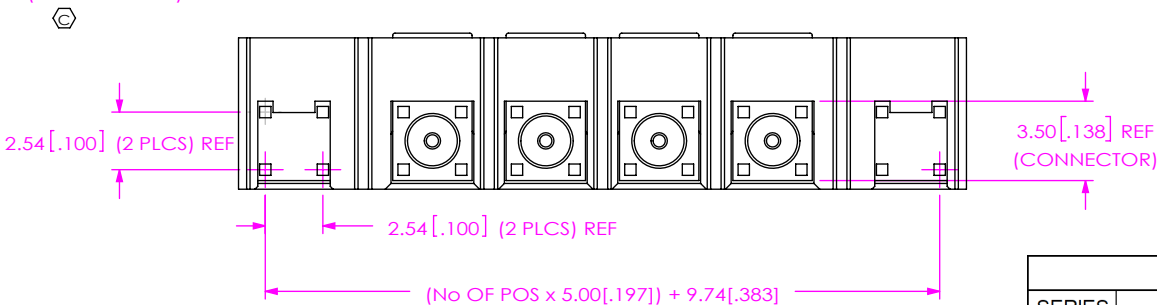
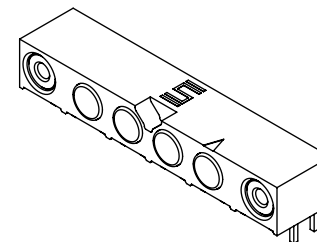
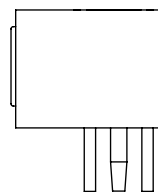
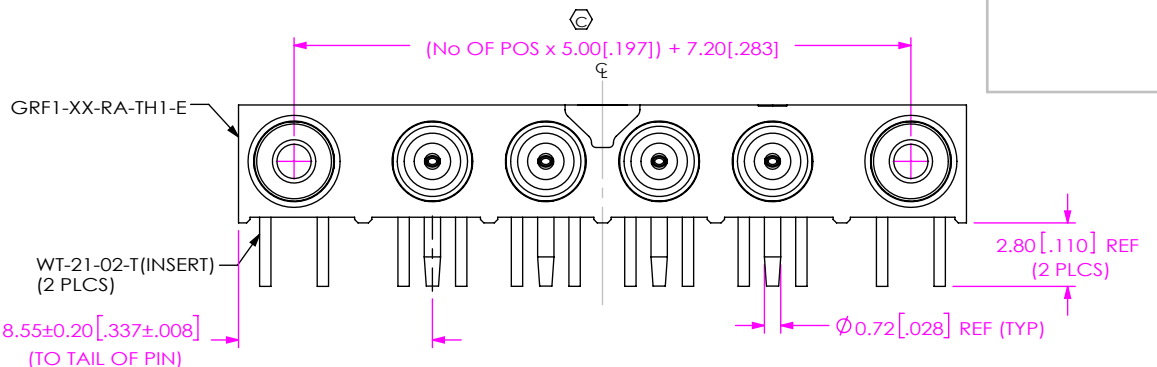

FIG 2  
GRF1-J-P-04-XX-RA-TH1-E SHOWN  
(SAME AS FIG 1, EXCEPT AS SHOWN)

TABLE 1					
SERIES	"A"	"B"	"C"	"D"	XXX-GRFX-J-P-XX-RA-XXX
GRF1-	2.54 [0.100]	0.70 [0.028]	0.70 [0.028]	2.80 [0.110]	SUB-GRF1-J-P-XX-RA-TH1
GRF7-	3.00 [0.118]	0.30 [0.012]	0.50 [0.020]	3.00 [0.118]	SUB-GRF7-J-P-XX-RA-TH1
		0.35 [0.014]		0.00 [0.000]	* GRF7-J-P-XX-RA-SM1
		0.35 [0.014]	3.00 [0.118]	* GRF7-J-P-XX-RA-MT1	

TABLE 2 (PLATING)			
SERIES	-E	-HF	-GF
GRF1-	SUB-GRF1-J-P-HF-RA-TH1	N/A	SUB-GRF1-J-P-GF-RA-TH1
GRF7-	N/A	SUB-GRF7-J-P-HF-RA-TH1	SUB-GRF7-J-P-GF-RA-TH1
		* GRF7-J-P-HF-RA-SM1	* GRF7-J-P-GF-RA-SM1
		* GRF7-J-P-HF-RA-MT1	* GRF7-J-P-GF-RA-MT1

TABLE 3 (TERMINATION)			
SERIES	-TH1	-SM1	-MT1
GRF1-	SUB-GRF1-J-P-XX-RA-TH1	* N/A	N/A
GRF7-	SUB-GRF7-J-P-XX-RA-TH1	GRF7-J-P-XX-RA-SM1	GRF7-J-P-XX-RA-MT1

**PROPRIETARY NOTE**  
THIS DOCUMENT CONTAINS CONFIDENTIAL AND PROPRIETARY INFORMATION AND ALL DESIGN, MANUFACTURING, REPRODUCTION, USE, PATENT RIGHTS AND SALES RIGHTS ARE EXPRESSLY RESERVED BY SAMTEC, INC. THIS DOCUMENT SHALL NOT BE DISCLOSED, IN WHOLE OR PART, TO ANY UNAUTHORIZED PERSON OR ENTITY NOR REPRODUCED, TRANSFERRED OR INCORPORATED IN ANY OTHER PROJECT IN ANY MANNER WITHOUT THE EXPRESS WRITTEN CONSENT OF SAMTEC, INC.

DO NOT SCALE DRAWING

SHEET SCALE: 3:1



520 PARK EAST BLVD. NEW ALBANY, IN 47150  
PHONE: 812-944-6733 FAX: 812-948-5047  
e-Mail info@SAMTEC.com code 55322

DESCRIPTION: GANGED RF RA JACK CONNECTOR

DWG. NO. GRFX-J-P-XX-XX-RA-XXX-X

BY: DEAN P 01/17/2006 SHEET 2 OF 3

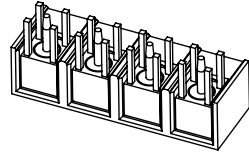

GRF1-J-P-04-XX-RA-TH1 SHOWN

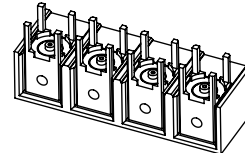

\* GRF7-J-P-04-XX-RA-MT1 SHOWN

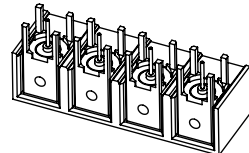

GRF7-J-P-04-XX-RA-TH1 SHOWN

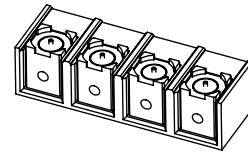

\* GRF7-J-P-04-XX-RA-SM1 SHOWN

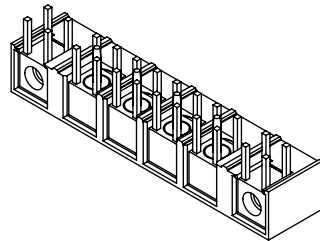

GRF1-J-P-04-XX-RA-TH1-E SHOWN

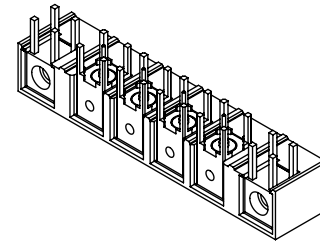

GRF7-J-P-04-XX-RA-TH1-E SHOWN

\* **PROPRIETARY NOTE** \*

THIS DOCUMENT CONTAINS CONFIDENTIAL AND PROPRIETARY INFORMATION AND ALL DESIGN, MANUFACTURING, REPRODUCTION, USE, PATENT RIGHTS AND SALES RIGHTS ARE EXPRESSLY RESERVED BY SAMTEC, INC. THIS DOCUMENT SHALL NOT BE DISCLOSED, IN WHOLE OR PART, TO ANY UNAUTHORIZED PERSON OR ENTITY NOR REPRODUCED, TRANSFERRED OR INCORPORATED IN ANY OTHER PROJECT IN ANY MANNER WITHOUT THE EXPRESS WRITTEN CONSENT OF SAMTEC, INC.

DO NOT SCALE DRAWING

SHEET SCALE: 3:1



520 PARK EAST BLVD, NEW ALBANY, IN 47150  
 PHONE: 812-944-6733 FAX: 812-948-5047  
 e-Mail info@SAMTEC.com code 55322

DESCRIPTION: GANGED RF RA JACK CONNECTOR

DWG. NO. GRFX-J-P-XX-XX-RA-XXX-X

BY: DEAN P 01/17/2006 SHEET 3 OF 3