



Customer Product/Process Change Notification

PCN # OES17020101_593

Issued Date: 1/27/2017

Issued By: Nick Oesterheld

Author: Nick Oesterheld

REVISION 01 : 3/6/2017

Change affects whole product family? YES

Part #'s affected (See attached if entire product family is affected)

P/N 593xxxxx0xxF will be discontinued and replaced by 593xxxxx3xxF. See attached Affected P/N List.

Description of Change:

The Replacement P/N 593xxxxx3xxF is with a injection moldable Clear Silicone Lens with textured surface seated in two housing halves snapped together with one seating plane and improved LED coplanarity. The discontinued P/N 593xxxxx0xxF was with a hard transfer molded Hysol multiple lenses with a varied LED seating plane.

Reason for Change:

The silicone lens injection molds better with better mold yields and one lens reducing part count. The prior hard lens Transfer Molding Machine with long cycle an low yields will be Obsoleted. The new housing halves provide one seating plane for all three LEDs for better coplanarity.

Properties of Old vs. Changed Product:

Part Pad layout dimensions and seating plane remains the same for replacement parts.

Disposition of Old Product:

Use until depleted.

Expected Implementation Date:

Last Time Order Date:

Customer Feedback Expected by:

Additional Comments: (Include Potential Risks if Appropriate)

None

Supporting Qualification Data:

Not Applicable

Approved By:

(Minimum of three approvals are required.)

Vice President of Operations: _____

Vice President of Sales OED/Signals: Matt Boudiette

Director of Customer Service: Kathy Smith

Vice President of Marketing: _____

Director of Quality: Angel Escamilla

AFFECTED PART NUMBERS

DISCONTINUE REPLACEMENT PART NUMBERS

593101010002 593101010302F AND 593101010313F
593131313002 593131313302F AND 593131313313F
593141414002 593141414302F AND 593141414313F
593151515002 593151515302F AND 593151515313F
593202020002 593202020302F AND 593202020313F
593202024002 593202024302F AND 593202024313F
593202324002 593202324302F AND 593202324313F
593202326002 593202326302F AND 593202326313F
593203120002 593203120302F AND 593203120313F
593212121002 593212121302F AND 593212121313F
593212130002 593212130302F AND 593212130313F
593212226002 593212226302F AND 593212226313F
593212729002 593212729302F AND 593212729313F
593222222002 593222222302F AND 593222222313F
593222221002 593222221302F AND 593222221313F
593222721002 593222721302F AND 593222721313F
593232323002 593232323302F AND 593232323313F
593232420002 593232420302F AND 593232420313F
593232424002 593232424302F AND 593232424313F
593232627002 593232627302F AND 593232627313F
593242320002 593242320302F AND 593242320313F
593242424002 593242424302F AND 593242424313F
593262626002 593262626302F AND 593262626313F
593272129002 593272129302F AND 593272129313F
593272323002 593272323302F AND 593272323313F
593272727002 593272727302F AND 593272727313F
593282828002 593282828302F AND 593282828313F
593292627002 593292627302F AND 593292627313F
593292721002 593292721302F AND 593292721313F
593292927002 593292727302F AND 593292727313F
593292929002 593292929302F AND 593292929313F
593303030002 593303030302F AND 593303030313F
593312020002 593312020302F AND 593312020313F
593313131002 593313131302F AND 593313131313F
593323232002 593323232302F AND 593323232313F
593353535002 593353535302F AND 593353535313F

DISCONTINUED PART

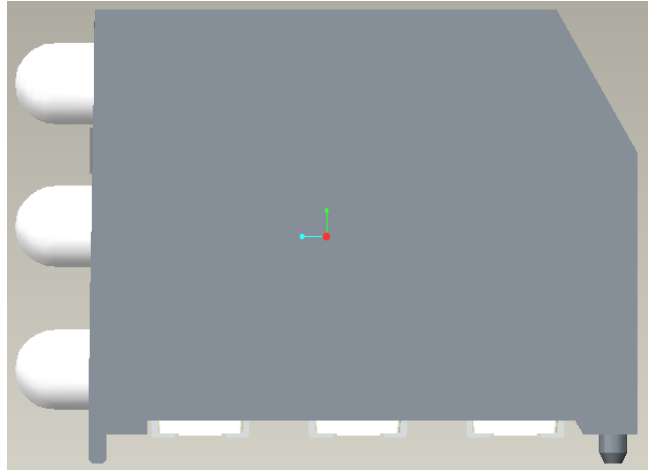

REPLACEMENT PART

