

NOTES:

1. TOTAL TRAVEL: .042±.010.
2. ACTUATING FORCE: 4 ±2 OZ.
3. TOLERANCE INCLUDES APPROX. .020 END PLAY (*).
4. RATED TO MAKE AND BREAK 1/4 AMP., .115 V.A.C. RESISTIVE FOR 250,000 OPERATIONS.
5. MATERIALS AND FINISHES:
 - BUSHING AND MOUNTING NUT ARE BRASS, TIN/ZINC PLATED
 - BUTTON TOP AND BOTTOM, BASE AND INSULATING SLEEVE ARE MOLDED PHENOLIC PER MIL-M-14, TYPE CFG.
 - SHORTING WASHER AND TERMINALS ARE FINE SILVER.
 - SPRING IS TINNED MUSIC WIRE.

ASSEMBLY NOTES:

1. ASSEMBLE SWITCH AND LOCK BASE ASSEMBLY TO BUSHING.
2. LOCATE LABEL APPROX. AS SHOWN. LABEL TO CONTAIN E.I.A. DATE CODE.

REFERENCE NOTES:

GRAYHILL STANDARD 39-4.

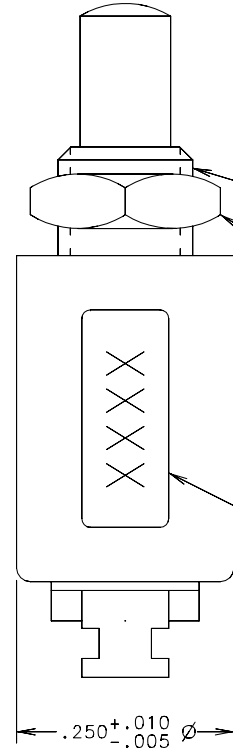
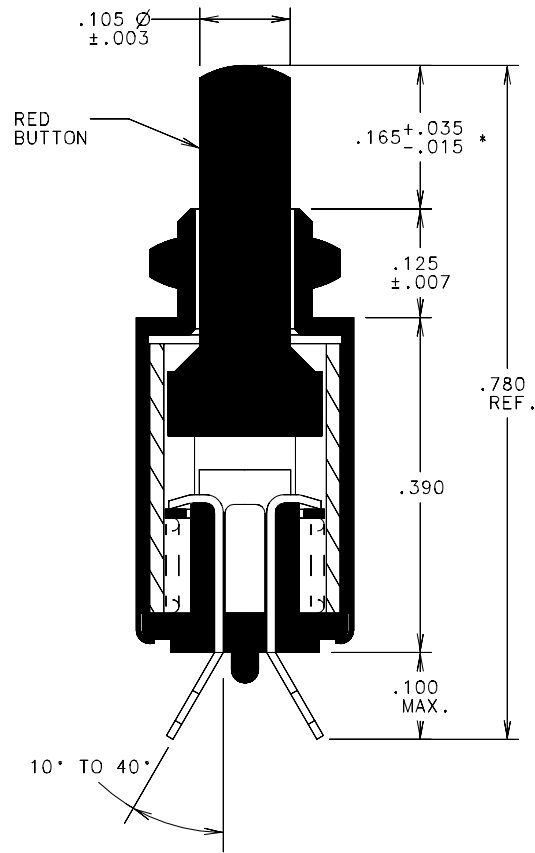

ALL REVISIONS TO THIS DRAWING MUST BE MADE ON THE CAD SYSTEM

#8-40 UNS-2A TH'D FULL THREADS TO WITHIN .040 MAX. FROM SHOULDER

HEX. MTG. NUT 1/16 THICK 7/32 ACROSS FLATS

LABEL, SEE ASSEMBLY NOTES

ENG210C

REVISIONS

ISSUE	DESCRIPTION	APPD/DATE
A	ORIGINAL ECN#346086 CWS 3-14-03	PR/CWS 3-14-03
B	MODIFIED NOTES: TIN/ZINC WAS CADMIUM ECN #371814 ANJ 6-30-08	GAD 7-02-08

CIRCUIT DIAGRAM

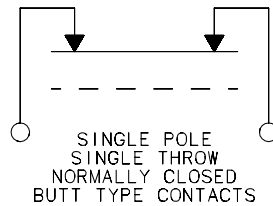

UNLESS OTHERWISE SPECIFIED TOLERANCES AND DIMENSIONS ARE IN INCHES
 LINEAR ±.010 DIAMETERS ±.005
 ANGULAR ± 1°
 LIMITS APPLY BEFORE FINISHING
 DO NOT SCALE THIS PRINT

CRITICAL CHARACTERISTIC FLAGS PER GRAYHILL SPEC.SOP2338

- △ -- CRITICAL CHARACTERISTIC FLAG
- -- Cpk REQUIRED
- ☒ -- S.P.C. FLAG (CONTROL CHART REQ'D ON FEATURE SPECIFIED)

APPROVED DATE
CWS 3-14-03

CHECKED DATE
PR 3-14-03

DRAWN DATE
CWS 3-14-03

FINISH
NOTED

MATERIAL
NOTED



GRAYHILL, INC.
561 HILLGROVE AVE. PHONE (708)
LA GRANGE, IL 60525 354-1040

PUSHBUTTON SWITCH

B DWG. NO. 39YY2004 ISSUE B
SIZE

CADAM DRAWING 39YY2004_B_001

SCALE 7:1

UNIT WEIGHT

SHEET 1 OF 1