

1 0 1 0 2  
3 0 0 4  
a-L-b (+)

SPST  
CONTACT CONFIGURATION

| PARTS LIST |      |          |                                  |
|------------|------|----------|----------------------------------|
| ITEM       | QTY. | PART NO. | PART DESCRIPTION                 |
| 1          | 1    | F040008  | D16 OA S1 1                      |
| 2          | 1    | F050422  | 50-004-22 (GRN L.E.D.)           |
| 3          | 1    | F050305  | 50-003-05 (Transparent WHT lens) |

NOTES:

1. ALL DIMENSIONS IN MM
2. GENERAL TOLERANCE: X.X=±0.4  
X.XX=±0.25
3. RATINGS: 5A @250V AC  
8A @125V AC
4. TRAVEL: 3.0mm
5. CONTACT MATERIAL:  
COPPER ALLOY W/Silver Plating
6. LAMP VOLTAGE: 24V DC L.E.D.

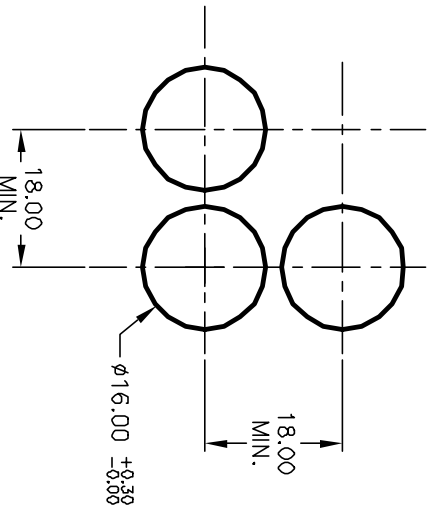

RECOMMENDED PANEL MOUNTING  
SCALE 1:1

| REV. | ECN No. | DESCRIPTION            | DATE    | CHKD |
|------|---------|------------------------|---------|------|
| A    | 12199   | RELEASE FOR PRODUCTION | 5/30/02 | CJB  |

| TITLE  | SCALE | DATE    | DR | DWG     | REV |
|--|-------|---------|----|---------|-----|
| D16 DA S11 K GRN WHT<br>TRANSPARENT/CONCAVE LENS | 1.5:1 | 5/30/02 | CB | XF0475P | A   |

**E-SWITCH®**

THE INFORMATION CONTAINED IN THIS DOCUMENT IS PROPRIETARY TO E-SWITCH AND IS NOT TO BE COPIED OR TRANSFERRED