

**Recommended P.C. Board Layout**  
SCALE 8:1

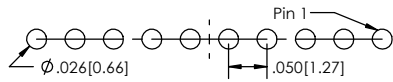

**SINGLE ROW**

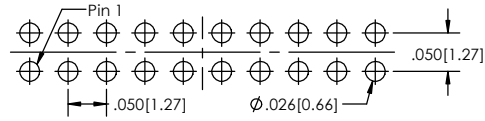

**DOUBLE ROW**

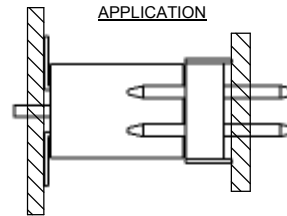
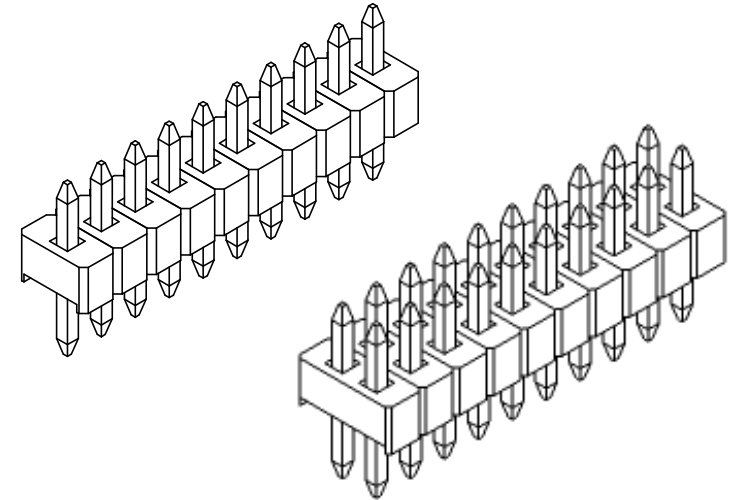

TSHS-5 **XX** - **X** - **XX** - **X** - **XX** - **XXX** - **LF**  
(A) (B) (C) (D) (E) (F) (G)

- A. Pins Per Row  
- 1 through 40
- B. Row Specification  
- S= Single Row  
- D= Double Row
- C. Pin Options  
- See Pin Option box below
- D. Desired Post Height  
- A= .0.75[1.91]  
- B= .120[3.05]
- E. Plating Options  
- See Plating Options below
- F. Polarized Position  
- Leave blank if not required  
- e.g. .200[5.08] =200
- G. Lead Free

Mates with:  
LSHSS  
SMSS  
SSHSS

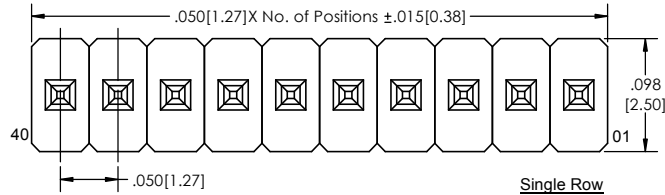
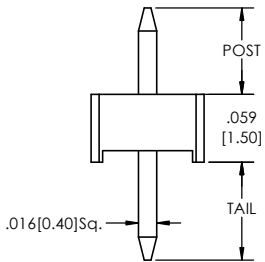

**Single Row**

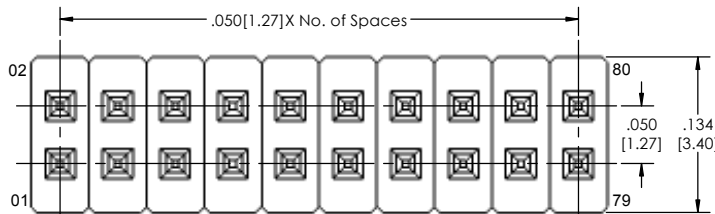

**Double Row**

| Plating options |  |
|-----------------|--|
| G               | -10µ Gold on Contact Area/ Flash on Tail       |
| T               | -Matte Tin all Over                            |
| GT              | -10µ Gold on Contact Area/ Matte Tin on Tail   |
| H               | -30µ Gold on Contact Area/ Matte Tin on Tail   |
| F               | -Gold Flash over Entire Pin                    |
| FT              | -Gold Flash on Contact Area/ Matte Tin on Tail |

| Pin Options         |                     |                  |
|---------------------|---------------------|------------------|
| Tail with .120 Post | Tail with .075 Post | Length           |
| N/A                 | .084[2.13mm]        | .219[5.56mm] 04  |
| .148[3.76mm]        | .193[4.90mm]        | .328[8.32mm] 06  |
| .250[6.35mm]        | .295[7.49mm]        | .430[10.92mm] 08 |
| .300[7.62mm]        | .345[8.76mm]        | .480[12.19mm] 10 |
| .350[8.89mm]        | .395[10.03mm]       | .530[13.46mm] 12 |
| .400[10.16mm]       | .445[11.30mm]       | .580[14.73mm] 14 |
| .450[11.43mm]       | .495[12.57mm]       | .630[16.00mm] 16 |
| .500[12.70mm]       | .545[13.84mm]       | .680[17.27mm] 18 |
| .550[13.97mm]       | .595[15.11mm]       | .730[18.54mm] 20 |
| .600[15.24mm]       | .645[16.38mm]       | .780[19.81mm] 22 |
| .650[16.51mm]       | .695[17.65mm]       | .830[21.08mm] 24 |

**Specifications:**  
Current Rating: 1.0 Ampere  
Insulation Resistance: 1000M Ohms Min.  
Dielectric Withstanding: 300V AC  
Contact Resistance: 20M Ohms Max.  
Operation Temperature: -40°C to +105°C  
Max. Process Temperature  
Peak: 260°C up to 10 secs.  
Process: 230°C up to 60 secs.  
Wave: 260°C up to 6 secs.  
Manual Solder: 350°C up to 5 secs.

**Materials:**  
Contact Material: Phosphor Bronze  
Insulator Material: Nylon 6T  
Plating: Au or Sn over 50µ" (1.27) Ni

Tails may be clipped to achieve specific dimensions.  
Products cut to specific sizes are uncancellable/nonreturnable.  
Parts are subject to change without notice.



**PROPRIETARY AND CONFIDENTIAL**  
THE INFORMATION CONTAINED IN THIS DRAWING IS THE SOLE PROPERTY OF Major League Electronics. ANY REPRODUCTION IN PART OR AS A WHOLE WITHOUT THE WRITTEN PERMISSION OF Major League Electronics IS PROHIBITED.

|                             |  |                               |  |                          |  |
|-----------------------------|--|-------------------------------|--|--------------------------|--|
| UNLESS OTHERWISE SPECIFIED: |  | NAME                          |  | DATE                     |  |
| DIMENSIONS ARE IN INCHES    |  | DRAWN                         |  | EOW                      |  |
| TOLERANCES:                 |  | CHECKED                       |  | GWE                      |  |
| ONE DECIMALS ±.100          |  | ENG APPR.                     |  |                          |  |
| TWO DECIMAL ±.100           |  | MFG APPR.                     |  |                          |  |
| THREE DECIMAL ±.005         |  | ADDRESS:                      |  | 2533 Centennial Blvd.    |  |
| FOUR DECIMAL ±.002          |  | MATERIAL:                     |  | Jeffersonville, IN 47130 |  |
| NEXT ASSY                   |  | FINISH:                       |  | Phone: 812-670-4174      |  |
| USED ON:                    |  | APPLICATION:                  |  | Fax: 812-670-4175        |  |
| DO NOT SCALE DRAWING        |  | E-Mail: mle@mlelectronics.com |  | TITLE: TSHS-5 SERIES     |  |
|                             |  | SCALE 12:1                    |  | SIZE DWG. NO. C          |  |
|                             |  |                               |  | REV B                    |  |
|                             |  |                               |  | SHEET 1 OF 1             |  |

