

PART NUMBER	REV	FIRST USED
680537-1	A	122500-1
680537-2	A	565435-5
680537-3	A	354500-1

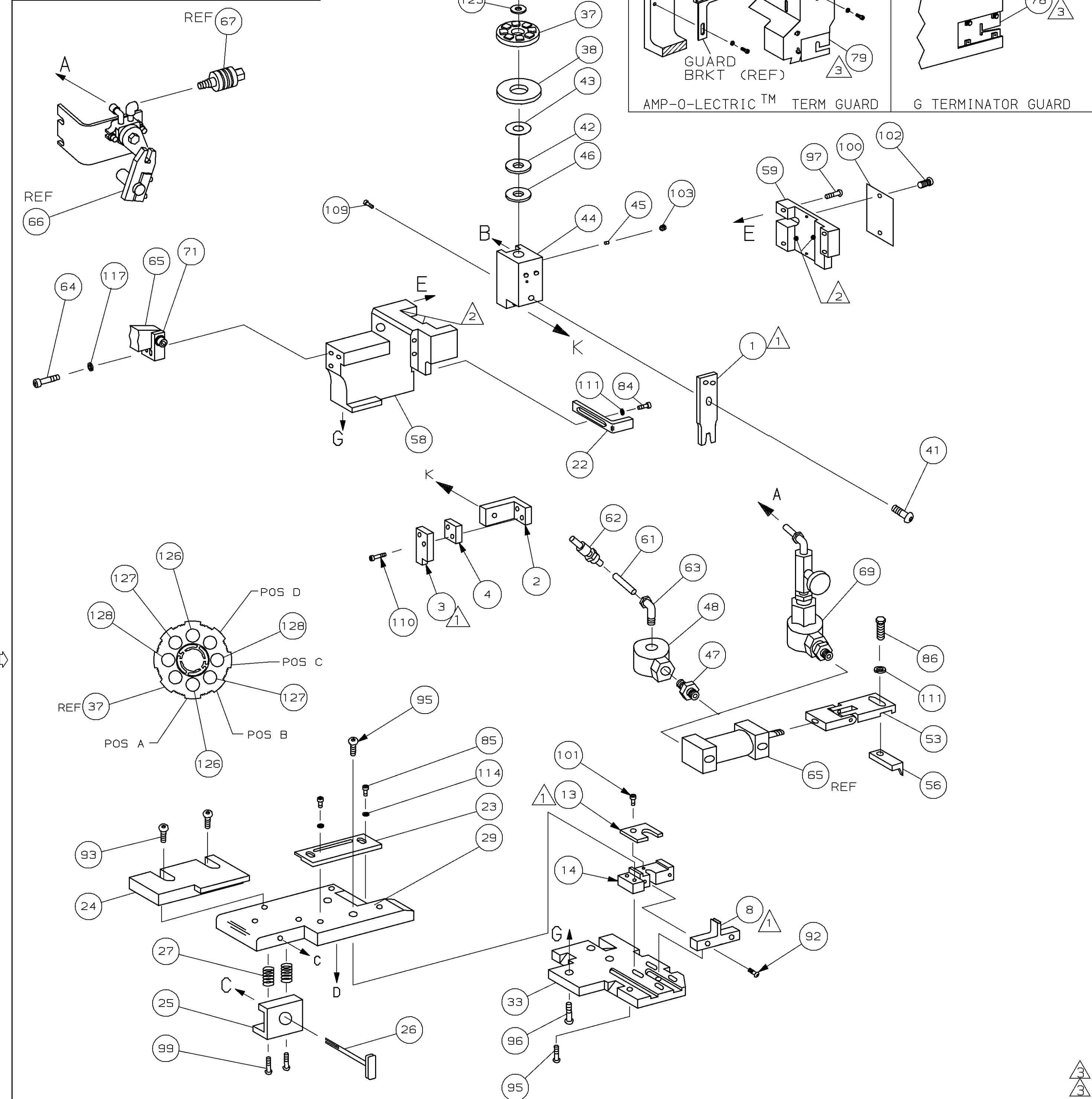

- 1 RECOMMENDED SPARE PARTS.
- 2 GREASE LIGHTLY.
- 3 GUARD MUST BE IN PLACE WHEN OPERATING APPLICATOR IN A BENCH MACHINE.
- 4 SEE DRAWING FOR COMPONENTS

TERMINAL NAME: MAG-MATE™ TERMINAL		CRIMPING DATA	
PAD LTR	CRIMP HEIGHT	WIRE SIZE	
A	.050 ±.002 [1.27 ±0.05mm]	18	
B	.045 ±.002 [1.14 ±0.05mm]	20	
C	.042 ±.002 [1.07 ±0.05mm]	22	
D	NOT USED	USED	
CRIMP WIRE	SIZE	TYPE	RANGE
	.070 [1.78mm]	F	22-18
INSUL	-	-	-

QTY	REQD	PER	ASSY	U/M	DWG SIZE	PART NO	DESCRIPTION	ITEM NO
2	2	2	-	C		4-354779-1	PIN, WIRE DISC (.3195)C	129
2	2	2	-	C		3-354779-5	PIN, WIRE DISC (.3165)B	127
2	2	2	-	C		2-354779-5	PIN, WIRE DISC (.3115)A	126
1	1	1	-	A		986950-1	WASHER, FLAT PRECISION	125
1	1	1	-	A		217238-1	GENERAL INSTRUCTION PACKAGE	124
1	1	1	-	-		4088040	SF APPL INST 408-8040	123
2	2	2	-	A		21024-5	WASHER, LOCK (#10)FEED	117
2	2	2	-	A		21024-4	WASHER, LOCK (#8)FRONT STP GUIDE	114
2	2	2	-	A		21024-4	WASHER, LOCK (#8) STRIPPER	111
1	1	1	-	A		2-21000-2	SCR, SHC (6-32x.75) REAR SHEAR PL	110
2	2	2	-	A		2-21000-1	SCR, SHC (6-32x.62) DEPRESSOR	109
1	1	1	-	A		992031-1	PIN, CLEVIS	104
1	1	1	-	A		21009-2	SCR, SKT SET (1/4-20x.25 LW) RAM	103
2	2	2	-	A		21017-2	SCR, DRIVE (#2x.19) ID PLATE	102
1	1	1	-	A		3-21000-4	SCR, SHC (10-32x.38) SHEAR PLATE	101
1	1	1	-	B		461264-1	PLATE, IDENTIFICATION	100
2	2	2	-	A		3-21002-0	SCR, BHC (10-32x.88) DRAG	99
4	4	4	-	A		2-21002-9	SCR, BHC (10-32x.75) CAP	97
3	3	3	-	A		2-22733-8	SCR, BHC (1/4-20x.62) HSG	96
5	5	5	-	A		2-21002-6	SCR, BHC (10-32x.38) SHEAR BLK	95
2	2	2	-	A		2-21002-2	SCR, BHC (8-32x.50) TERM H DWN	94
2	2	2	-	A		2-21002-1	SCR, BHC (8-32x.38) R STP GDE	93
2	2	2	-	A		22733-8	SCR, BHC (8-32x.38) (LOC-WEL) ANVIL	92
1	1	1	-	A		7-21000-9	SCR, SHC (4-40x.19) STRIPPER	89
1	1	1	-	A		2-22603-1	SCR, HEX HD (8-32x.38) FEED FINGER	86
2	2	2	-	A		2-21000-6	SCR, SHC (8-32x.38) F ST GUIDE	85
1	1	1	-	A		2-21000-7	SCR, SHC (8-32x.50) STRIPPER	84
-	1	-	-	B		462992-7	GUARD ASSY	79
REF	-	-	-	B		679532-1	INSERT, GUARD	78
1	1	1	-	B		459610-3	MOUNT, FEED BRACKET	71

QTY	REQD	PER	ASSY	U/M	DWG SIZE	PART NO	DESCRIPTION	ITEM NO
-3	-2	-1	-					

QTY	REQD	PER	ASSY	U/M	DWG SIZE	PART NO	DESCRIPTION	ITEM NO
-1							LEADMAKER	
-2							BENCH MODEL K	AIRFEED
-3							BENCH MODEL G	AIRFEED
1	1	1	-	C		692655-5	AIR FEED VALVE ASSY	70
-	REF	-	-	A		24042-2	VALVE, SHUT OFF	67
-	REF	-	-	C		692655-6	AIR FEED VALVE ASSY	66
1	1	1	-	B		461065-1	AIR FEED ASSY (1 INCH)	65
2	2	2	-	A		3-21000-9	SCR, SHC (10-32x.75) AIR ASSY	64
1	-	1	-	A		980285-2	ELBOW, SWIVEL 1/8 NPT - 1/4 T	63
1	-	1	-	A		23238-1	QUICK DISCONNECT	62
21.00	-	21.00	IN	A		27319-4	TUBING, POLY-FLO Ø.25	61
1	1	1	-	C		454220-1	CAP, RAM	59
1	1	1	-	D		454485-1	HOUSING	58
1	1	1	-	B		1-694433-3	PAWL, FEED	56
1	1	1	-	B		461062-1	FEED FINGER ASSY	53
1	-	1	-	A		22374-7	VALVE, QUICK EXHAUST	48
1	-	1	-	A		22304-1	NIPPLE, HEX 1/8 NPT	47
1	1	1	-	A		690124-1	WASHER, RAM	46
1	1	1	-	A		690191-1	PLUG, NYLON	45
1	1	1	-	C		808965-1	RAM	44
1	1	1	-	A		690125-1	WASHER, LAMINATED	43
1	1	1	-	A		690124-5	WASHER, RAM	42
1	1	1	-	A		7-21002-9	BOLT, CRIMPER (5/16x1.00)	41
1	1	1	-	A		690223-2	SPACER, INSULATION DISC	38
1	1	1	-	D		354777-1	WIRE DISC, PLASTIC	37
1	1	1	-	A		22480-5	WASHER, SPRING	36
1	1	1	-	B		690212-1	POST, RAM	35
1	1	1	-	D		809010-1	PLATE, BASE	33
1	1	1	-	C		809032-1	PLATE, STRIP GUIDE	29
2	2	2	-	A		1-22284-0	SPRING, DRAG	27
1	1	1	-	B		454175-1	LEVER, DRAG RELEASE	26
1	1	1	-	B		1-690754-6	DRAG, TERMINAL	25
1	1	1	-	D		809030-1	GUIDE, STRIP (REAR)	24
1	1	1	-	A		809033-1	GUIDE, STRIP (FRONT)	23
-	-	1	-	B		690472-8	STRIPPER	22
1	1	1	-	A		679218-1	STRIPPER WIRE STOP ASSY	20
1	1	1	-	B		458949-8	STRIPPER	19
1	1	1	-	C		1213090-1	BLOCK, BASE	14
1	1	1	-	B		809036-2	PLATE, SHEAR, LEFT	13
1	1	1	-	B		1213091-1	ANVIL	8
1	1	1	-	C		809028-1	SPACER, SHEAR	4
1	1	1	-	C		809034-1	BLADE, SHEAR	3
1	1	1	-	C		809029-1	BLOCK, SHEAR	2
1	1	1	-	C		1-456404-6	CRIMPER, WIRE	1

QTY	REQD	PER	ASSY	U/M	DWG SIZE	PART NO	DESCRIPTION	ITEM NO
-3	-2	-1	-					

THIS DRAWING IS A CONTROLLED DOCUMENT FOR AMP INCORPORATED. IT IS SUBJECT TO CHANGE AND THE CONTROLLING ENGINEERING ORGANIZATION SHOULD BE CONTACTED FOR THE LATEST REVISION.

THIS INFORMATION IS CONFIDENTIAL AND IS DISCLOSED TO YOU ON CONDITION THAT NO FURTHER DISCLOSURE IS MADE BY YOU TO OTHER THAN AMP PERSONNEL WITHOUT WRITTEN AUTHORIZATION FROM AMP INCORPORATED, HARRISBURG, PA.

LOC A
DIST 66