

LOOSE PIECE		TAPE MOUNTED		SPECIFICATIONS							
MATERIAL NUMBER	ENGINEERING NUMBER	MATERIAL NUMBER	ENGINEERING NUMBER	STUD SIZE	"S" ±.005 [0.13]	"W" ±.010 [0.25]	"C" MIN.	"L" MAX.	"I.D." MIN.	"H"	STOCK THICKNESS
191930007	AA-320-04	191930008	AA-320-04T	4	.119 [3.02]	.225 [5.72]	.157 [3.99]	.484 [12.29]	.062 [1.57]	.980 [24.89]	.028 $\frac{+.001}{-.000}$ [0.71]
191930009	AA-320-06	191930011	AA-320-06T	6	.146 [3.71]						
191930012	AA-321-06	191930013	AA-321-06T	6	.146 [3.71]	.312 [7.93]	.270 [6.86]	.641 [16.28]	.062 [1.57]	.980 [24.89]	.028 $\frac{+.001}{-.000}$ [0.71]
191930014	AA-321-08	191930015	AA-321-08T	8	.173 [4.39]						
191930016	AA-321-10	191930017	AA-321-10T	10	.198 [5.03]						
191930021	AA-322-14	191930022	AA-322-14T	14	.265 [6.73]	.467 [11.86]	.386 [9.80]	.835 [21.21]	.062 [1.57]	.980 [24.89]	.028 $\frac{+.001}{-.000}$ [0.71]
191930023	AA-322-56	191930024	AA-322-56T	56	.328 [8.33]						
191930026	AA-326-14	---	---	14	.265 [6.73]	.534 [13.56]	.552 [14.02]	1.034 [26.26]	.054 [1.37]	---	.031±.001 [0.79]
191930034	AA-332-06	191930035	AA-332-06T	6	.146 [3.71]	.254 [6.45]	.240 [6.10]	.582 [14.78]	.062 [1.57]	.980 [24.89]	.028 $\frac{+.001}{-.000}$ [0.71]
191930036	AA-332-08	191930037	AA-332-08T	8	.173 [4.39]						

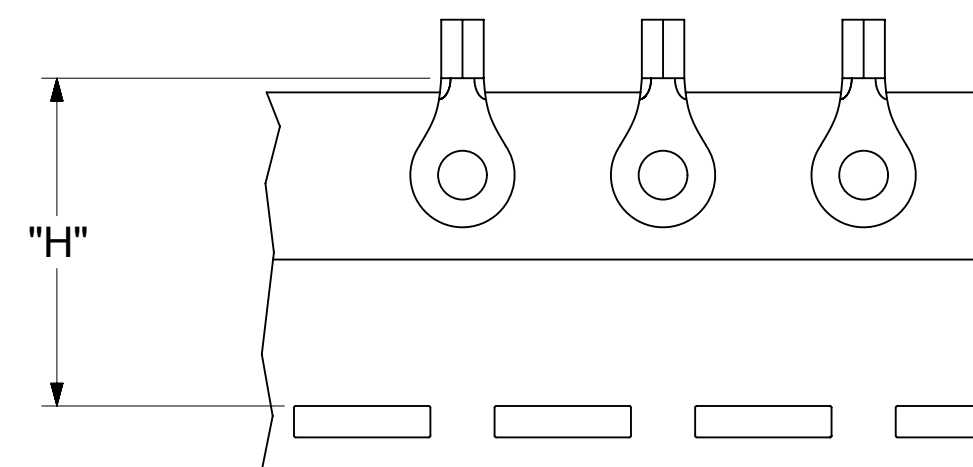
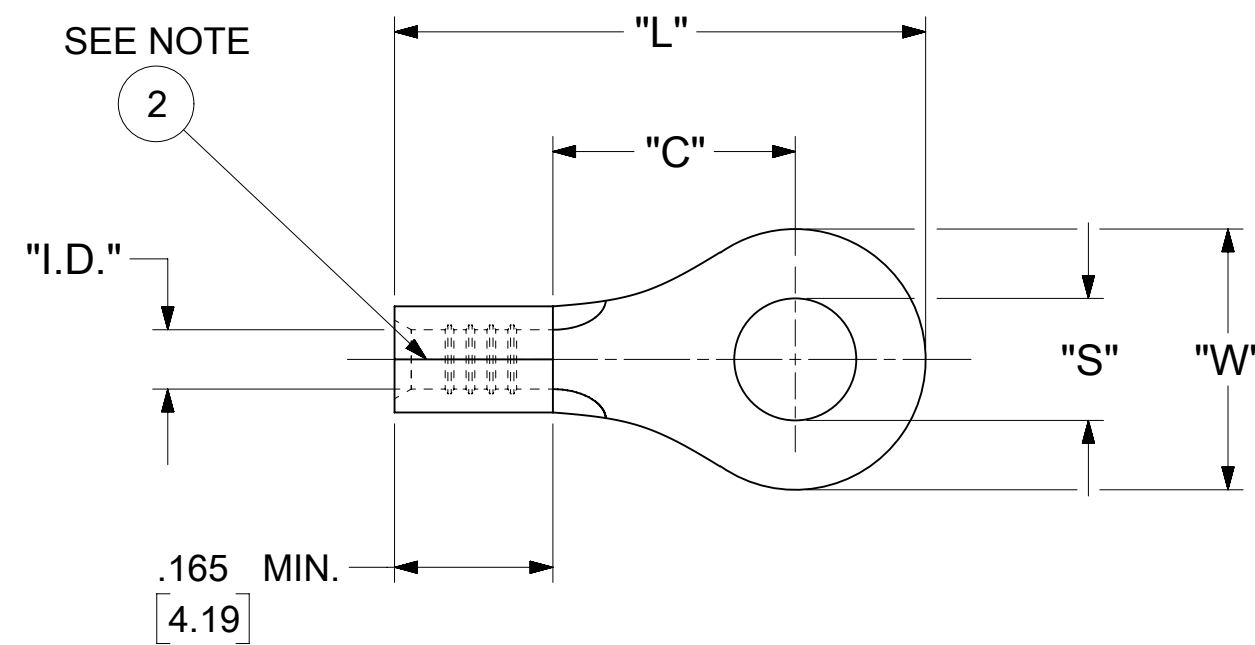

PARTS ON TAPE

NOTES:

- MATERIAL: COPPER
PLATING: ELECTRO-TIN (.0003 MIN).
- BRAZED SEAM
- WIRE SIZE: 22 - 18 AWG
0.25 - 1.5 MM²
- "UL" LISTING #E32244
"CSA" LISTING #18689
- ALL DIMENSIONS IN INCHES/[MM].
- PARTS ARE ROHS COMPLIANT.
- DIMS. SHOWN ARE FOR REFERENCE ONLY.

SYMBOLS	THIS DRAWING CONTAINS INFORMATION THAT IS PROPRIETARY TO MOLEX ELECTRONIC TECHNOLOGIES, LLC AND SHOULD NOT BE USED WITHOUT WRITTEN PERMISSION			
	DIMENSION UNITS	SCALE		CURRENT REV DESC: MIGRATION TO ECTR/NX
▽ = 0	INCH/MM	NTS		EC NO: 620820 DRWN: ABENJAMINLW 2019/07/08 CHK'D: GROJAS01 2019/07/17 APPR: JMACNEIL 2019/08/06
▽ = 0	GENERAL TOLERANCES (UNLESS SPECIFIED)			
▽ = 0		MM	INCH	INITIAL REVISION: DRWN: JJ 1984/11/27 APPR: JMACNEIL 2019/08/06
▽ = 0	4 PLACES	± ---	± ---	
▽ = 0	3 PLACES	± ---	± .005	THIRD ANGLE PROJECTION
▽ = 0	2 PLACES	± 0.13	± .01	
▽ = 0	1 PLACE	± 0.25	± ---	DRAWING SERIES
☒ = 0	0 PLACES	± ---	± ---	C-SIZE 19193
■ = 0	ANGULAR TOL ± 0.5 °			
▽ = 0	DRAFT WHERE APPLICABLE MUST REMAIN WITHIN DIMENSIONS			

molex

RING TONGUE TERMINAL
VERSAKRIMP 300-SERIES

PRODUCT CUSTOMER DRAWING

DOCUMENT NUMBER	DOC TYPE	DOC PART	REVISION
191930398	PSD	000	A
MATERIAL NUMBER	CUSTOMER	SHEET NUMBER	
SEE TABLE	GENERAL MARKET	1 OF 1	

- NOTES:**
 ① MAT'L: COPPER
 PLATING: ELECTRO-TIN (.0003 MIN.)
 ② BRAZED SEAM

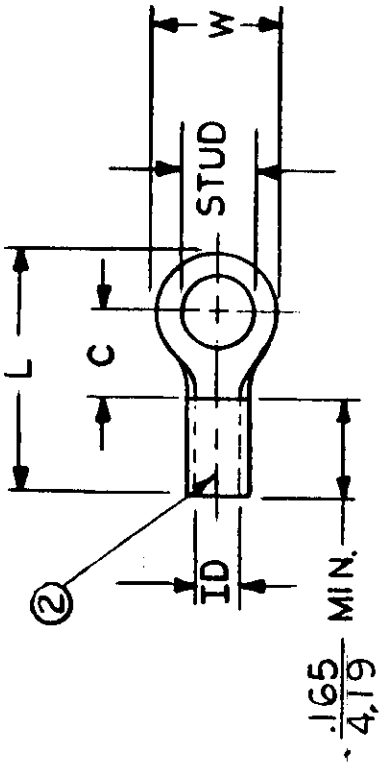

STUD SIZES: (±.005)

- 02 = .094
- 04 = .119
- 06 = .146
- 08 = .173
- 10 = .198
- 14 = .265
- 56 = .328
- 38 = .390
- 209 = .209

"UL" LISTING *E32244
 "CSA" LISTING *18689

WIRE SIZE: 22-18 AWG
 .25-1.5 MM²

ALL DIMENSIONS = $\frac{\text{INCHES}}{\text{MM}}$

PART NUMBER	"W" ±.010	"C" MIN.	"L" MAX.	"ID" MIN.	AVAILABLE STUD SIZES	STOCK THICKNESS	TITLE:	
							SCALE: NTS	DATE
AA-320-	$\frac{.225}{5.72}$	$\frac{.157}{3.99}$	$\frac{.484}{12.29}$	$\frac{.062}{1.57}$	02, 04, 06	$\frac{.028 \pm .001}{.71}$	RING TONGUE TERMINAL	
AA-321-	$\frac{.312}{7.93}$	$\frac{.270}{6.86}$	$\frac{.641}{16.28}$	$\frac{.062}{1.57}$	06, 08, 10, 209	$\frac{.028 \pm .001}{.71}$	VERSAKRIMP 300-SERIES	
AA-322-	$\frac{.467}{11.86}$	$\frac{.386}{9.80}$	$\frac{.835}{21.21}$	$\frac{.062}{1.57}$	10, 14, 56	$\frac{.028 \pm .001}{.71}$		
AA-326-	$\frac{.534}{13.56}$	$\frac{.552}{14.02}$	$\frac{1.034}{26.26}$	$\frac{.054}{1.37}$	10, 14, 56, 38	$\frac{.031 \pm .001}{.79}$		
AA-332-	$\frac{.254}{6.45}$	$\frac{.240}{6.10}$	$\frac{.582}{14.78}$	$\frac{.062}{1.57}$	04, 06, 08	$\frac{.028 \pm .001}{.71}$		
DIMENSIONAL TOLERANCES UNLESS OTHERWISE SPECIFIED							EIC ^{mo} lex INCORPORATED	
FRAC.	DEC.	ANG.	DRWN. BY: JJ		DATE: 11-27-84		DWG. NO. A CUSTOMER DWG.	
±	±	±	CHKD. BY: GZ		DATE: 11-30-84			
±	±	±	APPRD. BY:					