

**TECHNICAL SPECIFICATIONS**

**D-Sub Hood:**

Material: Zinc, Nickel Plated  
 Operating Temperature: -40°C to +120°C  
 Cable Entry: 45° Side Entry  
 Thumbscrews: UNC 4-40 (Standard)  
 Cable O.D.: Up to 11,5mm (Size 9-37)  
 Up to 17mm (Size 50)

**Male D-Sub Solder Cup:**

Insulator: PBT, Black, UL94 V-0  
 Shell: Steel, Tin Plated  
 Contact pins: Copper Alloy  
 Stamped & Formed Pins: Class 3, 100 inserts min.  
 Machined Contact Pins: Class 1, 500 inserts min.  
 Contact Plating: Selective Gold over Nickel  
 Operating Temperature: -55°C to +105°C  
 Withstanding voltage: 1000V for 1 minute  
 Insulator resistance: 1000MΩ min.

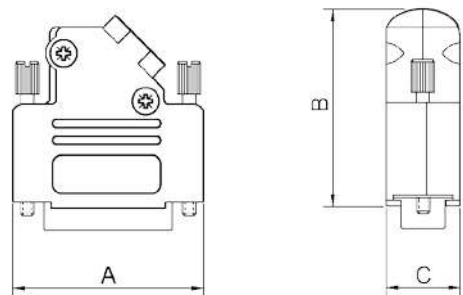

**Features:**

- Available in sizes 9-15-25-37
- Excellent EMI Shielding
- Re-openable
- Strain relief inserts ensure a secure termination

Size D45ZK	Dim A	Dim B	Dim C
9-way	31,0	36,3	14,5
15-way	39,5	40,3	14,5
25-way	53,2	40,3	14,5
37-way	69,7	40,3	14,5

**Ordering information - Black Insulator:**

Size:	P/N - Kitted:	Class 3 - 100 inserts min.
9-way	6355-0003-01	D45ZK09-DBP-K
15-way	6355-0003-02	D45ZK15-DBP-K
25-way	6355-0003-03	D45ZK25-DBP-K
37-way	6355-0003-04	D45ZK37-DBP-K
50-way	6355-0003-05	D45ZK50-DBP-K

Size:	P/N - Kitted:	Class 1 - 500 inserts min.
9-way	6355-0003-21	D45ZK09-DMP-K
15-way	6355-0003-22	D45ZK15-DMP-K
25-way	6355-0003-23	D45ZK25-DMP-K
37-way	6355-0003-24	D45ZK37-DMP-K
50-way	6355-0003-25	D45ZK50-DMP-K

**Ordering information - White Insulator:**

Size:	P/N - Kitted:	Class 3 - 100 inserts min.
9-way	6355-8003-01	D45ZK09-DBP-W-K
15-way	6355-8003-02	D45ZK15-DBP-W-K
25-way	6355-8003-03	D45ZK25-DBP-W-K
37-way	6355-8003-04	D45ZK37-DBP-W-K
50-way	6355-8003-05	D45ZK50-DBP-W-K

Size:	P/N - Kitted:	Class 1 - 500 inserts min.
9-way	6355-8003-21	D45ZK09-DMP-W-K
15-way	6355-8003-22	D45ZK15-DMP-W-K
25-way	6355-8003-23	D45ZK25-DMP-W-K
37-way	6355-8003-24	D45ZK37-DMP-W-K
50-way	6355-8003-25	D45ZK50-DMP-W-K

