

MOUNTING DETAIL

NOTES:

1. ACCEPTS MOLEX .093/(2.36) TERMINALS.
2. MATES WITH 1396-R* HOUSINGS.
3. RECOMMENDED DIRECTION OF PUNCH.
4. PART CONFORMS TO PRODUCT SPEC 02-09.
5. MATERIAL:
NYLON TYPE 6/6, 94V-2
NATURAL COLOR
6. CIRCUIT I.D. NUMBERS ON SIDE OF HOUSING
APPEAR ON PARTS FROM TOOLS BUILT AFTER
5/4/93.

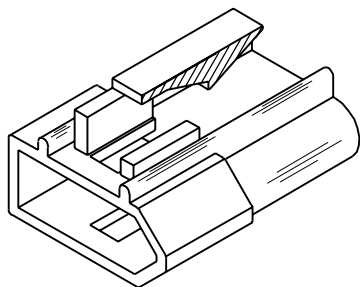
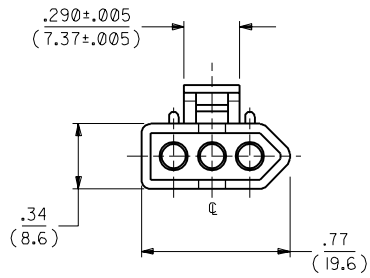

PLUG
SHOWN ABOVE WITH SIDE PANEL MOUNT

DO NOT WORK ARE A PLOT

B	I	B	A
MFG.	SH.	REV.	LTR.
ADD OKT. I.D. **S PER ECR U3 0683 5/4/93 RW			REINSTATED 1396-P3 ECR * 1990991 KBW 09-06-89 RW
REVISIONS			

DIMENSIONS SHOWN (METRIC) INCH			
UNLESS OTHERWISE SPECIFIED TOLERANCES ANGULAR ± 1/2°			
	INCH	METRIC	
3 PLACE	± .010	---	
2 PLACE	± .014	± 0.25	
1 PLACE	---	± 0.35	
DRAFT WHERE APPLICABLE MUST REMAIN WITHIN DIMENSIONS			
DRWG. BY: KBW	CHK'D. BY: RW	SCALE: 2 : 1	
APP'D. BY: GWF			

TITLE		REVISE ONLY ON CAD SYSTEM	
.093/(2.36) HOUSING PLUG, SIDE MOUNT 3 CIRCUIT, .198/(5.03) C		SHEET NO. 1 OF 1	DATE 09/06/89
MOLEX INCORPORATED L1SLE,ILL. 60532 U.S.A.			
PART NO. 03-09-2037	DRWG. NO. SD-1396-P3		
THIS DRAWING CONTAINS INFORMATION THAT IS PROPRIETARY TO MOLEX INC. AND SHOULD NOT BE USED WITHOUT WRITTEN PERMISSION.		DIV. CP	SIZE C