

PROPERTY OF DEUTSCH E.C.D.

This drawing contains proprietary information that shall not be disclosed, duplicated, nor used in whole or in part for any purpose other than to evaluate this drawing.

F DGA00B\*\*-EN\*\*P/S

REVISIONS			
REV	DESCRIPTION	DATE	APPROVED
F	CHANGED PER E.O. C4951	5/9/2001	RAC

DG123		AF123		DGI23A		DGI23A	
CABLE CODE	INSERT ARR	CABLE CODE	INSERT ARR	CABLE CODE	INSERT ARR	CABLE CODE	INSERT ARR
10	08-04	72	10-03	38	09-35	59	21-35
11	10-03	73	10-05	39	09-98	60	21-41
12	10-05	74	14-04	40	11-05	61	23-21
13	10-12	75	14-09	41	11-35	62	23-35
14	14-04	76	14-19	42	11-99	63	23-53
15	14-09	77	16-07	43	13-04	64	23-55
16	14-19	78	16-14	44	13-35	65	25-04
17	14-37	79	16-27	45	13-98	66	25-19
18	16-07	80	18-09	46	15-05	67	25-20
19	16-14	81	18-21	47	15-18	68	25-24
20	16-27	82	18-38	48	15-35	69	25-29
21	16-55	83	20-11	49	15-97	70	25-35
22	18-09	84	20-24	50	17-06	71	25-61
23	18-21	85	20-45	51	17-08	92	11-98
24	18-38	86	22-14	52	17-26	93	15-19
25	18-85	87	22-32	53	17-35	94	13-08
26	20-11	88	22-61	54	19-11	95	17-99
27	20-24	89	24-19	55	19-32	96	21-39
28	20-45	90	24-41	56	19-35	97	25-43
29	20-92	91	24-74	57	21-11	101	17-04
30	22-14			58	21-16		
31	22-32						
32	22-61						
33	22-121						
34	24-19						
35	24-41						
36	24-74						
37	24-155						

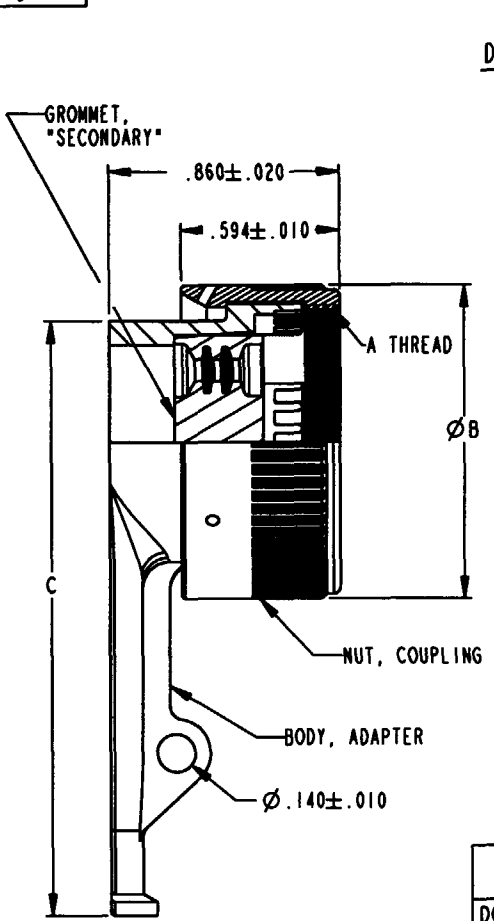

DGA00 A B \*\* - EN \*\* P

INSERT TYPE: P = PIN  
S = SOCKET

CABLE INSERT ARRANGEMENT  
SEE TABLE FOR COMPLETE LIST

TYPE: EN = ENVIRONMENTAL 90 DEGREE

SHELL SIZE (SEE TABLE)

CONFIGURATION

FINISH: A = BLACK COMPOSITE UNPLATED  
R = METALLIZED ADAPTER BODY

BASIC IDENTIFIER: DGA00 - DEUTSCH DGI23 REAR ACCESSORIES

DEUTSCH PART NUMBER **	SHELL SIZE	A THREAD	B Ø ±.015	C Ø ±.020
DGA00AB08/09-EN**P/S	08/09	.500-28UNEF-2B MOD	.650	1.950
DGA00AB10/11-EN**P/S	10/11	.625-28UN-2B MOD	.775	2.010
DGA00AB13-EN**P/S	13	.750-28UN-2B MOD	.905	2.075
DGA00AB14/15-EN**P/S	14/15	.875-28UN-2B MOD	1.030	2.140
DGA00AB16/17-EN**P/S	16/17	1.000-28UN-2B MOD	1.160	2.200
DGA00AB18/19-EN**P/S	18/19	1.125-28UN-2B MOD	1.270	2.260
DGA00AB20/21-EN**P/S	20/21	1.250-28UN-2B MOD	1.400	2.320
DGA00AB22/23-EN**P/S	22/23	1.375-28UN-2B MOD	1.525	2.385
DGA00AB24/25-EN**P/S	24/25	1.500-28UN-2B MOD	1.655	2.445

- △ FOR PART NUMBER BREAKDOWN, SEE TABLE.
- RECOMMENDED TORQUE: SHELL SIZES 08-16: 20-30 IN./LBS.  
SHELL SIZES 18-24: 35-45 IN./LBS.
  - MATERIAL: COUPLING NUT: COMPOSITE  
ADAPTER BODY: COMPOSITE  
SECONDARY GROMMET: SILICONE ELASTOMER
  - CONSULT FACTORY FOR AVAILABILITY.
  - ALL DIMENSIONS ARE IN INCHES UNLESS OTHERWISE SPECIFIED.

SIGNATURE & DATE	
DR	A. RASMUSSEN 20FEB01
CHK	[Signature]
PE	[Signature]
APPD	[Signature]
SCALE	NONE WT

**STRAIN RELIEF**  
90 DEGREE ONE ARM STYLE  
LIGHT DUTY  
DGA SERIES  
ENVELOPE

CP

**DEUTSCH**  
ENGINEERED CONNECTING DEVICES  
5733 W. Whittier Ave.  
Hemet, California

**A** DGA00B\*\*-EN\*\*P/S

CODE 11129 SHEET 1 OF 1