

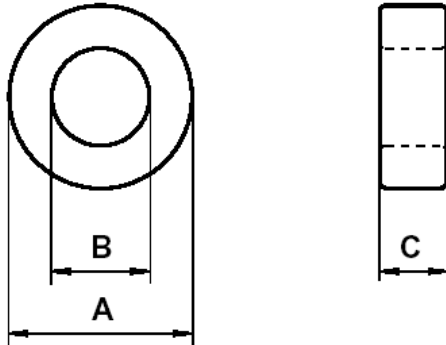

Specification for:
ZP42206TC

110 Delta Drive
Pittsburgh, PA 15238
Phone: 412/696-1333
Fax: 412/696-0333
Email:magnetics@spang.com

DIMENSIONS



(mm)	Uncoated Nominal:	Coated Min:	Coated Max:
O.D. (A)	22.1	21.84	22.86
I.D. (B)	13.7	12.95	13.95
Ht. (C)	6.25	6.39	6.91

Eff. Parameters		
A _e mm ²	l _e mm	V _e mm ³
25.8	54.1	1395

INDUCTANCE

AL value (nH/T ²)	Test conditions
1510 ± 25%	10 kHz, 0.5 mT (For N = 5, use 1 mA), 25°C

CORE LOSSES

P _L max	Production lot limit Max avg	Test conditions
175 mW (125 mW/cm ³)	159 mW (114 mW/cm ³)	100 kHz, 100 mT, 100°C

COATING

Epoxy rated for 200°C continuous operation.
Voltage breakdown rating 1500 V _{DC} Min Wire-to-Wire.

NOTE

Spec. Modifications	Previous	Revised
2006.06.21	Bare Nom Ht = 6.35 Losses: General P material Breakdown voltage > 1,000 V	Bare Nom Ht = 6.25 Losses: Detail as indicated Breakdown voltage > 1,500 V _{DC}