

REVISIONS				
REV	ECO	DESCRIPTION	DATE	BY APPR
A1	-	FIRST RELEASE	21-Nov-14	DRACK TOMMY

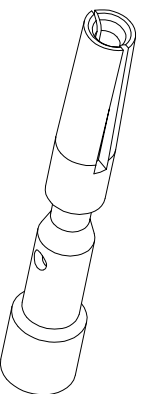
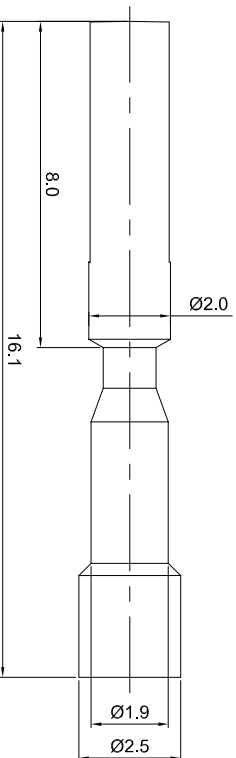
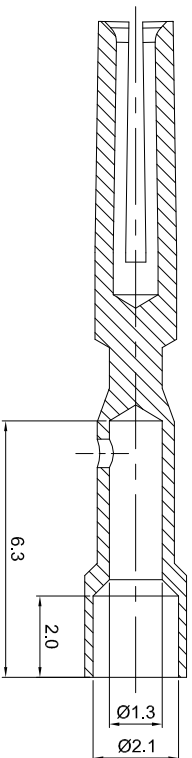
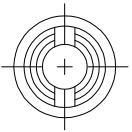

- NOTES: UNLESS OTHERWISE SPECIFIED
- MATERIAL: COPPER ALLOY, GOLD PLATED
 - SPECIFICATIONS:
 - 2.1 RATED CURRENT: 7 AMPS
 - 2.2 CONTACT RESISTANCE: <5 milliohm
 - 2.3 AVAILABLE WIRE RANGE: 18-22AWG
 - 2.4 ROHS COMPLIANT
 - ALL DIMENSIONS ARE FOR REFERENCE USE ONLY.

QUANTITY	SEE PART NUMBER CHART	PART NUMBER	DESCRIPTION	ITEM	
MATERIALS LIST					
UNLESS OTHERWISE SPECIFIED					
1) All dimensions are in millimeters.					
2) Tolerances are as follows:					
1 Pt. DEC 20-30 Fractions .1/16"					
3 Pt. DEC 20-30 Angles 1°					
3) Note reference = Δ					
MATERIAL SPECIFICATIONS:		CUSTOMER:	Socket 20# Chmp 18-22AGW		
PROCESS SPECIFICATIONS:		THIS DRAWING IS SUPPLIED FOR INFORMATION ONLY. SPECIFICATIONS AND PERFORMANCE DATA ARE THE PROPERTY OF SHINE SYSTEMS, INC. AND ARE NOT TO BE REPRODUCED OR TRANSMITTED IN ANY FORM OR BY ANY MEANS, ELECTRONIC OR MECHANICAL, INCLUDING PHOTOCOPYING, RECORDING, OR BY ANY INFORMATION STORAGE AND RETRIEVAL SYSTEM. ALL DIMENSIONS ARE IN MILLIMETERS UNLESS OTHERWISE SPECIFIED.	SIZE	TYPE	DWG NO.
NEXT ASSY:		SCALE:	8 : 1	B	C-
		SCALE:	8 : 1	SC000326	A1

Amphenol
 Shine Systems - www.amphenol-shine.com
 44724 Morley Drive
 Clinton Township, MI 48036