

SPECIFICATIONS

- 4 contacts, female
- Panel mount
- Locking
- Sealed
- Solder cup termination
- Gold contact finish
- Maximum current 5A
- Dielectric withstanding voltage 1,000 V
- Operating life 5,000 cycles
- Operating temperature -55 to +85°C

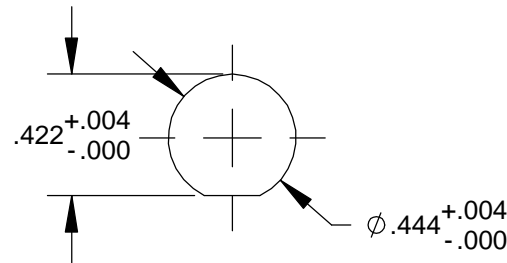
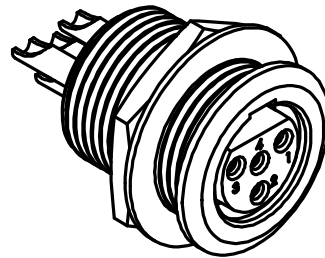

**RECOMMENDED
PANEL CUT-OUT**

MATERIALS

- HOUSING AND MOUNTING HARDWARE: copper alloy, nickel plated
- INSULATOR: high grade thermoplastic
- CONTACTS: copper alloy, gold plated

CUSTOMER DRAWING

					★ STAR SYMBOL DENOTES CRITICAL DIMENSION	THIS DRAWING DESCRIBES A DESIGN CONSIDERED PROPRIETARY IN NATURE, DEVELOPED AND MANUFACTURED BY SWITCHCRAFT INC. AND IS RELEASED ON A CONFIDENTIAL BASIS FOR IDENTIFICATION PURPOSES ONLY.							
					<p>UNLESS OTHERWISE SPECIFIED</p> <p>1. ALL DIMENSIONS IN INCHES</p> <ul style="list-style-type: none"> - TWO PLACE DECIMALS ±0.01 - THREE PLACE DECIMALS ±0.005 - ANGLES ±1° - ALL DIA. CONCENTRIC WITHIN 0.005 T.I.R. <p>2. FEATURES ON THE SAME CENTERLINE MUST BE ALIGNED WITHIN ±0.002</p> <p>3. REMOVE ALL BURRS</p>	SIZE	WIDTH	MULT	LBS/M	TEMPER			
						FINISH	MATERIAL						
						SPEC No.	SPEC No.						
						FIRST USED ON	SCALE 2:1						
A	24810	9-16-04	JL	MA	DATE DRAWN	BY	CHKD	APVD					
REV	ECO NUMBER	DATE	BY	APVD	9-15-00	MA	MA	MA				SHEET 1 OF 1	
REVISIONS					DO NOT SCALE DRAWING					PART No. TRGS4F			REV A