

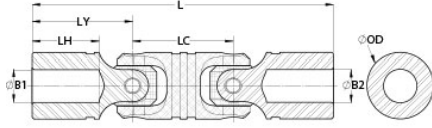

UD20-14MM-7/16"-F

Ruland UD20-14MM-7/16"-F, 14mm x 7/16" Double Universal Joint, Friction Bearing, Steel, 1.245" (31.6mm) OD, 5.625" (142.9mm) Length



Description

Ruland UD20-14MM-7/16"-F is a double cardan friction bearing universal joint with 14mm x 0.4375" bores, 1.245" (31.6mm) OD, and 5.625" (142.9mm) length. It is ideal for applications with wide distances between shafts and can accommodate all forms of misalignment. This plain bearing double universal joint is comprised of pins and blocks that are precision machined, selectively heat treated, and ground for high strength, accuracy, and wear resistance. The combination of these components with precision ground and hardened yoke ears allow for a longer lifespan, increased performance in demanding applications, and greater angular misalignment of up to 90° when compared to commodity style double universal joints. UD20-14MM-7/16"-F is made from high grade stainless steel for increased corrosion resistance. It can be combined with boot UBOOT20/32-NI-KIT to protect the joints from unwanted contaminants such as dust or water and self lubricate reducing maintenance time. This double cardan universal joint is manufactured in the USA by Belden Universal for strict control of processes.

Product Specifications

Bore (B1)	14 mm	Small Bore (B2)	0.4375 in
B1 Max Shaft Penetration	1.250 in (31.8 mm)	B2 Max Shaft Penetration	1.250 in (31.8 mm)
Joint Outer Diameter (OD)	1.245 in (31.6 mm)	Bore Tolerance	+0.0010 in / -0.0000 in (+0.025 mm / -0.000 mm)
Length (L)	5.625 in (142.9 mm)	Center Yoke Length (LC)	1.875 in (47.6 mm)
Yoke Length (LY)	1.875 in (47.6 mm)	Hub Depth (LH)	1.250 in (31.8 mm)
Peak Torque	4,700 in-lb (531.0 Nm)	Rated Torque	940 in-lb (106.2 Nm)
Max Operating Angle	90°	Material Specification	Alloy Steel
Manufacturer	Belden Universal	Country of Origin	USA
Weight (lbs)	1.329000	Recommended Lubricant	LUBRIPLATE No. 1200-2
Matching Boot Cover	UBOOT20/32-NI-KIT	UPC	63452936974
Tariff Code	8483.60.4000	UNSPC	25173810

Note 1 Performance ratings are for guidance only. The user must determine suitability for a particular application.

Prop 65  **WARNING** This product can expose you to the chemical Ethylene Thiourea, known to the State of California to cause cancer and birth defects or other reproductive harm. For more information go to www.P65Warnings.ca.gov.