



### Electrical specifications

**Center Frequency:** 2350 MHz  
**Bandwidth:** 100 MHz  
**VSWR:** 1.5 : 1  
**Input / Output Impedance:** 50 Ohms  
**Passband:** 2300-2400 MHz  
**Passband Insertion Loss:** 2.5 dB max  
**Passband Ripple:** 1.0 dB max  
**Rejection:** 12 dB min at 2270 MHz  
**Rejection 2:** 12 dB min at 2430 MHz  
**Power Handling:** 30 dBm max

### Mechanical

**Mounting Method:** SMT  
**Dimensions:** 10.60 x 6.60 x 4 mm

### Environmental

**Operating Temperature:** -40°C to 85°C  
**Storage Temperature:** -50°C to +90°C

This product is RoHS compliant.

### Outline Drawing:

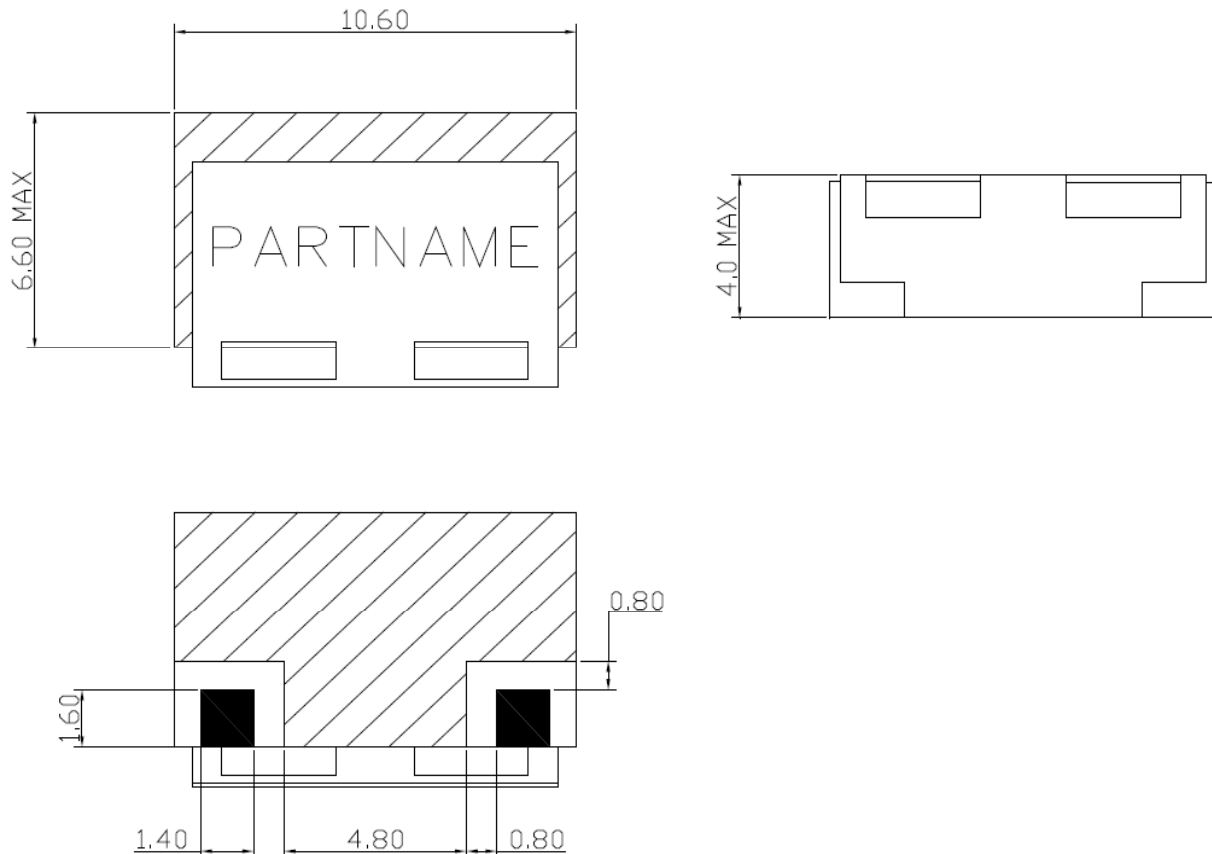



**ANATECH ELECTRONICS INC**  
RF & Microwave Filters & Products

# 2350 MHz Ceramic Bandpass Filter

**Part Number: AM2350B1310**



## Response Plot:

