

THIS DRAWING IS UNPUBLISHED. RELEASED FOR PUBLICATION APRIL, 2004.  
 © COPYRIGHT 2004 BY TYCO ELECTRONICS CORPORATION. ALL RIGHTS RESERVED.

| LOC | DIST | REVISIONS   |              |         |        |
|-----|------|-------------|--------------|---------|--------|
| P   | LTR  | DESCRIPTION | DATE         | DWN     | APVD   |
| E   | B    | A           | EBD0-0035-03 | 03FEB04 | RS FWK |

- NOTES:
- ① SINGLE PACK IN ACCORDANCE WITH SPEC 107-3275
  - ② 100 TRAY PACK IN ACCORDANCE WITH SPEC 107-3275
  - ③ 0.08μm Au PLATING OVER 1.27μm Ni PLATING
  - ④ 0.08μm Au PLATING OVER 1.27μm Ni PLATING OVER 0.76μm Cu PLATING
  - ⑤ 0.76μm Au PLATING OVER 1.27μm Ni PLATING OVER 0.76μm Cu PLATING
  - ⑥ PASSIVATED
  - ⑦ WHITE BRONZE PLATING
  - ⑧ PLATING AS PER BODY, EXCEPT FOR PASSIVATED WHICH IS NICKEL PLATED
  - 9 HAND TOOL 9-1478240-0
  - 10 DIE SET 9-1478242-0
  - 11 FOR TECHNICAL DATA REFER TO YOUR LOCAL TYCO ELECTRONICS SALES OFFICE
  - 12 ALL DIMENSIONS ARE NOMINAL FOR REFERENCE ONLY UNLESS OTHERWISE STATED

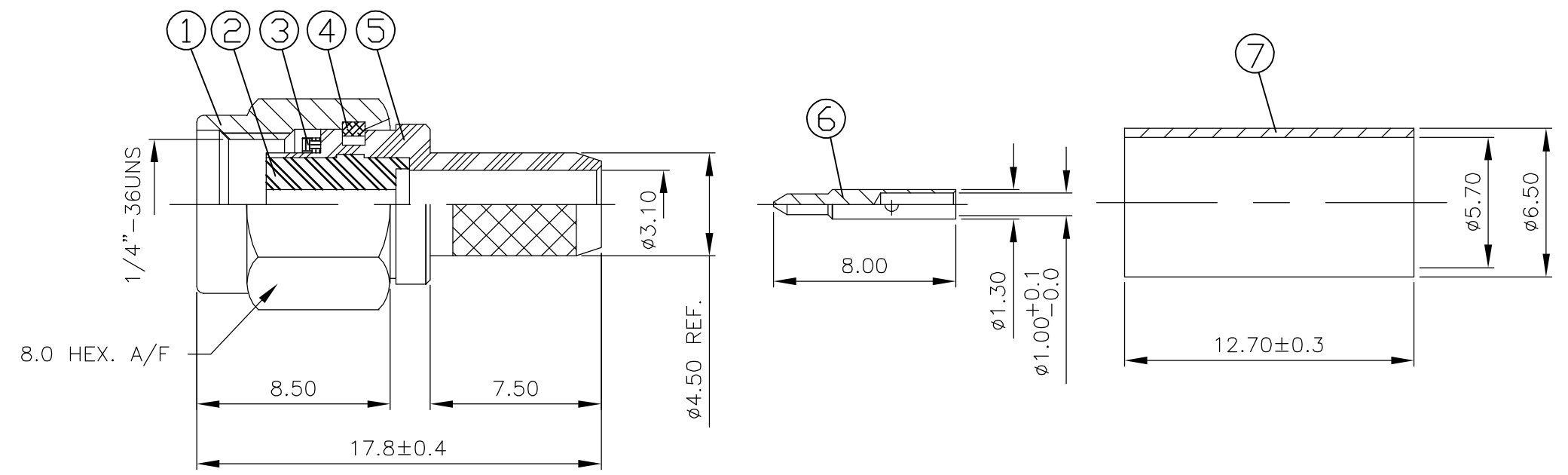

| QTY  | QTY  | QTY  | QTY  | QTY  | QTY  | QTY  | QTY  | QTY | MATERIAL        | DESCRIPTION      | ITEM |
|------|------|------|------|------|------|------|------|-----|-----------------|------------------|------|
| 1    | 1    | 1    | 1    | 1    | 1    | 1    | 1    | 1   | BRASS           | ⑧ CRIMP SLEEVE   | 7    |
| 1    | 1    | 1    | 1    | 1    | 1    | 1    | 1    | 1   | BRASS           | ⑤ CENTER CONTACT | 6    |
| 1    | 1    | -    | -    | -    | -    | -    | -    | -   | BRASS           | ⑦ BODY           | 5    |
| -    | -    | 1    | 1    | -    | -    | -    | -    | -   | BRASS           | ④ BODY           | 5    |
| -    | -    | -    | -    | 1    | 1    | -    | -    | -   | STAINLESS STEEL | ⑥ BODY           | 5    |
| -    | -    | -    | -    | -    | -    | 1    | 1    | -   | STAINLESS STEEL | ③ BODY           | 5    |
| 1    | 1    | 1    | 1    | 1    | 1    | 1    | 1    | 1   | STAINLESS STEEL | CIRCLIP          | 4    |
| 1    | 1    | 1    | 1    | 1    | 1    | 1    | 1    | 1   | SILICON         | GASKET           | 3    |
| 1    | 1    | 1    | 1    | 1    | 1    | 1    | 1    | 1   | PTFE            | INSULATOR        | 2    |
| 1    | 1    | -    | -    | -    | -    | -    | -    | -   | BRASS           | ① SHELL          | 1    |
| -    | -    | 1    | 1    | -    | -    | -    | -    | -   | BRASS           | ④ SHELL          | 1    |
| -    | -    | -    | -    | 1    | 1    | -    | -    | -   | STAINLESS STEEL | ⑥ SHELL          | 1    |
| -    | -    | -    | -    | -    | -    | 1    | 1    | -   | STAINLESS STEEL | ③ SHELL          | 1    |
| 4--1 | 4--0 | 3--1 | 3--0 | 2--1 | 2--0 | 1--1 | 1--0 |     | MATERIAL        | DESCRIPTION      | ITEM |
| ②    | ①    | ②    | ①    | ②    | ①    | ②    | ①    |     |                 |                  |      |

RECOMMENDED CRIMP SLEEVE A/F HEX

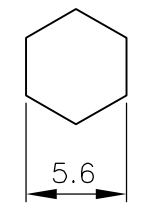

RECOMMENDED CABLE STRIPPING DIM'S

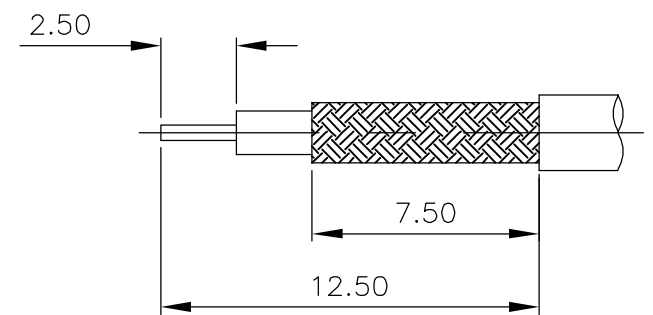

|  |  |                             |  |                 |
|--|--|-----------------------------|--|-----------------|
| THIS DRAWING IS A CONTROLLED DOCUMENT. |  | DWN R.SMITH 03FEB04         | Tyco Electronics Corporation<br>Bideford, UK, EX39 4HE             |                 |
| DIMENSIONS: mm                         |  | CHK S.PARLOW 03FEB04        |  |                 |
| TOLERANCES UNLESS OTHERWISE SPECIFIED: |  | APVD F.WHEELER-KING 03FEB04 | NAME SMA STRAIGHT PLUG NON CAPTIVE SOLDER CONTACT CRIMP ATTACHMENT |                 |
| 0 PLC ± -                              |  | PRODUCT SPEC 108-3460       | RG55B/U, 142B/U, 223/U, 400/U, KX23                                |                 |
| 1 PLC ± -                              |  | APPLICATION SPEC 411-3276   | SIZE A3  | CAGE CODE 00779 |
| 2 PLC ± -                              |  | WEIGHT -                    | DRAWING NO C-1478917   |                 |
| 3 PLC ± -                              |  | MATERIAL SEE TABLE          | RESTRICTED TO -  |                 |
| 4 PLC ± -                              |  | FINISH -                    | SCALE 1:1 SHEET 1 OF 1 REV A                                       |                 |
| ANGLES ± -                             |  |                             | CUSTOMER DRAWING   |                 |