

**NOTES:**

1. COMPATIBLE WITH MOLEX PT 90325, 90814, 90816.
2. USE WITH CABLES 28AWG STD. 26AWG STD. AND 26AWG (69 STRANDS) SUPERFLEX.
3. TERMINATION SPECIFICATION: ES-99033-0001.
4. PRODUCT SPECIFICATION: PS-99020-0011
5. PACKAGING SPEC: PK-90327-001

**HOUSING:**

MATL: POLYESTER RATED AT UL 94 V-0,  
COLOUR WHITE.

**IDT CONTACT**

MATL. PHOS BRONZE 0.17 THK HV 180-200  
PLATING. TIN: 2-4µm PURE TIN  
PLATING. UNDERPLATED 1.27µm MIN NICKEL  
3-5µm SELECTIVE TIN & 0.76µm MIN. SELECTIVE GOLD

90327 - \* 3 \* \*  
0 = 2µm PRE TIN ASSY  
3 = 0.76µm GOLD ASSY  
SEE CONTACT PLATING NOTE  
04 TO 26 = CCT SIZE, 51 TO 98 = ASSY ON REELS, SEE CHART  
COLOUR WHITE

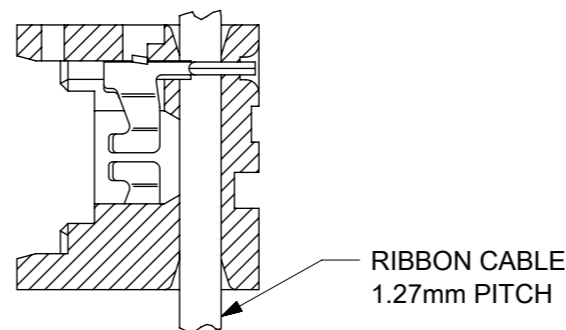

**SECTION SHOWING  
ASSY AFTER TERMINATION  
SEE NOTE 3**

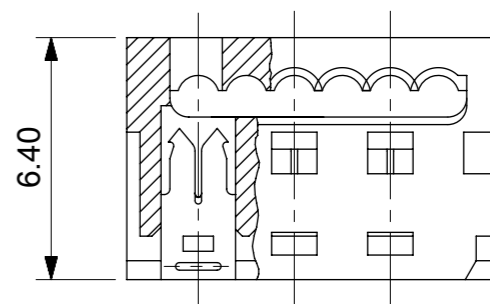
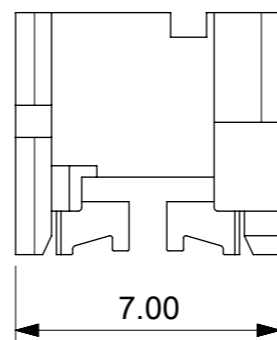
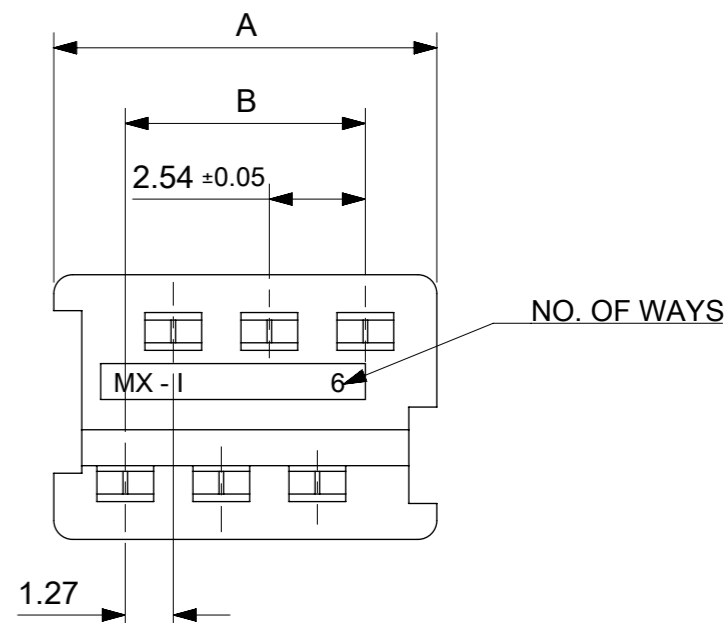

|            |          |             |             |
|------------|----------|-------------|-------------|
| 90327-*326 | 26       | 35.53       | 31.75       |
| -*324      | 24       | 32.99       | 29.21       |
| -*322      | 22       | 30.45       | 26.67       |
| -*320      | 20       | 27.91       | 24.13       |
| -*318      | 18       | 25.37       | 21.59       |
| -*316      | 16       | 22.83       | 19.05       |
| -*314      | 14       | 20.29       | 16.51       |
| -*312      | 12       | 17.75       | 13.97       |
| -*310      | 10       | 15.21       | 11.43       |
| -*308      | 8        | 12.67       | 8.89        |
| -*306      | 6        | 10.13       | 6.35        |
| 9327-*304  | 4        | 7.59        | 3.81        |
| PART NO.   | CCT SIZE | DIMENSION A | DIMENSION B |

| FUNCTIONAL SYMBOLS | DIMENSION UNITS                                      | SCALE | THIS DRAWING CONTAINS INFORMATION THAT IS PROPRIETARY TO MOLEX ELECTRONIC TECHNOLOGIES, LLC AND SHOULD NOT BE USED WITHOUT WRITTEN PERMISSION |        |                 |  |
|--------------------|--|-------|---|--------|-----------------|--|
| $\nabla_A = 0$     | mm   | 5:1   | CURRENT REV DESC: CAD MIGRATION   |        |                 |  |
| $\nabla_F = 0$     | GENERAL TOLERANCES (UNLESS SPECIFIED)                |       |   |        |                 |  |
| $\nabla_P = 0$     | ANGULAR TOL ± 2°                                     |       |   |        |                 |  |
| DIVISIONAL SYMBOLS | 4 PLACES ±   |       |   |        |                 |  |
|                    | 3 PLACES ±   |       |   |        |                 |  |
|                    | 2 PLACES ± 0.10                                      |       |   |        |                 | EC NO: 738955<br>DRWN: GOWTHP 2023/02/02<br>CHK'D: GOWTHP 2023/02/16<br>APPR: ISHWARG 2023/02/20 |
|                    | 1 PLACE ± 0.2  |       |   |        |                 |  |
|                    | 0 PLACES ±   |       |   |        |                 |  |
|                    | DRAFT WHERE APPLICABLE MUST REMAIN WITHIN DIMENSIONS |       |   |        |                 |  |
|                    | THIRD ANGLE PROJECTION                               |       | DRAWING   | SERIES | MATERIAL NUMBER | CUSTOMER   |
|                    |  |       | A3-SIZE   | 90327  | SEE CHART       | GENERAL MARKET   |
|                    |  |       | INITIAL REVISION:   |        | DOCUMENT NUMBER | DOC TYPE   DOC PART   REVISION   |
|                    |  |       | DRWN: NPC 1987/07/28  |        | SDA-90327       | PSD   001   AK1  |
|                    |  |       | APPR: JDENNDHY 2004/09/16   |        |                 |  |
|                    |  |       | SHEET NUMBER  |        | 1 OF 2          |  |

REELING OPTION A

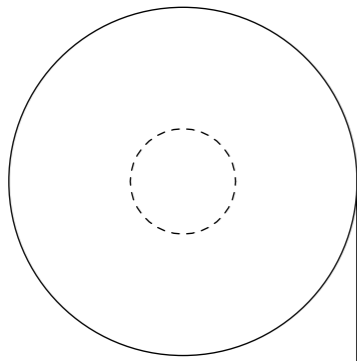

REELING OPTION B

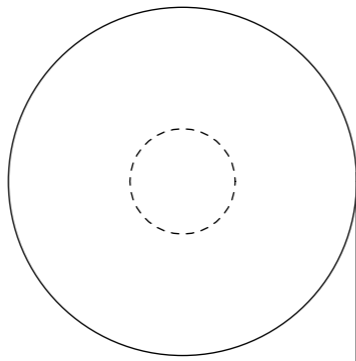

REELING OPTION C

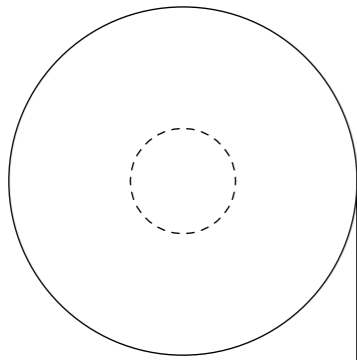

REELING OPTION D

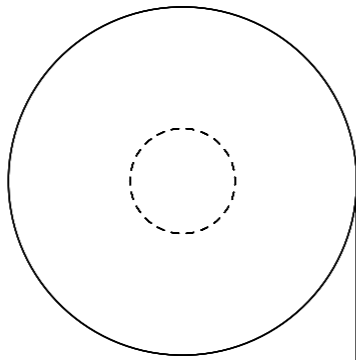

NARROW POLARISING SLOT

WIDE POLARISING SLOT

| REEL ASSY NO. | PART NO.   | CCT SIZE | REELING OPTION | REEL ASSY NO. | PART NO.   | CCT SIZE | REELING OPTION |
|---------------|------------|----------|----------------|---------------|------------|----------|----------------|
| 90327-*351    | 90327-*304 | 4        | A              | 90327-*375    | 90327-*316 | 16       | A              |
| *352          |            |          | B              | *376          |            |          | B              |
| *353          |            |          | C              | *377          |            |          | C              |
| 90327-*354    |            |          | D              | 90327-*378    |            |          | D              |
| 90327-*355    | 90327-*306 | 6        | A              | 90327-*379    | 90327-*318 | 18       | A              |
| *356          |            |          | B              | *380          |            |          | B              |
| *357          |            |          | C              | *381          |            |          | C              |
| 90327-*358    |            |          | D              | 90327-*382    |            |          | D              |
| 90327-*359    | 90327-*308 | 8        | A              | 90327-*383    | 90327-*320 | 20       | A              |
| *360          |            |          | B              | *384          |            |          | B              |
| *361          |            |          | C              | *385          |            |          | C              |
| 90327-*362    |            |          | D              | 90327-*386    |            |          | D              |
| 90327-*363    | 90327-*310 | 10       | A              | 90327-*387    | 90327-*326 | 26       | A              |
| *364          |            |          | B              | *388          |            |          | B              |
| *365          |            |          | C              | *389          |            |          | C              |
| 90327-*366    |            |          | D              | 90327-*390    |            |          | D              |
| 90327-*367    | 90327-*312 | 12       | A              | 90327-*391    | 90327-*322 | 22       | A              |
| *368          |            |          | B              | *392          |            |          | B              |
| *369          |            |          | C              | *393          |            |          | C              |
| 90327-*370    |            |          | D              | 90327-*394    |            |          | D              |
| 90327-*371    | 90327-*314 | 14       | A              | 90327-*395    | 90327-*324 | 24       | A              |
| *372          |            |          | B              | *396          |            |          | B              |
| *373          |            |          | C              | *397          |            |          | C              |
| 90327-*374    |            |          | D              | 90327-*398    |            |          | D              |

|  |   |                        |                                 |                            |                            |  |                          |
|--|---|------------------------|---------------------------------|----------------------------|----------------------------|--|--------------------------|
| FUNCTIONAL SYMBOLS                                   | THIS DRAWING CONTAINS INFORMATION THAT IS PROPRIETARY TO MOLEX ELECTRONIC TECHNOLOGIES, LLC AND SHOULD NOT BE USED WITHOUT WRITTEN PERMISSION |                        | CURRENT REV DESC: CAD MIGRATION |                            | <b>molex</b>               |  |                          |
|  | ▽A = 0  | mm                     |                                 |                            |                            |  |                          |
| DIVISIONAL SYMBOLS                                   | GENERAL TOLERANCES (UNLESS SPECIFIED)   |                        | EC NO: 738955                   |                            | IDT ASSEMBLY<br>PICOFLEX   |  |                          |
|  | ▽E = 0  | ANGULAR TOL ± 2.0°     |                                 | DRWN: GOWTHP               |                            |  |                          |
| DIVISIONAL SYMBOLS                                   | 4 PLACES  | ±                      | 2023/02/02                      |                            | PRODUCT CUSTOMER DRAWING   |  |                          |
|  | 3 PLACES  | ±                      | 2023/02/16                      |                            |                            |  |                          |
|  | 2 PLACES  | ± 0.10                 | 2023/02/20                      |                            | DOCUMENT NUMBER: SDA-90327 |  |                          |
|  | 1 PLACE   | ± 0.2                  | INITIAL REVISION:               |                            |                            |  |                          |
| 0 PLACES   | ±   | 1991/02/27             |                                 | MATERIAL NUMBER: SEE CHART |                            |  |                          |
| DRAFT WHERE APPLICABLE MUST REMAIN WITHIN DIMENSIONS |   | THIRD ANGLE PROJECTION |                                 |                            |                            |  | CUSTOMER: GENERAL MARKET |