

PART NO. 92301-0101  
 DWG. NO. SD-92301-147

CIRCUIT IDENTIFICATION

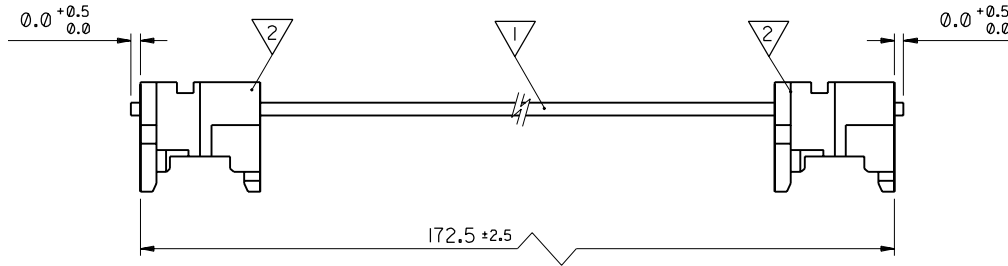
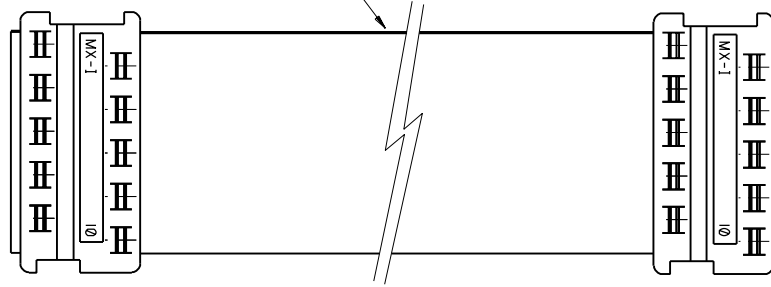

ITEM	COMPONENT	DESCRIPTION	QTY	NOTE
1	99026-0025	10 CCT 28 AWG STRANDED TINNED RIBBON CABLE	1	3, 4
2	90327-0365	PICOFLEX FEMALE IDT CONNECTOR	2	1, 2, 4

NOTES:

1. SEE PRODUCT SPECIFICATIONS PS-99020-0011.
2. SEE TERMINATION SPECIFICATION ES-99033-0001.
3. SEE CABLE SPECIFICATION ES-99027-0006.
4. HARNESES TO BE 100% ELECTRICALLY TESTED.

CUSTOMER P/N: 4357-019

ORIGINAL RELEASE  
 EC NO. 1999-0520  
 DRWN: D.RYAN 99/06/08  
 CHK: / / / /  
 APPR: / / / /  
 A2

REV	DESCRIPTION	QUALITY SYMBOLS
		MAJOR =
		CRITICAL =
		C =

GENERAL TOLERANCES: (UNLESS SPECIFIED)	
	mm INCH
4 PLACES	±0. ±.
3 PLACES	±0. ±.
2 PLACES	±0. ±.
1 PLACE	±0. ±.
ANGULAR: ± 1/2°	
DRAFT WHERE APPLICABLE MUST REMAIN WITHIN DIMENSIONS	

SCALE	DESIGN UNITS
4 : 1	<input checked="" type="checkbox"/> mm <input type="checkbox"/> INCH
DRAWN BY & DATE D.RYAN 99/03/08	
CHECKED BY & DATE J.HORGAN 99/03/08	
APPROVED BY & DATE MWILHITE 99/03/08	
CAD FILENAME S2301101.DGN	

DIMENSIONS:		SHT	REV
<input type="checkbox"/> mm	<input type="checkbox"/> INCH		
<input type="checkbox"/> mm	<input checked="" type="checkbox"/> mm ONLY		
THIRD ANGLE PROJECTION			
TITLE: 10 CCT RIBBON CABLE HARNESS			
MATERIAL NO. 92301-0101			
DRAWING NO. SD-92301-147			
SHEET NO. 1 OF 1			
THIS DRAWING CONTAINS INFORMATION THAT IS PROPRIETARY TO MOLEX INCORPORATED AND SHOULD NOT BE USED WITHOUT WRITTEN PERMISSION.			