

SIGN	DATE	DESCRIPTION	APPROVER
△	07/13`12	The dimension is added	Chen Bo
△	03/04`14	update the drawing	Chen Bo

THIS IS CAD DRAWING, DO NOT REVISE MANUALLY!!!

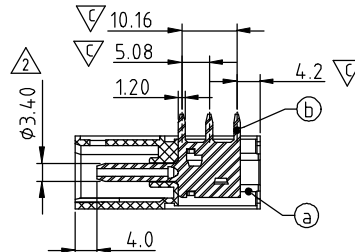
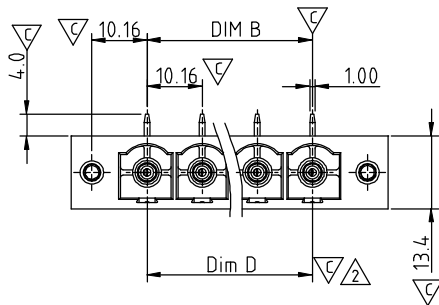
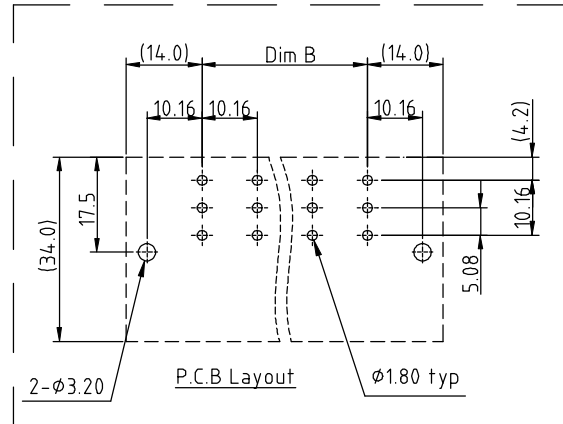
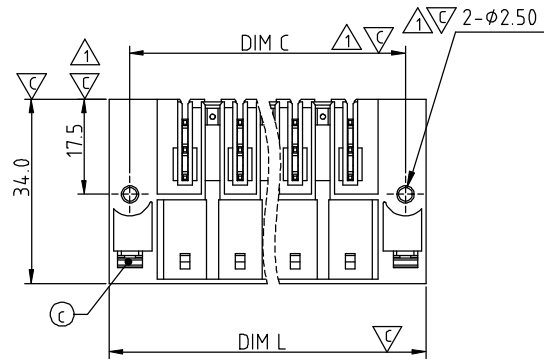

SECTION A-A

Dimension

Dim L	$(N+1) \times 10.16 + 7.6$
Dim B	$(N-1) \times 10.16$
Dim C	$(N+1) \times 10.16$
Dim D	$(N-1) \times 10.16$

N=Number of poles

POLES	TOL
2p-5p	±0.25
6p-8p	±0.35
9p-12p	±0.45

Material:

- Item a Terminal(housing): Thermoplastic,UL 94 - V0.
- Item b Male contact pin: Copper, Gold plated
- Item c With flange nut : Steel zinc plated M3

Electrical: cULus / IEC

- Voltage rating: 300V / 1000V
- Current rating: 55A / 76A
- Withstanding Voltage: 1.6 KV / 8 KV
- Operating temperature: -40°C to +115°C
- Soldering temperature: 260°C±5°C/5 Sec
- Safety Approval: cULus
- Critical dimension: ▽

△ EW xx 62 x 2 xxxx G

Solid Block	→	G	RoHS compliant (lead<4%) In copper Alloy
02 2Contacts			
03 3Contacts			
12 12Contacts			
		Color	→ 0000 Standard @ Logo 000A Standard ANY Logo Any special item by customer request, please contact sales department.
		0	Black (RAL9005)
		2	Red (RAL3001/D)
		3	Orange(RAL2011/P)
		4	Yellow(RAL1018/A)
		5	Green(RAL6018/T)
		6	Blue (RAL5015/A)
		8	Grey(RAL7035/D)
		9	White(RAL1102)
		C	Green(RAL6018/U)

ANYTEK

CUSTOMER COPY

ALL RIGHTS RESERVED. REPRODUCTION OR ISSUE TO THIRD PARTIES IN ANY FORM WHATSOEVER IS NOT PERMITTED WITHOUT WRITTEN AUTHORITY FROM THE PROPRIETOR. PROPERTY OF ANYTEK TECHNOLOGY CO., LTD

TITLE		EW 10.16 Series 2p-12p Right -Angle W/F angle (up)					
PART NO.		EWxx62x2xxxxG		DWG NO.		8EW0005	
APPROVED		CHECKED	DESIGNED	DRAWN	CUST NO.		Tolerance
		Chen Bo 03/04`14	Chen Bo 03/04`14				X. ±0.50 X.X ±0.30 X.XX ±0.10 X° ±1°
					SHEET: 01/01		UNIT: mm SCALE: NONE REV.: D