

NOTES:
 1.MATERIAL:
 HOUSING:NYLON, GLASS FILLED, UL94V-0, COLOR:BLACK OR WHITE.
 TERMINAL:PHOSPHOR BRONZE.
 METAL SHELL:PHOSPHOR BRONZE.
 2.PLATING:
 TERMINAL:
 CONTACT AREA:
 (a) GOLD FLASH.
 (b) GOLD (Au),THICKNESS=30 MICROINCH/0.76 MICROMETER.
 SOLDER TAIL:TIN(Sn),THICKNESS=100 MICROINCH MIN/2.54 MICROMETER MIN.
 UNDER PLATE:NICKEL(Ni).
 METAL SHELL:TIN (Sn),THICKNESS=100 MICROINCH MIN/2.54 MICROMETER MIN.
 UNDER PLATE:COPPER(Cu),THICKNESS=50 MICROINCH MIN/1.27 MICROMETER MIN.
 NICKEL(Ni).
 SURFACE APPEARANCE:BRIGHT.
 3.DIP PLATING FOR METAL SHELL TIN PLATED AREA.
 4.RECOMMENDED PCB THICKNESS:1.60mm or 2.00mm.
 5.PRODUCT SPECIFICATION:REFER TO PS-67579-001.
 6.PACKAGING SPECIFICATION:REFER TO PK-67579-001.
 7.TEST SUMMARY:REFER TO TS-67579-001.
 8.LEAD FREE AND ROHS COMPLIANCE PRODUCT.

HSG COLOR	DIMENSION *A*	P/N	GOLD PLATING	RECOMMENDED PCB THICKNESS
BLACK	2.00±0.15	67579-0900	GOLD FLASH	1.60 mm
		67579-0901	30 MICROINCH	
	3.10±0.10	67579-0902	GOLD FLASH	2.00 mm
		67579-0903	30 MICROINCH	
WHITE	2.00±0.15	67579-1900	GOLD FLASH	1.60 mm
		67579-1901	30 MICROINCH	
	3.10±0.10	67579-1902	GOLD FLASH	2.00 mm
		67579-1903	30 MICROINCH	

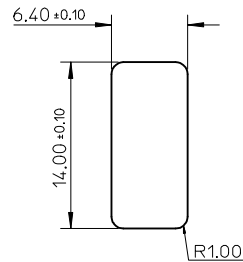

RECOMMENDED PANEL OPENING

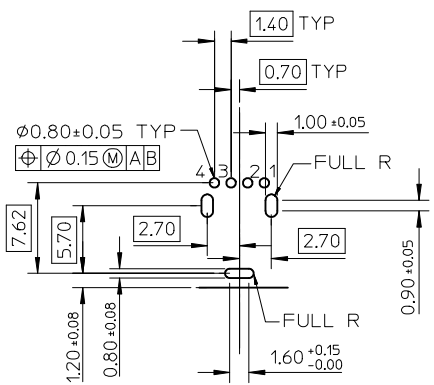

RECOMMENDED PCB LAYOUT
(TOP VIEW)

NEW RELEASE EC NO: SH2006-0313 DRWN:RTSAI CHKD: APPR:WNSCHIANG 2006/01/25 2006/01/25 2006/01/25	QUALITY SYMBOLS ▽=0 ◻=0	GENERAL TOLERANCES (UNLESS SPECIFIED)		DIMENSION STYLE MM ONLY		SCALE	DESIGN UNITS	THIRD ANGLE PROJECTION	
			mm	INCH	DRAWN BY	DATE	TITLE		
		4 PLACES	± ---	± ---	LINDA	2005/07/26	USB UP-RIGHT CONNECTOR REVERSE TYPE (LEAD-FREE VERSION)	MOLEX INCORPORATED	SHEET NO. 1 OF 1
		3 PLACES	± ---	± ---	CHECKED BY	DATE			
2 PLACES	± 0.25	± ---	ROGER TSAI	2005/07/26					
1 PLACE	± 0.25	± ---	APPROVED BY	DATE					
	ANGULAR ± 3 °		ALLEN LIN	2005/07/26	DOCUMENT NO.	SD-67579-002			
	DRAFT WHERE APPLICABLE MUST REMAIN WITHIN DIMENSIONS		SIZE	SEE TABLE			THIS DRAWING CONTAINS INFORMATION THAT IS PROPRIETARY TO MOLEX INCORPORATED AND SHOULD NOT BE USED WITHOUT WRITTEN PERMISSION		