

| HDMI AOC P/N | OVERALL LENGTH, L (m) |
|--------------|-----------------------|
| 1064134001   | 1                     |
| 1064134003   | 3                     |
| 1064134005   | 5                     |
| 1064134010   | 10                    |
| 1064134020   | 20                    |
| 1064134030   | 30                    |
| 1064134040   | 40                    |
| 1064134045   | 45                    |
| 1064134050   | 50                    |

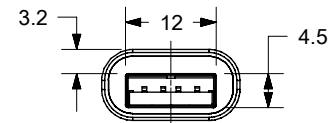
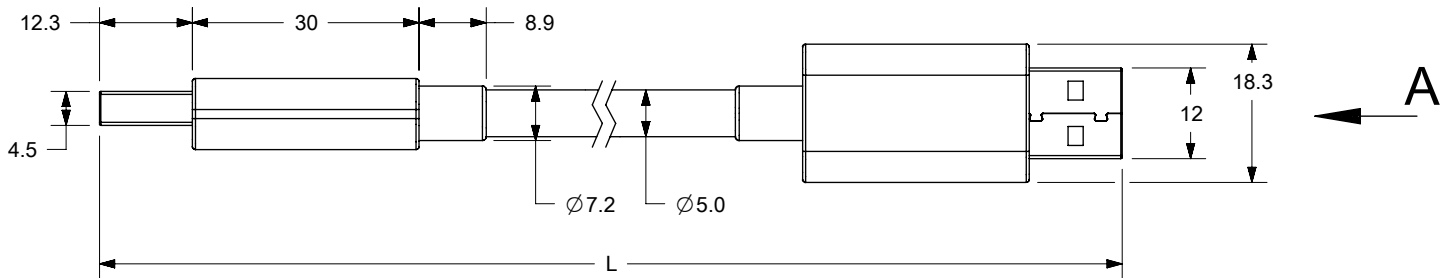

**VIEW A**  
ROTATED 90° CW

**NOTES:**

- SUPPORTS USB3.1 GEN2 (BANDWIDTH 10Gbps).  
BACKWARDS COMPATIBLE WITH USB2.0  
POWER DELIVERY: 5V / 2A (<5M), 5V1A (5M - 10M)
- MATERIAL:  
BACKSHELL - AL ALLOY, ANODIC OXIDATION, COLOR - NATURAL  
CABLE - BLACK, FIRE RETARDANT PVC, INCLUDE 5X COPPER WIRES  
AND 2X MULTIMODE FIBERS (50/125 µm, OM2),  
KEVLAR FILLS AND THE TENSION CAN REACH 100 N
- STANDARD USB TYPE-A MALE CONNECTOR.

THIS DRAWING CONTAINS INFORMATION THAT IS PROPRIETARY TO MOLEX ELECTRONIC TECHNOLOGIES, LLC AND SHOULD NOT BE USED WITHOUT WRITTEN PERMISSION

|  |                        |   |                          |                 |          |
|--|------------------------|---|--------------------------|-----------------|----------|
| DIMENSION UNITS<br><b>mm</b>                         | SCALE<br><b>1:1</b>    | CURRENT REV DESC: Obsoleted part number as per PCN#511465 | <b>molex</b>             |                 |          |
| GENERAL TOLERANCES (UNLESS SPECIFIED)                |                        | EC NO: 691224   |                          |                 |          |
| ANGULAR TOL ± °                                      |                        | DRWN: SUGEEB 2022/01/06                                   | PRODUCT CUSTOMER DRAWING |                 |          |
| 4 PLACES ±   |                        | CHK'D: GGA 2022/01/19                                     | DOCUMENT NUMBER          |                 |          |
| 3 PLACES ±   |                        | APPR: GGA 2022/01/19                                      | 1064134001               |                 |          |
| 2 PLACES ±   |                        | INITIAL REVISION:   | DOC TYPE                 | DOC PART        | REVISION |
| 1 PLACE ±  |                        | DRWN: IGUMIN 2018/04/06                                   | PSD                      | 000             | A3       |
| 0 PLACES ±   |                        | APPR: IGUMIN 2018/04/24                                   | SHEET NUMBER             |                 |          |
| DRAFT WHERE APPLICABLE MUST REMAIN WITHIN DIMENSIONS | THIRD ANGLE PROJECTION | DRAWING   | SERIES                   | MATERIAL NUMBER | CUSTOMER |
|  |                        | A-SIZE  | 106413                   | SEE TABLE       | 1 OF 1   |

|                 |    |              |            |          |
|-----------------|----|--------------|------------|----------|
| DOCUMENT STATUS | P1 | RELEASE DATE | 2022/01/19 | 08:50:10 |
|-----------------|----|--------------|------------|----------|