

**TECHNICAL SPECIFICATIONS**

**D-Sub Hood:**

Material: Zinc, Nickel Plated  
 Operating Temperature: -40°C to +120°C  
 Cable Entry: 45° Side Entry  
 Thumbscrews: UNC 4-40 (Standard)  
 Cable O.D: Up to 11,5mm (Size 9-37)  
 Up to 17mm (Size 50)

**Female D-Sub Solder Cup:**

Insulator: PBT, Black, UL94 V-0  
 Shell: Steel, Tin Plated  
 Contact pins: Copper Alloy  
 Stamped & Formed Pins: Class 3, 100 inserts min.  
 Machined Contact Pins: Class 1, 500 inserts min.  
 Contact Plating: Selective Gold over Nickel  
 Operating Temperature: -55°C to +105°C  
 Withstanding voltage: 1000V for 1 minute  
 Insulator resistance: 1000MΩ min.

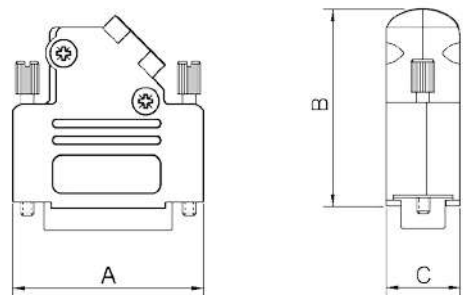

**Features:**

- Available in sizes 9-15-25-37
- Excellent EMI Shielding
- Re-openable
- Strain relief inserts ensure a secure termination

Size D45ZK	Dim A	Dim B	Dim C
9-way	31,0	36,3	14,5
15-way	39,5	40,3	14,5
25-way	53,2	40,3	14,5
37-way	69,7	40,3	14,5

**Ordering information - Black Insulator:**

Size:	P/N - Kitted:	Class 3 - 100 inserts min.
9-way	6355-0003-11	D45ZK09-DBS-K
15-way	6355-0003-12	D45ZK15-DBS-K
25-way	6355-0003-13	D45ZK25-DBS-K
37-way	6355-0003-14	D45ZK37-DBS-K
50-way	6355-0003-15	D45ZK50-DBS-K

Size:	P/N - Kitted:	Class 1 - 500 inserts min.
9-way	6355-0003-31	D45ZK09-DMS-K
15-way	6355-0003-32	D45ZK15-DMS-K
25-way	6355-0003-33	D45ZK25-DMS-K
37-way	6355-0003-34	D45ZK37-DMS-K
50-way	6355-0003-35	D45ZK50-DMS-K

**Ordering information - White Insulator:**

Size:	P/N - Kitted:	Class 3 - 100 inserts min.
9-way	6355-8003-11	D45ZK09-DBS-W-K
15-way	6355-8003-12	D45ZK15-DBS-W-K
25-way	6355-8003-13	D45ZK25-DBS-W-K
37-way	6355-8003-14	D45ZK37-DBS-W-K
50-way	6355-8003-15	D45ZK50-DBS-W-K

Size:	P/N - Kitted:	Class 1 - 500 inserts min.
9-way	6355-8003-31	D45ZK09-DMS-W-K
15-way	6355-8003-32	D45ZK15-DMS-W-K
25-way	6355-8003-33	D45ZK25-DMS-W-K
37-way	6355-8003-34	D45ZK37-DMS-W-K
50-way	6355-8003-35	D45ZK50-DMS-W-K

