

High Speed Switching Diode

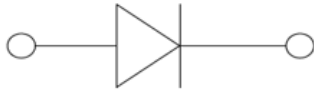

SOD323

Features

- Epoxy meets UL-94 V-0 flammability rating and halogen free
- Moisture Sensitivity Level 1
- V_R 75V
- I_{FAV} 150mA
- Part no. with suffix "Q" means AEC-Q101 qualified

Applications

- Extreme fast switches
- Automotive

Mechanical Data

- **Case:** SOD323
- **Terminals:** Tin plated leads, solderable per J-STD-002 and JESD22-B102
- **Polarity:** Cathode line denotes the cathode end
- **Marking:** T4

■ Maximum Ratings ($T_a=25^\circ\text{C}$ Unless otherwise specified)

| PARAMETER | SYMBOL | UNIT | CONDITIONS | VALUE |
|---------------------------------|------------|------------------|--------------------|-------------|
| Repetitive Peak Reverse Voltage | V_{RRM} | V | | 100 |
| Peak Forward Surge Current | I_{FSM} | A | $t_p=1\mu\text{s}$ | 2 |
| Average Forward Current | I_{FAV} | mA | | 150 |
| Power Dissipation | P_{tot} | mW | | 200 |
| Thermal Resistance | R_{thJA} | K/W | | 625 |
| Maximum Junction Temperature | T_j | $^\circ\text{C}$ | | -55 to +150 |
| Storage Temperature Range | T_{stg} | $^\circ\text{C}$ | | -55 to +150 |

■ Electrical Characteristics ($T_a=25^\circ\text{C}$ Unless otherwise specified)

| PARAMETER | SYMBOL | UNIT | CONDITIONS | MIN | MAX |
|-------------------------------|----------|---------------|---|-----|-----|
| Maximum Forward Voltage | V_F | V | $I_F=10\text{mA}$ | | 1.0 |
| Maximum Reverse Current | I_R | nA | $V_R=20\text{V}$ | | 25 |
| | I_R | μA | $V_R=75\text{V}$ | | 1.0 |
| Minimum Breakdown Voltage | V_R | V | $I_R=1\mu\text{A}$ | 75 | |
| Maximum Diode Capacitance | C_D | pF | $V_R=V_F=0\text{V}$, $f=1\text{MHz}$ | | 4 |
| Maximum Reverse Recovery Time | t_{rr} | ns | $I_F=50\text{mA}$, $I_{rr}=0.1I_R$, $R_L=100\Omega$ | | 4 |



1N4148WSQ

Ordering Information (Example)

| PREFERED P/N | PACKING CODE | UNIT WEIGHT(g) | MINIMUM PACKAGE(pcs) | INNER BOX QUANTITY(pcs) | OUTER CARTON QUANTITY(pcs) | DELIVERY MODE |
|--------------|--------------|-------------------|----------------------|-------------------------|----------------------------|---------------|
| 1N4148WSQ | F2 | Approximate 0.004 | 3000 | 30000 | 120000 | 7" reel |

Characteristics (Typical)

Fig.1: P_D-T_A

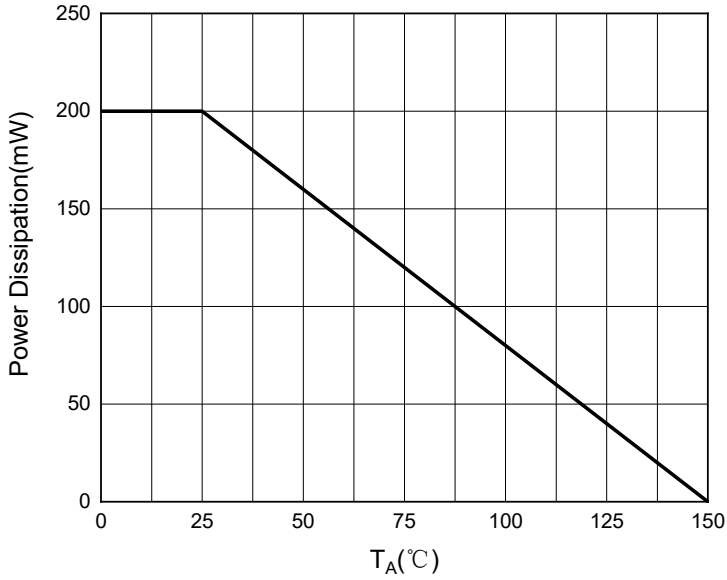

Fig.2: Capacitance Characteristics

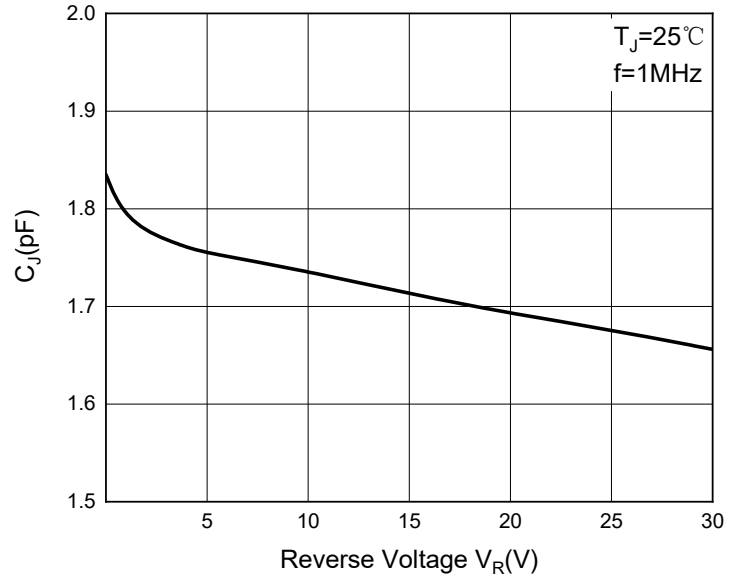

Fig.3: Forward Characteristics

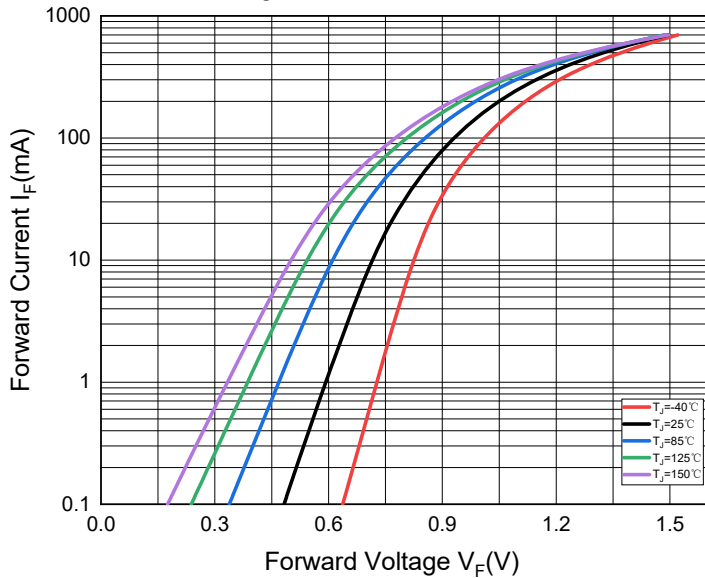
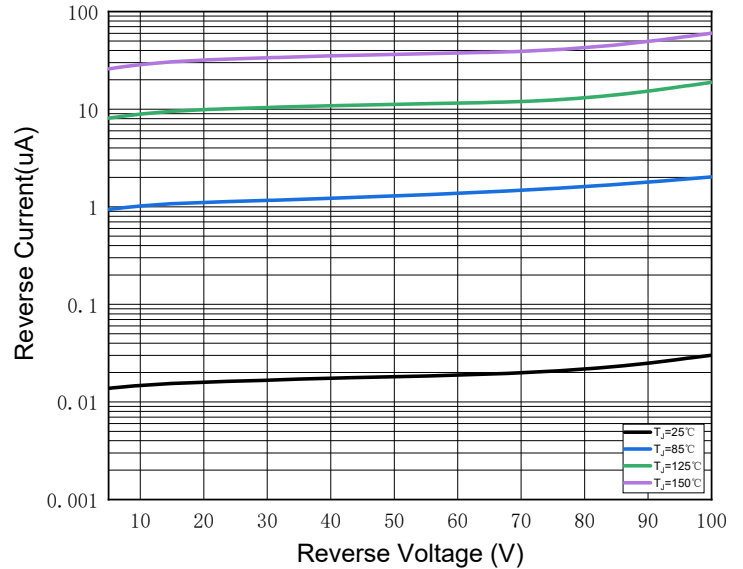

Fig.4: Reverse Characteristics





1N4148WSQ

■ Outline Dimensions

SOD-323

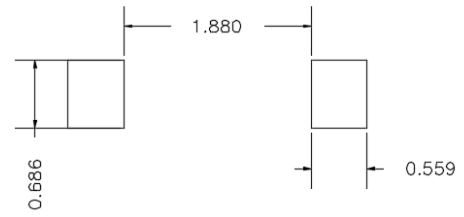
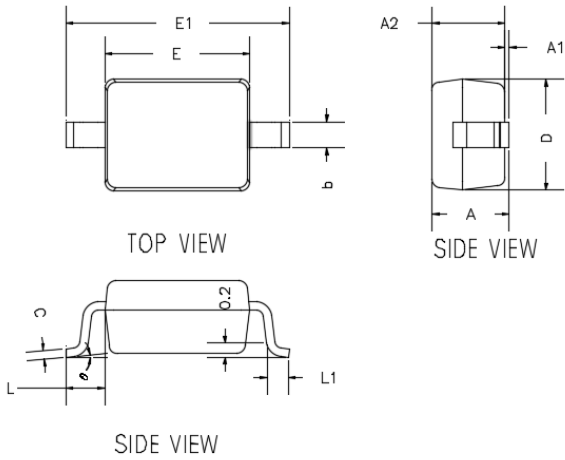

UNIT : mm

SUGGESTED SOLDER PAD LAYOUT

| DIMENSIONS | | | | |
|------------|-----------|--------|----------|--------|
| DIM | INCHES | | MM | |
| | MIN | MAX | MIN | MAX |
| A | --- | 0.0393 | --- | 1.0000 |
| A1 | 0.0000 | 0.0039 | 0.0000 | 0.1000 |
| A2 | 0.0314 | 0.0354 | 0.8000 | 0.9000 |
| b | 0.0098 | 0.0157 | 0.2500 | 0.4000 |
| c | 0.0031 | 0.0059 | 0.0800 | 0.1500 |
| D | 0.0472 | 0.0551 | 1.2000 | 1.4000 |
| E | 0.0629 | 0.0709 | 1.6000 | 1.8000 |
| E1 | 0.0984 | 0.1063 | 2.5000 | 2.7000 |
| L | 0.0187TYP | | 0.475TYP | |
| L1 | 0.0098 | 0.0157 | 0.250 | 0.400 |
| θ | 0° | 8° | 0° | 8° |

■ Marking Information

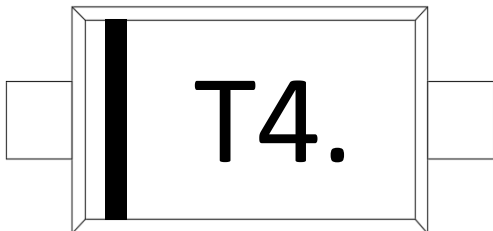

Note:

1. All marking is at middle of the product body
2. All marking is in laser marking
3. Body color: Black



1N4148WSQ

Disclaimer

The information presented in this document is for reference only. Yangzhou Yangjie Electronic Technology Co., Ltd. reserves the right to make changes without notice for the specification of the products displayed herein to improve reliability, function or design or otherwise.

The product listed herein is designed to be used with automotive electronics, are not designed for use in medical, life-saving, life-sustaining, or military, Yangjie or anyone on its behalf, assumes no responsibility or liability for any damages resulting from such improper use of sale.

This publication supersedes & replaces all information previously supplied. For additional information, please visit our website [http:// www.21yangjie.com](http://www.21yangjie.com) , or consult your nearest Yangjie's sales office for further assistance.