

## Data Sheet : 155AS HEAT SINK

### Features

- TO-220 package
- Placement pins for secure PCB attachment
- Round hole for component attachment
- Multiple available cut lengths
- RosH

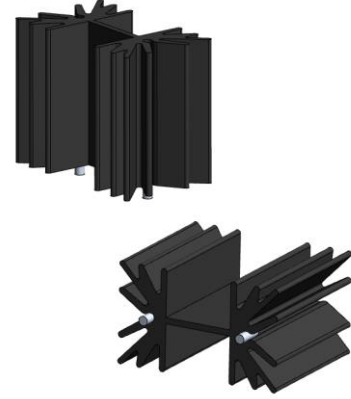

Material	: 6063 Alum. T5
Type	: Extruded
Width	: 42 mm
Height	: 25.40 mm
Length (L)	: <b>30 mm</b> 35 mm
Plate Thickness	: 1.5 mm
Surface	: Black anodized
Pin Material	: Brass

### Technical Drawing

