

LOOSE PIECE		TAPE MOUNTED		SPECIFICATIONS						
MATERIAL NUMBER	ENGINEERING NUMBER	MATERIAL NUMBER	ENGINEERING NUMBER	STUD SIZE	"S" ±.005 [0.13]	"W" ±.010 [0.25]	"C" MIN.	"L" MAX.	"H"	STOCK ±.001 [0.025] THICKNESS
---	---	---	---	10	.198 [5.03]	.534 [13.56]	.554 [14.07]	1.231 [31.27]	1.167 [29.64]	.031 [0.79]
---	---	---	---	14	.265 [6.73]					
190720048	BB-418-38	---	---	38	.390 [9.91]					
190720051	BB-418-56	---	---	56	.328 [8.33]					
---	---	---	---	413	.413 [10.49]					
---	---	---	---	2	.094 [2.39]	.250 [6.35]	.209 [5.31]	.755 [19.18]	.980 [24.89]	.031 [0.79]
---	---	---	---	4	.119 [3.02]					
190720057	BB-423-06	---	---	6	.146 [3.71]					
---	---	---	---	8	.173 [4.39]					
---	---	---	---	10	.198 [5.03]					
---	---	---	---	14	.265 [6.73]	.467 [11.86]	.388 [9.86]	1.032 [26.21]	.980 [24.89]	.031 [0.79]
---	---	---	---	56	.328 [8.33]					
---	---	---	---	4	.119 [3.02]					
---	---	190720070	BB-437-06T	6	.146 [3.71]					
---	---	---	---	8	.173 [4.39]					
190720073	BB-437-10	190720074	BB-437-10T	10	.198 [5.03]	.312 [7.92]	.285 [7.24]	.840 [21.33]	.980 [24.89]	.031 [0.79]
---	---	---	---	209	.209 [5.31]					
---	---	---	---	4	.119 [3.02]					
---	---	---	---	6	.146 [3.71]					
---	---	---	---	8	.173 [4.39]					
---	---	---	---	10	.198 [5.03]	.342 [8.69]	.310 [7.87]	.891 [22.64]	.980 [24.89]	.031 [0.79]
---	---	---	---	4	.119 [3.02]					
---	---	---	---	6	.146 [3.71]					
---	---	---	---	8	.173 [4.39]					
---	---	---	---	10	.198 [5.03]					

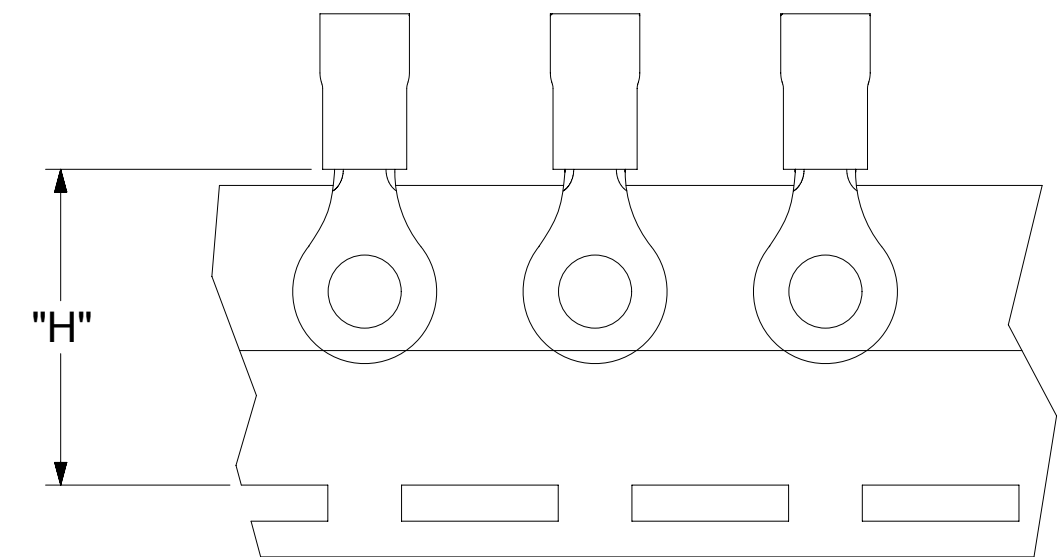
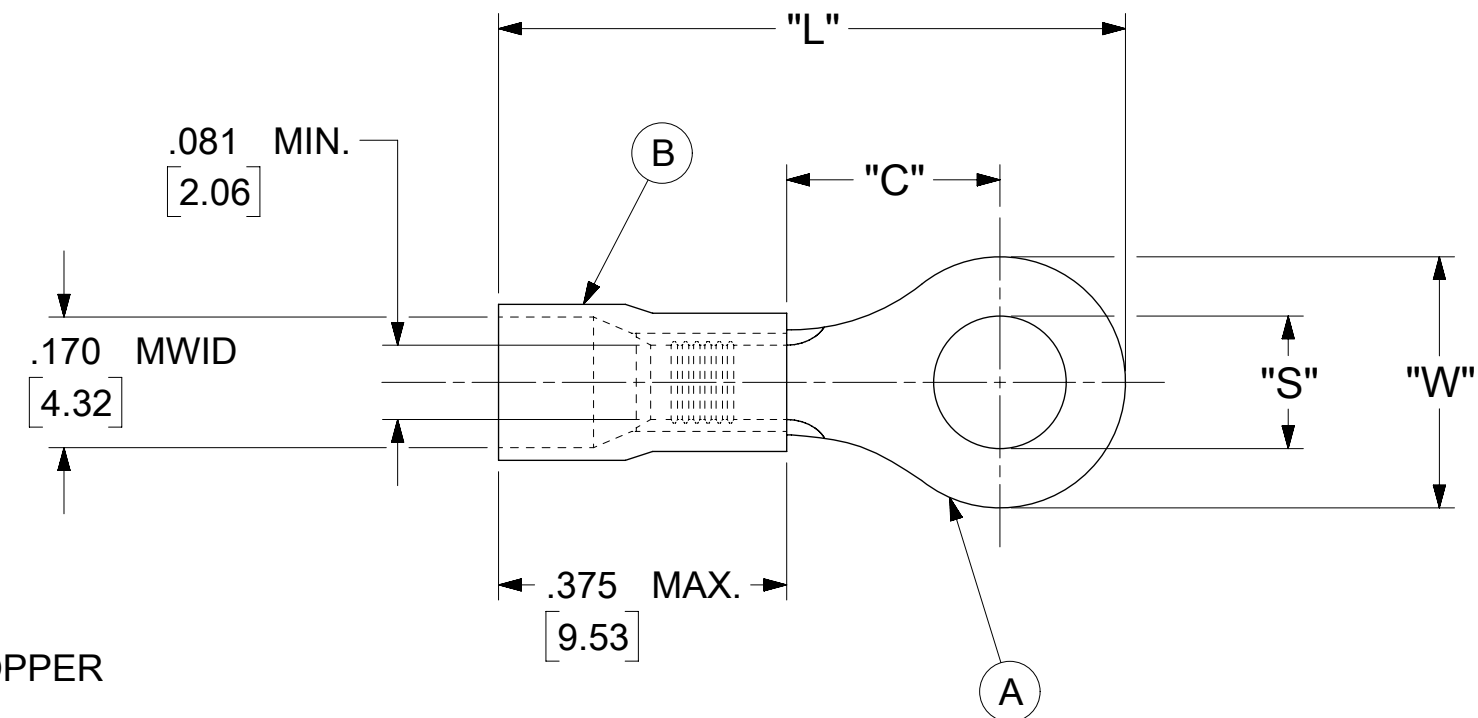

PARTS ON TAPE

- NOTES:
- MATERIAL:
    - (A). RING TONGUE TERMINAL: COPPER  
PLATING: ELECTRO-TIN (.0003 MIN.)
    - (B). TIN-PLATED BRASS FUNNEL FERRULE
  - MWID: MAXIMUM WIRE INSULATION DIAMETER
  - WIRE SIZE: 16 -14 AWG  
1.0 -2.5 MM<sup>2</sup>
  - "UL" LISTING #E32244  
"CSA" LISTING #18689
  - ALL DIMENSIONS IN INCHES/[MM].
  - PARTS ARE ROHS COMPLIANT.
  - DIMS. SHOWN ARE FOR REFERENCE ONLY.

THIS DRAWING CONTAINS INFORMATION THAT IS PROPRIETARY TO MOLEX ELECTRONIC TECHNOLOGIES, LLC AND SHOULD NOT BE USED WITHOUT WRITTEN PERMISSION										
DIMENSION UNITS <b>INCH/MM</b>		SCALE <b>NTS</b>		CURRENT REV DESC: OBSOLETE PART NUMBERS AS PER PCN#508521				<b>molex</b>		
GENERAL TOLERANCES (UNLESS SPECIFIED)				EC NO: 667388		2021/04/15				
4 PLACES ±		±		DRWN: SKANDB		2021/07/05		RING TONGUE TERMINAL VIBRAKRIMP 400-SERIES		
3 PLACES ±		± 0.005		CHK'D: GGA		2021/07/05				
2 PLACES ±		± 0.13 ± 0.01		APPR: GGA		2021/07/05		PRODUCT CUSTOMER DRAWING		
1 PLACE ±		±		INITIAL REVISION:		DOCUMENT NUMBER		DOC TYPE   DOC PART   REVISION		
0 PLACES ±		±		DRWN: JJ		1984/11/21		190720046		
ANGULAR TOL ± °		°		APPR: JMACNEIL		2019/07/10		PSD 000 A1		
DRAFT WHERE APPLICABLE MUST REMAIN WITHIN DIMENSIONS			THIRD ANGLE PROJECTION		DRAWING		SERIES		MATERIAL NUMBER   CUSTOMER   SHEET NUMBER	
			C-SIZE		19072		SEE TABLE		GENERAL MARKET   1 OF 1	