

**Mechanical Dimensions (mm)**

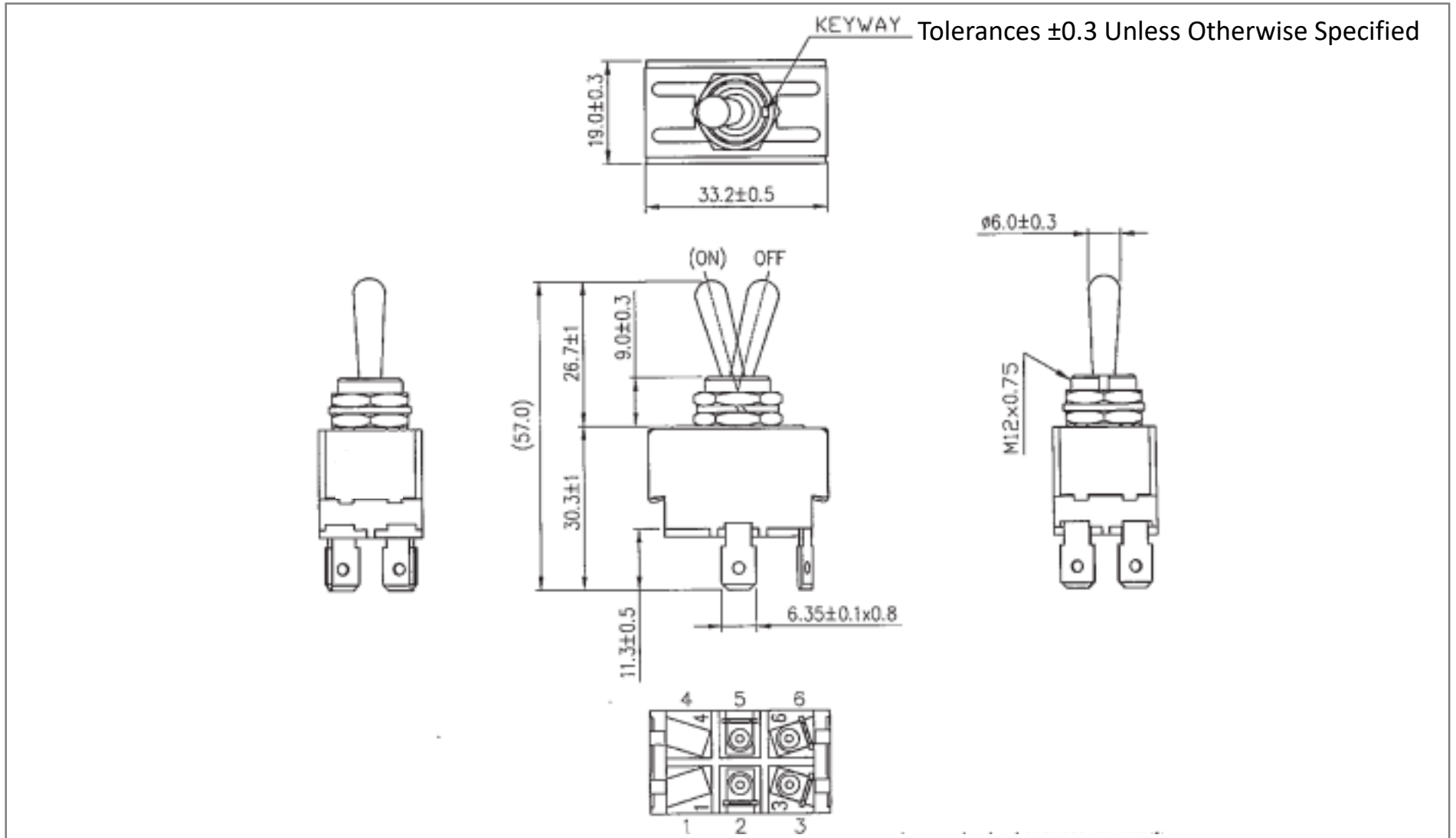

**Mounting Hole**

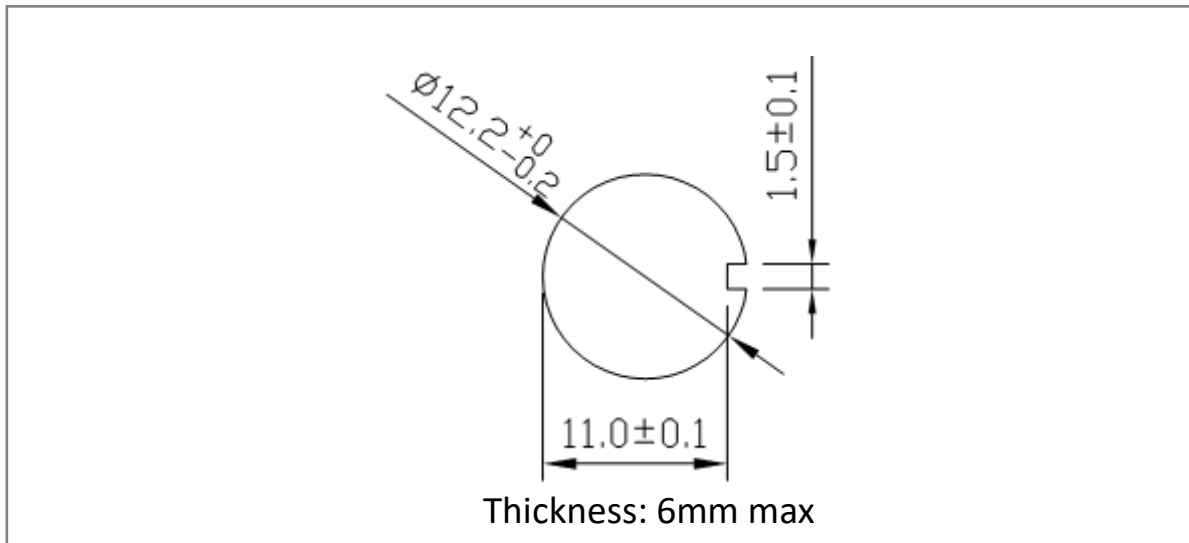

**Circuit Diagram**

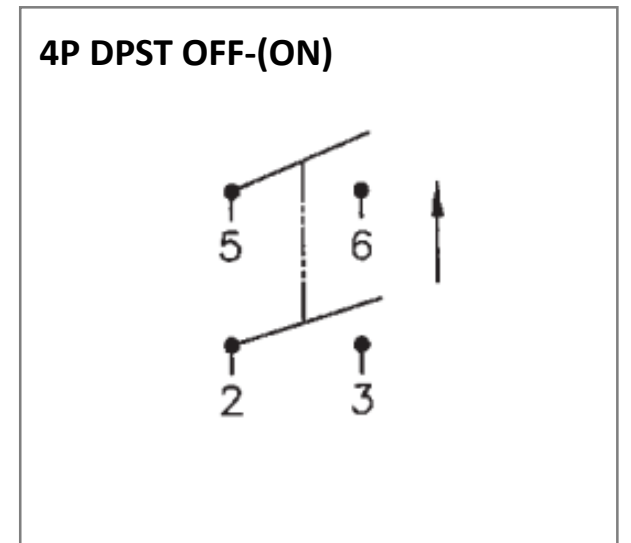

**Electrical Specifications**

<b>Rating</b>	20A 12V DC, 10A 24V DC
<b>Contact Resistance</b>	50m ohm Max.
<b>Insulation Resistance</b>	DC 500V 100M ohm Min.
<b>Dielectric Strength</b>	AC 1500V 1 minute
<b>Operation Temperature</b>	0°C~55°C