



WALL MOUNTING PLATES

Decorative Backing Plates for Room Sensors

The A/MOUNTING PLATE may be used to mount devices over a larger electrical enclosure or hole in the wall. It is made of a plastic material and contains numerous mounting holes to match most standard electrical boxes used in the industry today. It may be mounted vertically or horizontally. The colors available match ACI's standard room enclosures but will match many similar colored devices.

Applications: Space Temperature Sensing, Decorative Wall Sensor Applications, Office Buildings, Schools, Colleges, Commercial Buildings, OEM Opportunities

The A/MOUNTING PLATE is covered by ACI's Five (5) Year Limited Warranty. The warranty can be found in the front of ACI's Sensors & Transmitters catalog, as well as on ACI's website, www.workaci.com.

PRODUCT SPECIFICATIONS

Base Material:	ABS 3501
Color:	See Ordering Grid on Back of Data Sheet
Product Dimensions (All Models):	(L) 5.25" (133.43 mm) x (W) 7.00" (177.77 mm) x (H) 0.32" (8.13 mm)
Product Weight:	0.2 lbs. (0.091 Kg)
Agency Approvals:	RoHS2, WEEE





DIMENSIONAL DRAWING

**Wall Plate
(All Models)**

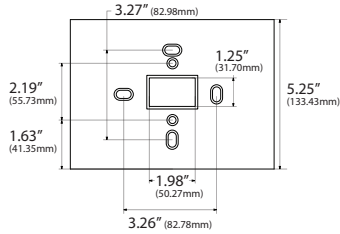

Front View



Right View

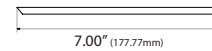

Top View

STANDARD ORDERING

Model # Example: **A/MOUNTING PLATE WHITE R** -OR- **126386**

Model #	Item #	Color	For Use With
A/MOUNTING PLATE BEIGE R	106821	Beige (9981)	ACI "R" Beige Room Enclosures, Infinity
A/MOUNTING PLATE WHITE R	126386	White (90201)	ACI "R-W" White Room Enclosures, Infinity
A/MOUNTING PLATE WHITE R2	143369	White (90198)	ACI "R2" Room Enclosures, Aries

