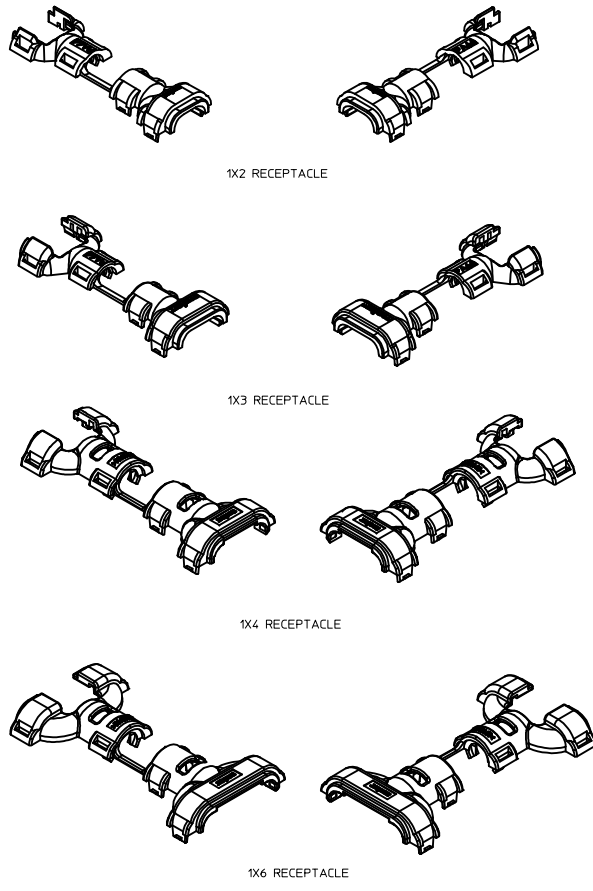

TABLE OF CONTENTS	
SHEET NO.	SHEET DESCRIPTION
1	NOTES AND BOM
2	1X2 AND 1X3 CONFIGURATIONS
3	1X4 AND 1X6 CONFIGURATIONS
4	CONVOLUTE INTERFACE/BACKSHELL DETAIL

BILL OF MATERIALS (BOM)								
DESCRIPTION	PART NUMBER	CIRCUIT SIZE	CONVOLUTE SIZE	DIRECTION TYPE	CABLE TIE ACCESS	STATUS	MATING ASSEMBLY DRAWING	
1X2 WIRE DRESS TYPE 1	160091-2010	1X2	NW 4.5	1	NO	SALEABLE	SD-34900-2001	
1X2 WIRE DRESS TYPE 2	160091-2110	1X2	NW 4.5	2	NO	SALEABLE	SD-34900-2001	
1X2 WIRE DRESS TYPE 3	160091-2210	1X2	NW 4.5	3	NO	SALEABLE	SD-34900-2001	
1X3 WIRE DRESS TYPE 1	160091-3010	1X3	NW 4.5	1	NO	SALEABLE	SD-34900-2001	
1X3 WIRE DRESS TYPE 2	160091-3110	1X3	NW 4.5	2	NO	SALEABLE	SD-34900-2001	
1X3 WIRE DRESS TYPE 3	160091-3210	1X3	NW 4.5	3	NO	SALEABLE	SD-34900-2001	
1X4 WIRE DRESS TYPE 1, CABLE TIE ACCESS	160091-4020	1X4	NW 7.5	1	YES	SALEABLE	SD-34900-6001	
1X4 WIRE DRESS TYPE 2, CABLE TIE ACCESS	160091-4120	1X4	NW 7.5	2	YES	SALEABLE	SD-34900-6001	
1X4 WIRE DRESS TYPE 3, CABLE TIE ACCESS	160091-4220	1X4	NW 7.5	3	YES	SALEABLE	SD-34900-6001	
1X6 WIRE DRESS TYPE 1, CABLE TIE ACCESS	160091-6020	1X6	NW 7.5	1	YES	SALEABLE	SD-34900-6001	
1X6 WIRE DRESS TYPE 2, CABLE TIE ACCESS	160091-6120	1X6	NW 7.5	2	YES	SALEABLE	SD-34900-6001	
1X6 WIRE DRESS TYPE 3, CABLE TIE ACCESS	160091-6220	1X6	NW 7.5	3	YES	SALEABLE	SD-34900-6001	



BACKSHELL NOTES: VALID UNLESS OTHERWISE SPECIFIED

1. GENERAL:

a. APPLICATION SPECIFICATION SEE: AS-34900-0001

- DESIGNED TO MATE WITH RECEPTACLE SEALED ASSEMBLY AS SPECIFIED IN BOM
- COMPONENTS ARE OPTIONAL AND MUST BE PURCHASED SEPERATELY
- BACKSHELL DESIGN IS OWNED BY SCHLEMMER

b. PRODUCT SPECIFICATION

- THESE PRODUCTS ARE ONE TIME USE ONLY.
- REMOVAL FORCE OF THE BACKSHELL FROM THE MOLEX CONNECTOR TO BE 110N MIN.
- REMOVAL FORCE OF SLIT CONVOLUTE FROM THE WIRE DRESS COVER TO BE 20 N MIN.
- REMOVAL FORCE OF UNSLIT CONVOLUTE FROM THE WIRE DRESS COVER TO BE 20 N MIN.

c. PACKAGING SPECIFICATION SEE PK-31302-118

d. PARTS MUST BE IN COMPLIANCE TO MOLEX CHEMICAL SUBSTANCES FOR PRODUCTS AND PACKAGING SPECIFICATION: QEHS-699000-300

e. DATA MUST BE SUBMITTED UNDER THE MOLEX PART NUMBER TO IMDS (COMPANY ID=13255)

f. FOLLOWING PRODUCTION CODES TO BE PRESENT

- DATE CODE
- MOLD CAVITY CODE
- CONVOLUTE SIZE
- MOLEX LOGO
- MATERIAL
- SUPPLIER PART NUMBER

2. DESIGN - MATERIALS:

a. PA66 0% GLASS FILLED

b. BLACK

3. DESIGN GEOMETRY:

a. THIS IS A 100% CAD GENERATED PART. THE CAD MATHEMATICAL DATA IS THE MASTER FOR THIS PART. FOR DIMENSIONAL OR ANY INFORMATION NOT SHOWN ON THIS DRAWING, ANALYZE THE CAD MODEL.

b. GEOMETRIC DIMENSIONS AND TOLERANCES PER ASME Y14.5M - 2009

c. CORNERS SHOWN AS SHARP TO BE R 0.1.

d. VISUAL DEFECTS SHALL MEET COSMETIC STANDARD PS-45499-002 (CLASS B).

e. DRAFT OF 2° PRESENT.

f. ALLOWABLE FLASH, PARTING LINES MISMATCH, EJECTOR PINS MARK, AND GATE VESTIGE TO BE +0.30 MAX PROTUSION.

ENTER DESCRIPTION EC NO. UAU2017-0495 DRAWN/PAT01 2016/10/06 CHKD: APPR:KOEKSKL 2016/12/13 REV DESCRIPTION	QUALITY SYMBOLS ▽=0 ▽=0 ▽=0		GENERAL TOLERANCES (UNLESS SPECIFIED) mm INCH 4 PLACES ±--- ±--- 3 PLACES ±--- ±--- 2 PLACES ±0.10 ±--- 1 PLACE ±0.30 ±--- 0 PLACE ±--- ±--- ANGULAR ± 3° DRAFT WHERE APPLICABLE MUST REMAIN WITHIN DIMENSIONS		DIMENSION STYLE MM ONLY DRAWN BY DATE MYANSLAMBROU 2015/05/28 CHECKED BY DATE APPROVED BY DATE VKOSHY 2016/01/04		SCALE 1.5:1 DESIGN UNITS METRIC THIRD ANGLE PROJECTION		TITLE 1.2MM RECEPTACLE WDC	
	MATERIAL NO. SEE BOM				DOCUMENT NO. SD-160091-0001		SHEET NO. 1 OF 4			
	THIS DRAWING CONTAINS INFORMATION THAT IS PROPRIETARY TO MOLEX INCORPORATED AND SHOULD NOT BE USED WITHOUT WRITTEN PERMISSION									
	moxle									

1X2 AND 1X3 CONFIGURATIONS

1X2 RECEPTACLE

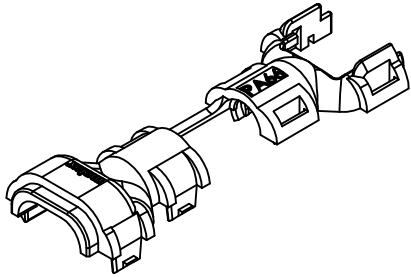

DIRECTION TYPE 1

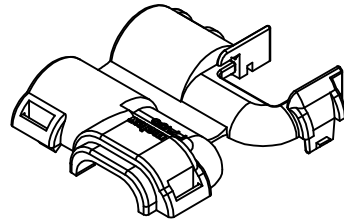

DIRECTION TYPE 2

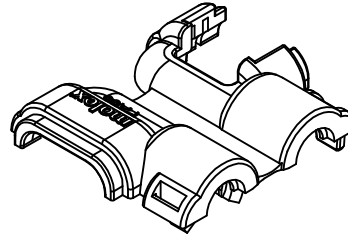

DIRECTION TYPE 3

1X3 RECEPTACLE

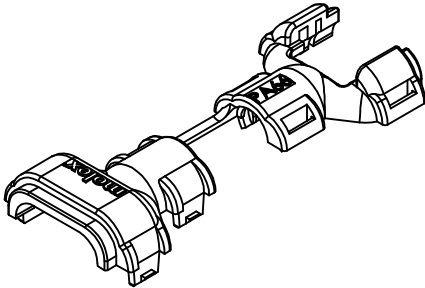

DIRECTION TYPE 1

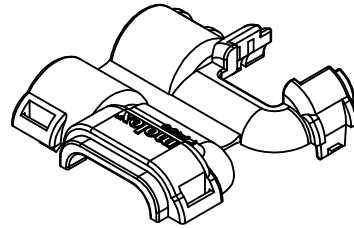

DIRECTION TYPE 2

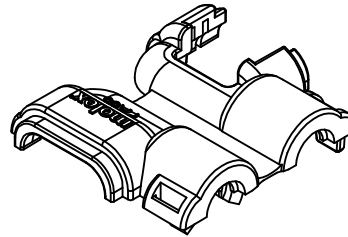

DIRECTION TYPE 3

ENTER DESCRIPTION IEC NO. UAU2017-0495 CHYD: APPR:KIEKSKL 2016/12/13 REV DESCRIPTION	QUALITY SYMBOLS ▽=0 ▽=0 ▽=0		GENERAL TOLERANCES (UNLESS SPECIFIED) mm INCH 4 PLACES #--- #--- 3 PLACES #--- #--- 2 PLACES #0.10 #--- 1 PLACE #0.30 #--- 0 PLACE #--- #--- ANGULAR ± 3 ° DRAFT WHERE APPLICABLE MUST REMAIN WITHIN DIMENSIONS		DIMENSION STYLE MM ONLY DRAWN BY DATE MYANSLAMBROU 2015/05/28 CHECKED BY DATE APPROVED BY DATE VKOSHY 2016/01/04		SCALE 3:1 DESIGN UNITS METRIC THIRD ANGLE PROJECTION		TITLE 1.2MM RECEPTACLE WDC	
	MATERIAL NO. SEE BOM			DOCUMENT NO. SD-160091-0001			SHEET NO. 2 OF 4			
	THIS DRAWING CONTAINS INFORMATION THAT IS PROPRIETARY TO MOLEX INCORPORATED AND SHOULD NOT BE USED WITHOUT WRITTEN PERMISSION									
	SIZE D									

1X4 AND 1X6 CONFIGURATIONS

1X4 RECEPTACLE

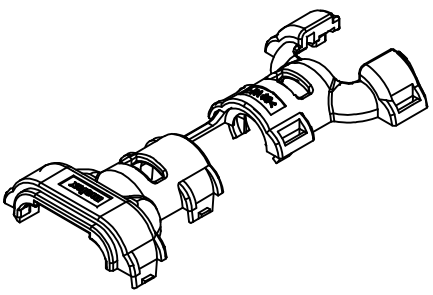

DIRECTION TYPE 1

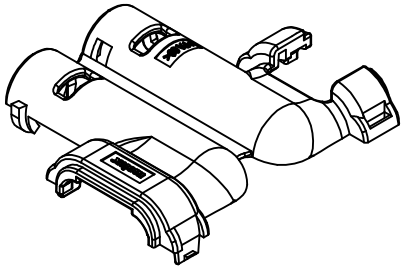

DIRECTION TYPE 2

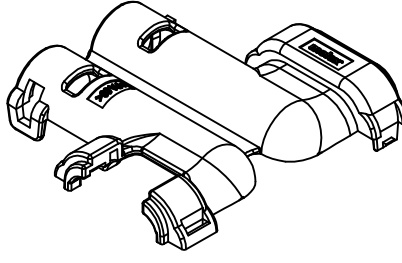

DIRECTION TYPE 3

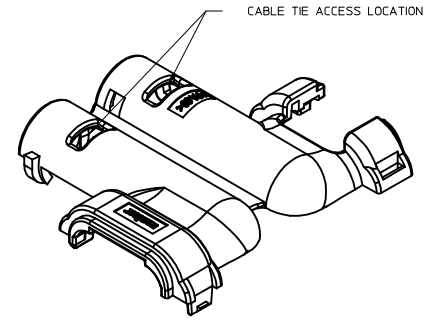

CABLE TIE ACCESS

1X6 RECEPTACLE

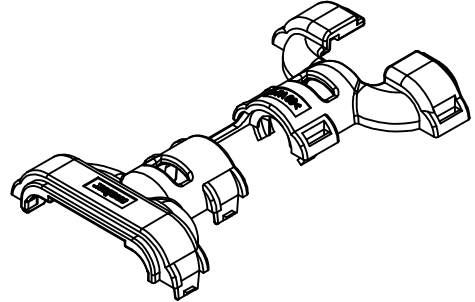

DIRECTION TYPE 1

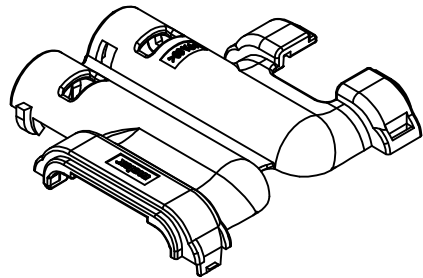

DIRECTION TYPE 2

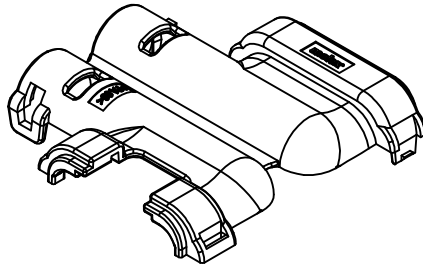

DIRECTION TYPE 3

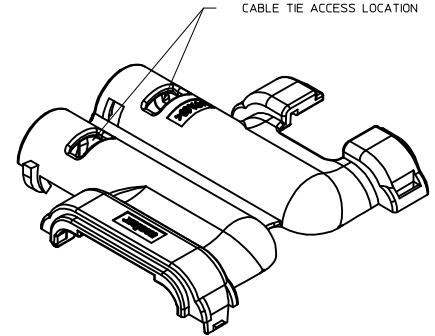

CABLE TIE ACCESS

ENTER DESCRIPTION IEC NO. UAU2017-0495 CHYD: APPR:KIEKSKL 2016/12/13	QUALITY SYMBOLS	GENERAL TOLERANCES (UNLESS SPECIFIED)	DIMENSION STYLE	SCALE	DESIGN UNITS	THIRD ANGLE PROJECTION
	▽=0	4 PLACES ± mm ± INCH	MM ONLY	2.5:1	METRIC	☉
	▽=0	3 PLACES ± 0.10 ± 0.004				
	▽=0	1 PLACE ± 0.30 ± 0.012				
	ANGULAR ± 3°	DRAFT WHERE APPLICABLE MUST REMAIN WITHIN DIMENSIONS	DRAWN BY	DATE	TITLE	
			MYANSLAMBROU	2015/05/28	1.2MM RECEPTACLE WDC	
			CHECKED BY	DATE		
			APPROVED BY	DATE		
			VKOSHY	2016/01/04		
			MATERIAL NO.	DOCUMENT NO.		
			9999999999	SD-160091-0001		
						SHEET NO.
						3 OF 4
			THIS DRAWING CONTAINS INFORMATION THAT IS PROPRIETARY TO MOLEX INCORPORATED AND SHOULD NOT BE USED WITHOUT WRITTEN PERMISSION			

CONVOLUTE INTERFACE / BACKSHELL DETAIL

DESCRIPTION	DIMENSIONS					
	A	B	C	D	F	G
1X2 WIRE DRESS OPTION 1	20.50	7.40	6.00	1.40	2.20	61.0
1X2 WIRE DRESS OPTION 2	31.45	7.40	6.00	1.40	2.20	38.0
1X2 WIRE DRESS OPTION 3	31.45	7.40	6.00	1.40	2.20	38.0
1X3 WIRE DRESS OPTION 1	24.60	7.40	6.00	1.40	2.20	61.0
1X3 WIRE DRESS OPTION 2	33.30	7.40	6.00	1.40	2.20	38.0
1X3 WIRE DRESS OPTION 3	33.30	7.40	6.00	1.40	2.20	38.0
1X4 WIRE DRESS OPTION 1	30.16	10.60	7.50	0.90	2.70	71.1
1X4 WIRE DRESS OPTION 2	49.98	10.60	7.50	0.90	2.70	54.8
1X4 WIRE DRESS OPTION 3	49.98	10.60	7.50	0.90	2.70	54.8
1X6 WIRE DRESS OPTION 1	38.16	10.60	7.50	0.90	2.70	71.1
1X6 WIRE DRESS OPTION 2	53.98	10.60	7.50	0.90	2.70	54.8
1X6 WIRE DRESS OPTION 3	53.98	10.60	7.50	0.90	2.70	54.8

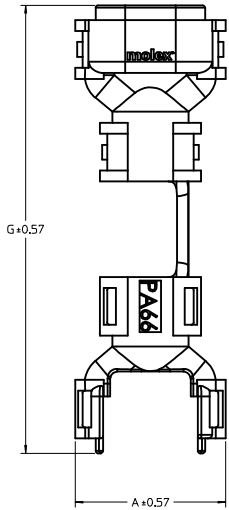

WIRE DRESS OPTION 1

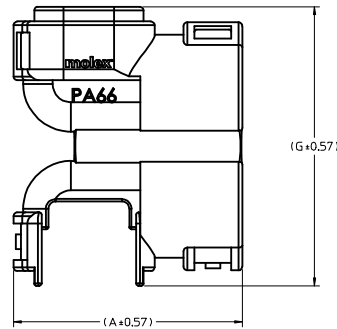

WIRE DRESS OPTION 2 AND 3

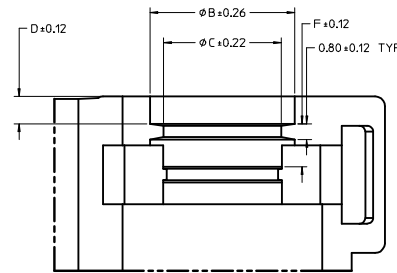
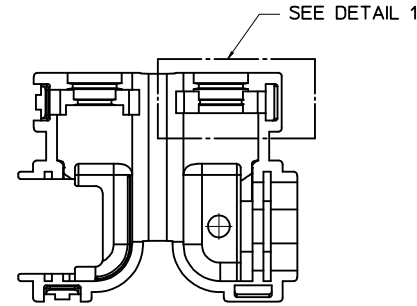

CONVOLUTE INTERFACE

DETAIL 1
SCALE 8:1

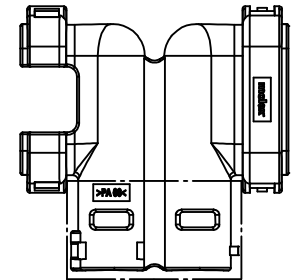

SEE DETAIL 2

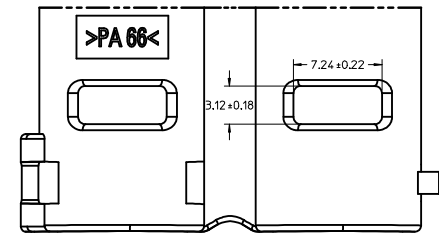

CABLE TIE ACCESS

DETAIL 2
SCALE 5:1

ENTER DESCRIPTION IEC NO. UAU2017-0495 DRAWN/PATE01 2016/10/06 CHKD: APPR:KOEKSKL 2016/10/13 REV DESCRIPTION	QUALITY SYMBOLS	GENERAL TOLERANCES (UNLESS SPECIFIED)	DIMENSION STYLE MM ONLY	SCALE 2:1	DESIGN UNITS METRIC	THIRD ANGLE PROJECTION
	▽=0	4 PLACES ± mm ± INCH	DRAWN BY DATE MYANSLAMBROU 2015/05/28	TITLE 1.2MM RECEPTACLE WDC		
	▽=0	3 PLACES ± 0.10	CHECKED BY DATE			
	▽=0	2 PLACES ± 0.30	APPROVED BY DATE VKOSHY 2016/01/04			
		0 PLACE ±				
		ANGULAR ± 3°	MATERIAL NO. SEE BOM	DOCUMENT NO. SD-160091-0001	SHEET NO. 4 OF 4	
		DRAFT WHERE APPLICABLE MUST REMAIN WITHIN DIMENSIONS	SIZE D	THIS DRAWING CONTAINS INFORMATION THAT IS PROPRIETARY TO MOLEX INCORPORATED AND SHOULD NOT BE USED WITHOUT WRITTEN PERMISSION		

TABLE OF CONTENTS	
SHEET NO.	SHEET DESCRIPTION
1	NOTES AND BOM
2	1X2 AND 1X3 CONFIGURATIONS
3	1X4 AND 1X6 CONFIGURATIONS
4	CONVOLUTE INTERFACE/BACKSHELL DETAIL

BILL OF MATERIALS (BOM)								
DESCRIPTION	PART NUMBER	CIRCUIT SIZE	CONVOLUTE SIZE	DIRECTION TYPE	CABLE TIE ACCESS	STATUS	MATING ASSEMBLY DRAWING	
1X2 WIRE DRESS TYPE 1	160091-2010	1X2	NW 4.5	1	NO	SALEABLE	SD-34900-2001	
1X2 WIRE DRESS TYPE 2	160091-2110	1X2	NW 4.5	2	NO	SALEABLE	SD-34900-2001	
1X2 WIRE DRESS TYPE 3	160091-2210	1X2	NW 4.5	3	NO	SALEABLE	SD-34900-2001	
1X3 WIRE DRESS TYPE 1	160091-3010	1X3	NW 4.5	1	NO	SALEABLE	SD-34900-2001	
1X3 WIRE DRESS TYPE 2	160091-3110	1X3	NW 4.5	2	NO	SALEABLE	SD-34900-2001	
1X3 WIRE DRESS TYPE 3	160091-3210	1X3	NW 4.5	3	NO	SALEABLE	SD-34900-2001	
1X4 WIRE DRESS TYPE 1, CABLE TIE ACCESS	160091-4020	1X4	NW 7.5	1	YES	SALEABLE	SD-34900-6001	
1X4 WIRE DRESS TYPE 2, CABLE TIE ACCESS	160091-4120	1X4	NW 7.5	2	YES	SALEABLE	SD-34900-6001	
1X4 WIRE DRESS TYPE 3, CABLE TIE ACCESS	160091-4220	1X4	NW 7.5	3	YES	SALEABLE	SD-34900-6001	
1X6 WIRE DRESS TYPE 1, CABLE TIE ACCESS	160091-6020	1X6	NW 7.5	1	YES	SALEABLE	SD-34900-6001	
1X6 WIRE DRESS TYPE 2, CABLE TIE ACCESS	160091-6120	1X6	NW 7.5	2	YES	SALEABLE	SD-34900-6001	
1X6 WIRE DRESS TYPE 3, CABLE TIE ACCESS	160091-6220	1X6	NW 7.5	3	YES	SALEABLE	SD-34900-6001	



1X2 RECEPTACLE

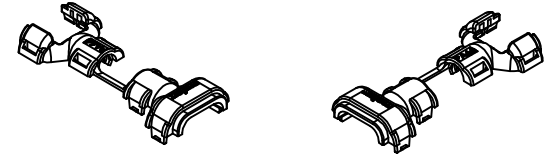

1X3 RECEPTACLE

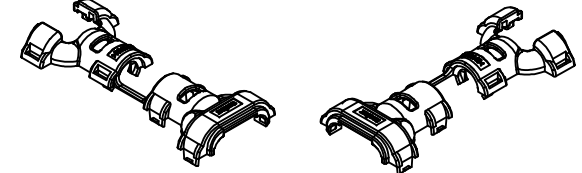

1X4 RECEPTACLE

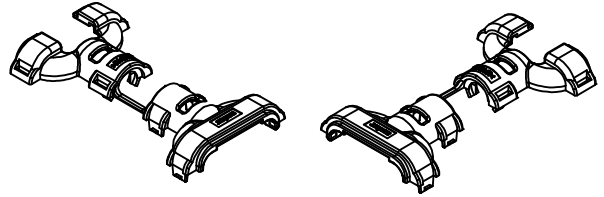

1X6 RECEPTACLE

BACKSHELL NOTES: VALID UNLESS OTHERWISE SPECIFIED

1. GENERAL:
 - a. APPLICATION SPECIFICATION SEE: AS-34900-0001
 - DESIGNED TO MATE WITH RECEPTACLE SEALED ASSEMBLY AS SPECIFIED IN BOM
 - COMPONENTS ARE OPTIONAL AND MUST BE PURCHASED SEPERATELY
 - BACKSHELL DESIGN IS OWNED BY SCHLEMMER
 - b. PRODUCT SPECIFICATION
 - THESE PRODUCTS ARE ONE TIME USE ONLY.
 - REMOVAL FORCE OF THE BACKSHELL FROM THE MOLEX CONNECTOR TO BE 110N MIN.
 - REMOVAL FORCE OF SLIT CONVOLUTE FROM THE WIRE DRESS COVER TO BE 20 N MIN.
 - REMOVAL FORCE OF UNSLIT CONVOLUTE FROM THE WIRE DRESS COVER TO BE 20 N MIN.
 - c. PACKAGING SPECIFICATION SEE PK-31302-118
 - d. PARTS MUST BE IN COMPLIANCE TO MOLEX CHEMICAL SUBSTANCES FOR PRODUCTS AND PACKAGING SPECIFICATION: QEHS-699000-300
 - e. DATA MUST BE SUBMITTED UNDER THE MOLEX PART NUMBER TO IMDS (COMPANY ID=13255)
 - f. FOLLOWING PRODUCTION CODES TO BE PRESENT
 - DATE CODE
 - MOLD CAVITY CODE
 - CONVOLUTE SIZE
 - MOLEX LOGO
 - MATERIAL
 - SUPPLIER PART NUMBER

2. DESIGN - MATERIALS:
 - a. PA66 0% GLASS FILLED
 - b. BLACK
3. DESIGN GEOMETRY:
 - a. THIS IS A 100% CAD GENERATED PART. THE CAD MATHEMATICAL DATA IS THE MASTER FOR THIS PART. FOR DIMENSIONAL OR ANY INFORMATION NOT SHOWN ON THIS DRAWING, ANALYZE THE CAD MODEL.
 - b. GEOMETRIC DIMENSIONS AND TOLERANCES PER ASME Y14.5M - 2009
 - c. CORNERS SHOWN AS SHARP TO BE R 0.1.
 - d. VISUAL DEFECTS SHALL MEET COSMETIC STANDARD PS-45499-002 (CLASS B).
 - e. DRAFT OF 2° PRESENT.
 - f. ALLOWABLE FLASH, PARTING LINES MISMATCH, EJECTOR PINS MARK, AND GATE VESTIGE TO BE +0.30 MAX PROTUSION.

B	1X4 / 1X6 COVERS MADE SALABLE
REV	DESCRIPTION
1	INITIAL RELEASE
SCALE	1.5:1
DESIGN UNITS	METRIC
THIRD ANGLE PROJECTION	
TITLE	1.2MM RECEPTACLE WDC

ENTER DESCRIPTION EC NO. UAU2017-0495 DRAWN/PAT01 2016/10/06 CHKD: APPR:KOEKSKL 2016/12/13 REV DESCRIPTION	QUALITY SYMBOLS ∇=0 ∇=0 ∇=0		GENERAL TOLERANCES (UNLESS SPECIFIED) <table border="1"> <tr> <th></th> <th>mm</th> <th>INCH</th> </tr> <tr> <td>4 PLACES</td> <td>± 0.10</td> <td>± 0.004</td> </tr> <tr> <td>3 PLACES</td> <td>± 0.15</td> <td>± 0.006</td> </tr> <tr> <td>2 PLACES</td> <td>± 0.20</td> <td>± 0.008</td> </tr> <tr> <td>1 PLACE</td> <td>± 0.30</td> <td>± 0.012</td> </tr> <tr> <td>0 PLACE</td> <td>± 0.40</td> <td>± 0.016</td> </tr> </table>			mm	INCH	4 PLACES	± 0.10	± 0.004	3 PLACES	± 0.15	± 0.006	2 PLACES	± 0.20	± 0.008	1 PLACE	± 0.30	± 0.012	0 PLACE	± 0.40	± 0.016	DIMENSION STYLE MM ONLY DRAWN BY DATE MYANSLAMBROU 2015/05/28 CHECKED BY DATE	
		mm	INCH																					
	4 PLACES	± 0.10	± 0.004																					
	3 PLACES	± 0.15	± 0.006																					
2 PLACES	± 0.20	± 0.008																						
1 PLACE	± 0.30	± 0.012																						
0 PLACE	± 0.40	± 0.016																						
DRAFT WHERE APPLICABLE MUST REMAIN WITHIN DIMENSIONS		APPROVED BY DATE VKOSHY 2016/01/04		MATERIAL NO. SEE BOM																				
ANGULAR ± 3°		SIZE D		DOCUMENT NO. SD-160091-0001																				
SHEET NO. 1 OF 4				THIS DRAWING CONTAINS INFORMATION THAT IS PROPRIETARY TO MOLEX INCORPORATED AND SHOULD NOT BE USED WITHOUT WRITTEN PERMISSION																				

1X2 AND 1X3 CONFIGURATIONS

1X2 RECEPTACLE

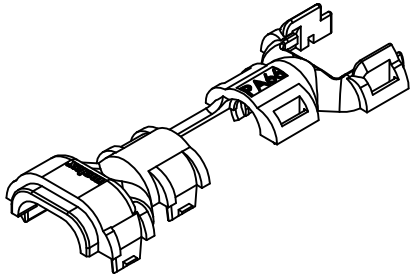

DIRECTION TYPE 1

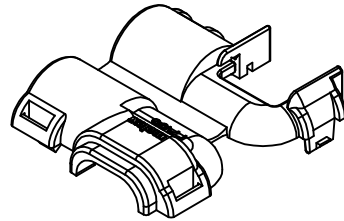

DIRECTION TYPE 2

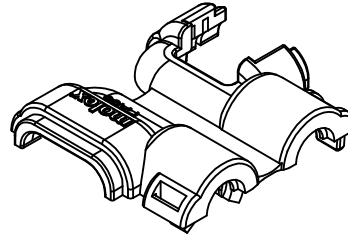

DIRECTION TYPE 3

1X3 RECEPTACLE

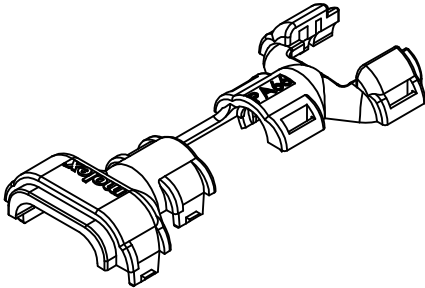

DIRECTION TYPE 1

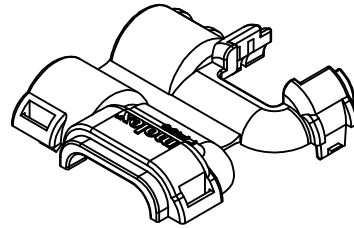

DIRECTION TYPE 2

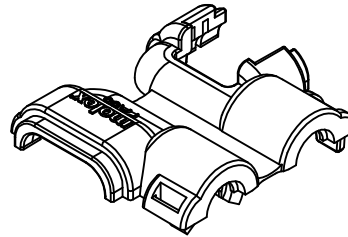

DIRECTION TYPE 3

ENTER DESCRIPTION IEC NO. UAU2017-0495 CHYD: APPR:KIEKSKL 2016/12/13 REV DESCRIPTION	QUALITY SYMBOLS ▽=0 ▽=0 ▽=0		GENERAL TOLERANCES (UNLESS SPECIFIED) mm INCH 4 PLACES #--- #--- 3 PLACES #--- #--- 2 PLACES #0.10 #--- 1 PLACE #0.30 #--- 0 PLACE #--- #--- ANGULAR ± 3 ° DRAFT WHERE APPLICABLE MUST REMAIN WITHIN DIMENSIONS		DIMENSION STYLE MM ONLY	SCALE 3:1	DESIGN UNITS METRIC	THIRD ANGLE PROJECTION
	DRAWN BY MYANSLAMBROU		DATE 2015/05/28		TITLE 1.2MM RECEPTACLE WDC			
	CHECKED BY VKOSHY		DATE 2016/01/04		MATERIAL NO. SEE BOM		DOCUMENT NO. SD-160091-0001	SHEET NO. 2 OF 4
	THIS DRAWING CONTAINS INFORMATION THAT IS PROPRIETARY TO MOLEX INCORPORATED AND SHOULD NOT BE USED WITHOUT WRITTEN PERMISSION							

20 19 18 17 16 15 14 13 12 11 10 9 8 7 6 5 4 3 2 1

1X4 AND 1X6 CONFIGURATIONS

1X4 RECEPTACLE

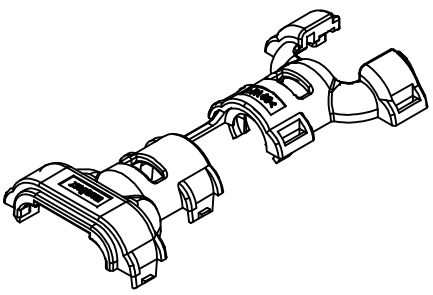

DIRECTION TYPE 1

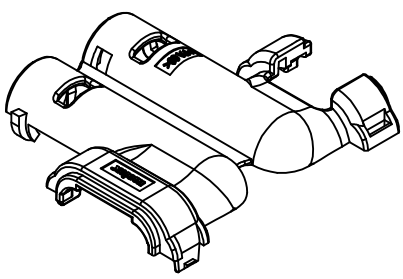

DIRECTION TYPE 2

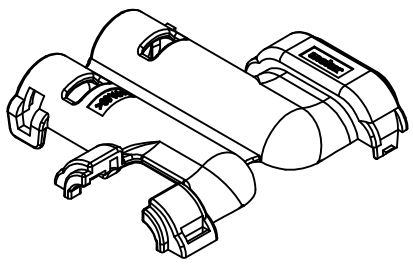

DIRECTION TYPE 3

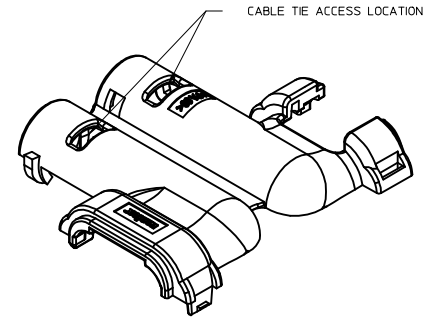

CABLE TIE ACCESS

1X6 RECEPTACLE

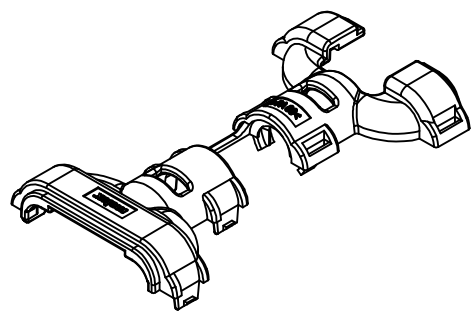

DIRECTION TYPE 1

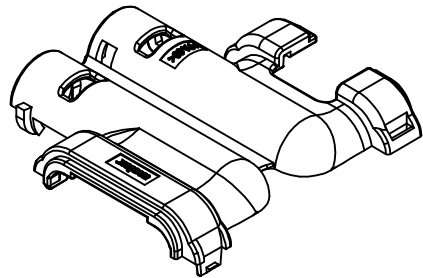

DIRECTION TYPE 2

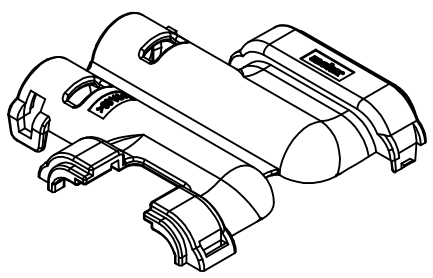

DIRECTION TYPE 3

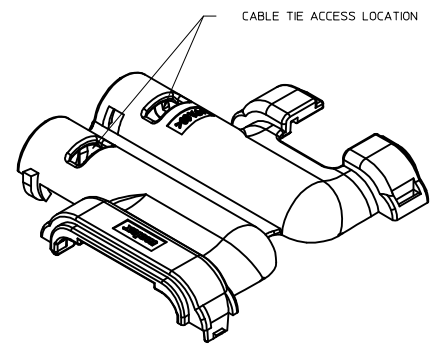

CABLE TIE ACCESS

ENTER DESCRIPTION IEC NO. UAU2017-0495 CHYD: APPR:KIEKSKL 2016/12/13	QUALITY SYMBOLS ▽=0 ▽=0 ▽=0	GENERAL TOLERANCES (UNLESS SPECIFIED) mm INCH 4 PLACES ± --- ± --- 3 PLACES ± --- ± --- 2 PLACES ± 0.10 ± --- 1 PLACE ± 0.30 ± --- 0 PLACE ± --- ± ---	DIMENSION STYLE MM ONLY	SCALE 2.5:1	DESIGN UNITS METRIC	THIRD ANGLE PROJECTION	
	DRAWN BY MYANSLAMBROU	DATE 2015/05/28	CHECKED BY DATE	TITLE 1.2MM RECEPTACLE WDC	APPROVED BY VKOSHY	DATE 2016/01/04	MATERIAL NO. 9999999999
	DRAFT WHERE APPLICABLE MUST REMAIN WITHIN DIMENSIONS	ANGULAR ± 3°	SIZE D	DOCUMENT NO. SD-160091-0001	SHEET NO. 3 OF 4	THIS DRAWING CONTAINS INFORMATION THAT IS PROPRIETARY TO MOLEX INCORPORATED AND SHOULD NOT BE USED WITHOUT WRITTEN PERMISSION	molex
	INCORPORATED AND SHOULD NOT BE USED WITHOUT WRITTEN PERMISSION						

19 18 17 16 15 14 13 12 11 10 9 8 7 6 5 4 3 2 1

CONVOLUTE INTERFACE / BACKSHELL DETAIL

DESCRIPTION	DIMENSIONS					
	A	B	C	D	F	G
1X2 WIRE DRESS OPTION 1	20.50	7.40	6.00	1.40	2.20	61.0
1X2 WIRE DRESS OPTION 2	31.45	7.40	6.00	1.40	2.20	38.0
1X2 WIRE DRESS OPTION 3	31.45	7.40	6.00	1.40	2.20	38.0
1X3 WIRE DRESS OPTION 1	24.60	7.40	6.00	1.40	2.20	61.0
1X3 WIRE DRESS OPTION 2	33.30	7.40	6.00	1.40	2.20	38.0
1X3 WIRE DRESS OPTION 3	33.30	7.40	6.00	1.40	2.20	38.0
1X4 WIRE DRESS OPTION 1	30.16	10.60	7.50	0.90	2.70	71.1
1X4 WIRE DRESS OPTION 2	49.98	10.60	7.50	0.90	2.70	54.8
1X4 WIRE DRESS OPTION 3	49.98	10.60	7.50	0.90	2.70	54.8
1X6 WIRE DRESS OPTION 1	38.16	10.60	7.50	0.90	2.70	71.1
1X6 WIRE DRESS OPTION 2	53.98	10.60	7.50	0.90	2.70	54.8
1X6 WIRE DRESS OPTION 3	53.98	10.60	7.50	0.90	2.70	54.8

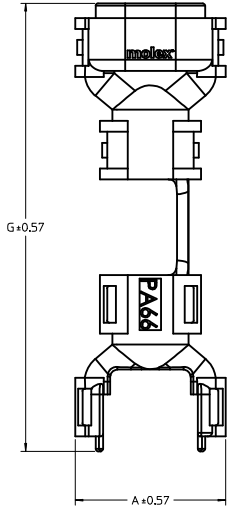

WIRE DRESS OPTION 1

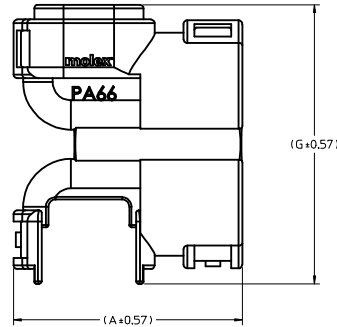

WIRE DRESS OPTION 2 AND 3

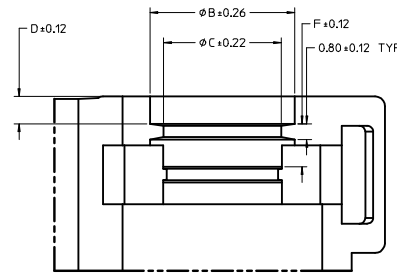
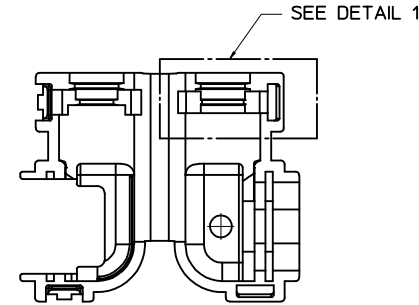

CONVOLUTE INTERFACE

DETAIL 1
SCALE 8:1

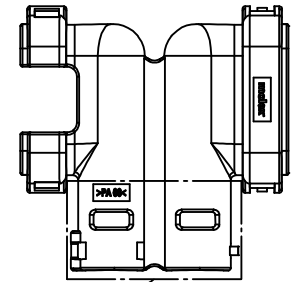

SEE DETAIL 2

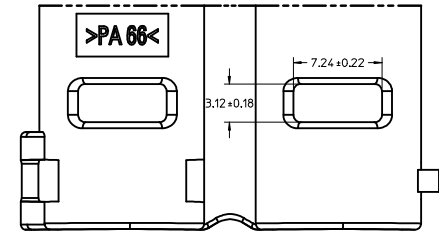

CABLE TIE ACCESS

DETAIL 2
SCALE 5:1

ENTER DESCRIPTION IEC NO. UAU2017-0495 DRAWN/PAT01 2016/10/06 CHKD: APPR:KOEKSKL 2016/10/13	QUALITY SYMBOLS	GENERAL TOLERANCES (UNLESS SPECIFIED)	DIMENSION STYLE	SCALE	DESIGN UNITS	THIRD ANGLE PROJECTION
	▽=0	4 PLACES ± mm ± INCH	MM ONLY	2:1	METRIC	☉
	▽=0	3 PLACES ± 0.10				
	▽=0	2 PLACES ± 0.30				
		ANGULAR ± 3°				
		DRAFT WHERE APPLICABLE MUST REMAIN WITHIN DIMENSIONS	MATERIAL NO.	DOCUMENT NO.		SHEET NO.
			SEE BOM	SD-160091-0001		4 OF 4
			THIS DRAWING CONTAINS INFORMATION THAT IS PROPRIETARY TO MOLEX INCORPORATED AND SHOULD NOT BE USED WITHOUT WRITTEN PERMISSION			