

HEADERS CODINGS

(CODING 2 SHOWN)

HEADER'S CODINGS FOR MODULE T2 (32W)					
COLOR	CODING	DIM. A	DIM. B	DIM. C	DIM. D
BLACK	1	9.1	4.3	5.9	4.3
GREY	2	7.5	5.9	9.1	5.9
BROWN	3	5.9	7.5	9.1	9.1
GREEN	4	7.5	9.1	4.3	4.3
BLUE	5	4.3	7.5	5.9	5.9
YELLOW	6	9.1	7.5	4.3	7.5

(CODING 3 SHOWN)

HEADER'S CODINGS FOR MODULE T3 (48W)					
COLOR	CODING	DIM. A	DIM. B	DIM. C	DIM. D
BLACK	1	12.9	6.3	8.5	6.3
GREY	2	10.7	8.5	12.9	8.5
BROWN	3	8.5	10.7	12.9	12.9
GREEN	4	10.7	12.9	6.3	6.3
BLUE	5	6.3	10.7	8.5	8.5
YELLOW	6	12.9	10.7	6.3	10.7

NOTE:

- 1- INTERFACE DEFINITION BASED ON NFR13-462 STANDARD.
- 2- HEADER: ELASTICITY MODULUS: 8000Mpa min. (INITIAL CONDITION BEFORE AGEING)

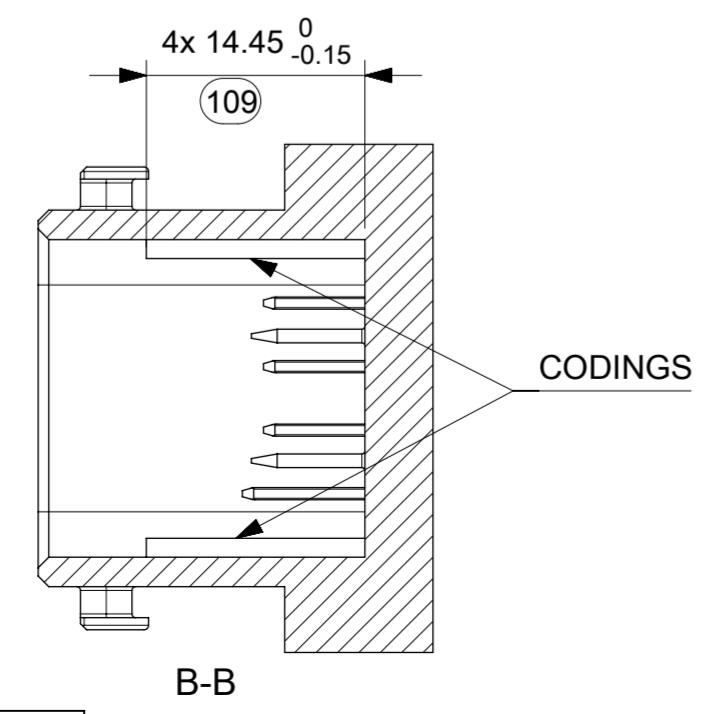

THIS DRAWING CONTAINS INFORMATION THAT IS PROPRIETARY TO MOLEX ELECTRONIC TECHNOLOGIES, LLC AND SHOULD NOT BE USED WITHOUT WRITTEN PERMISSION

DIMENSION UNITS: mm	SCALE: 2:1	CURRENT REV DESC: NX RE-MASTERING	
GENERAL TOLERANCES (UNLESS SPECIFIED)		EC NO: 603689	
ANGULAR TOL	± 2.0°	DRWN: SLAFAURE	2018/07/17
4 PLACES	± 0.10	CHK'D: OPLESSIS	2018/08/31
3 PLACES	± 0.10	APPR: SLAFAURE	2018/09/03
2 PLACES	± 0.10	INITIAL REVISION:	
1 PLACE	± 0.10	DRWN: G.DESBRUERES	2008/10/02
0 PLACES	±	APPR: OPLESSIS	2008/10/06
DRAFT WHERE APPLICABLE MUST REMAIN WITHIN DIMENSIONS	FIRST ANGLE PROJECTION	DRAWING: A2-SIZE	SERIES: 98644

32 & 48CKT CMC INTERFACE

PRODUCT CUSTOMER DRAWING

DOCUMENT NUMBER	DOC TYPE	DOC PART	REVISION
SD-98644-006	PSD	001	B1

MATERIAL NUMBER	CUSTOMER	SHEET NUMBER
N/A	GENERAL MARKET	1 OF 3

PINS 0.635 DEFINITION

5:1

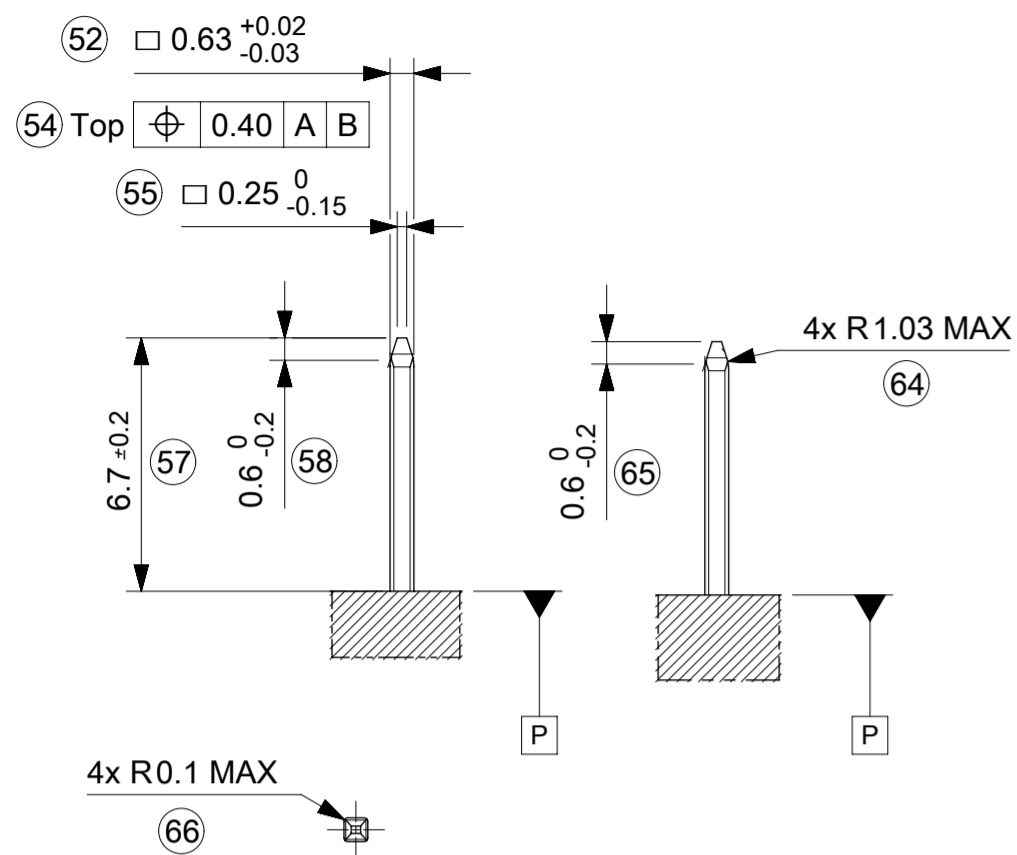

TABS 1.5 DEFINITION

5:1

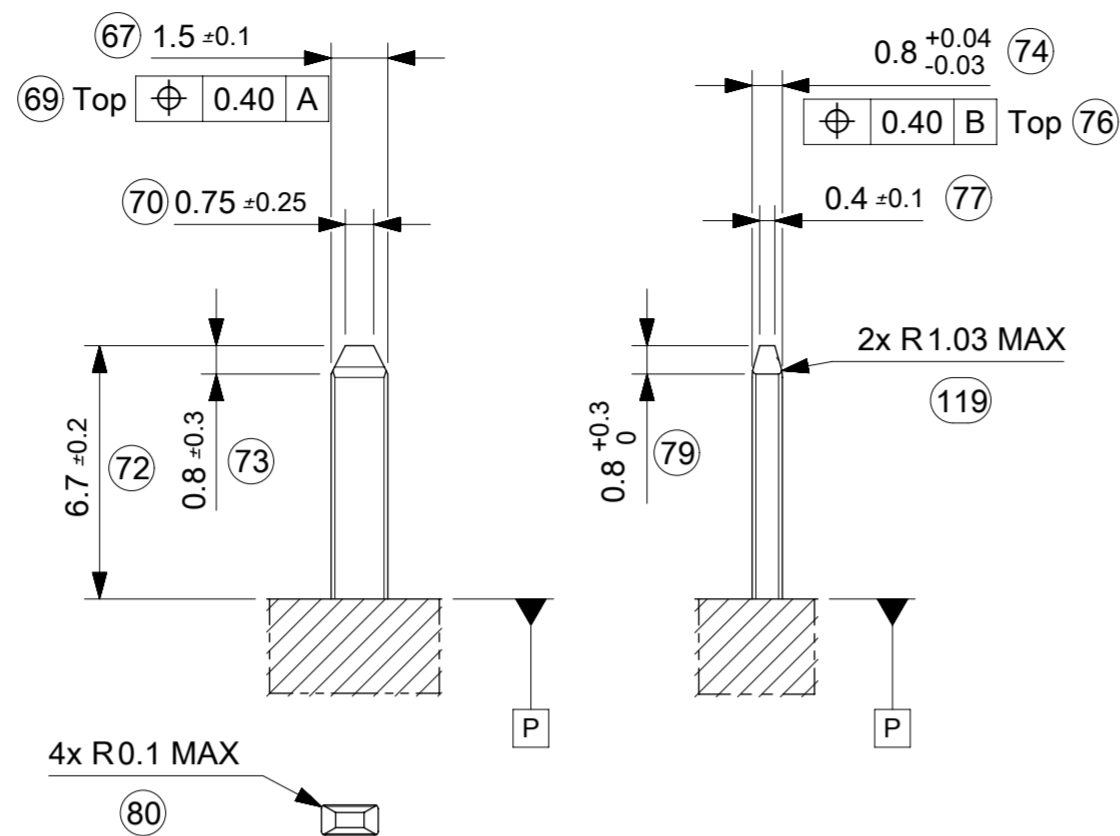

GROUND TABS 1.5 DEFINITION

5:1

FOR OTHER DIMENSIONS  
SEE TABS 1.5 DEFINITION

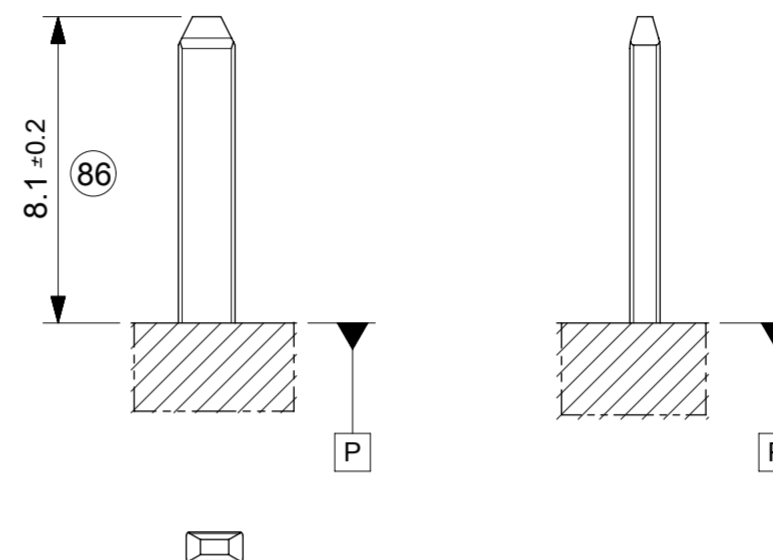

PROTECTION WALL DEFINITION

5:1

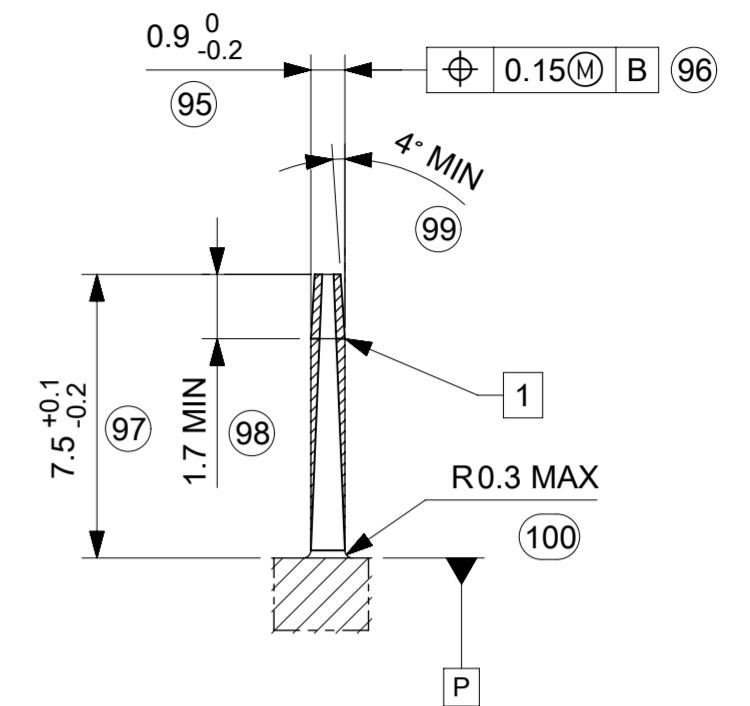

1 : SHAPES ALLOWED

LOCKING AXIS PROTECTION

5:1

MANDATORY OVERTHICKNESS: dimension noted (\*)  
IF THE LOCKING AXIS ARE OUT OF  
EQUIPMENT OVERALL DIMENSIONS.

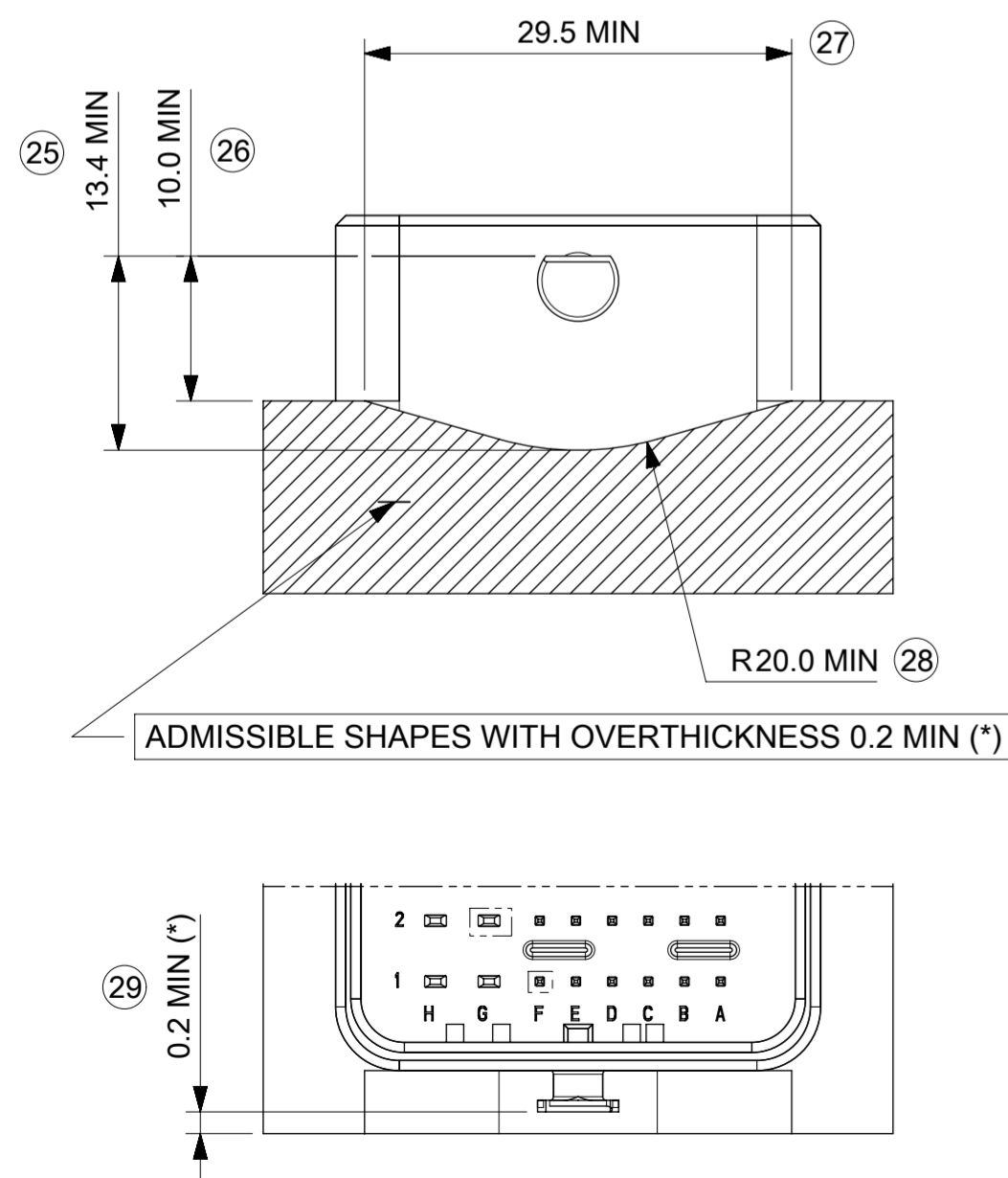

LOCKING AXIS DEFINITION

5:1

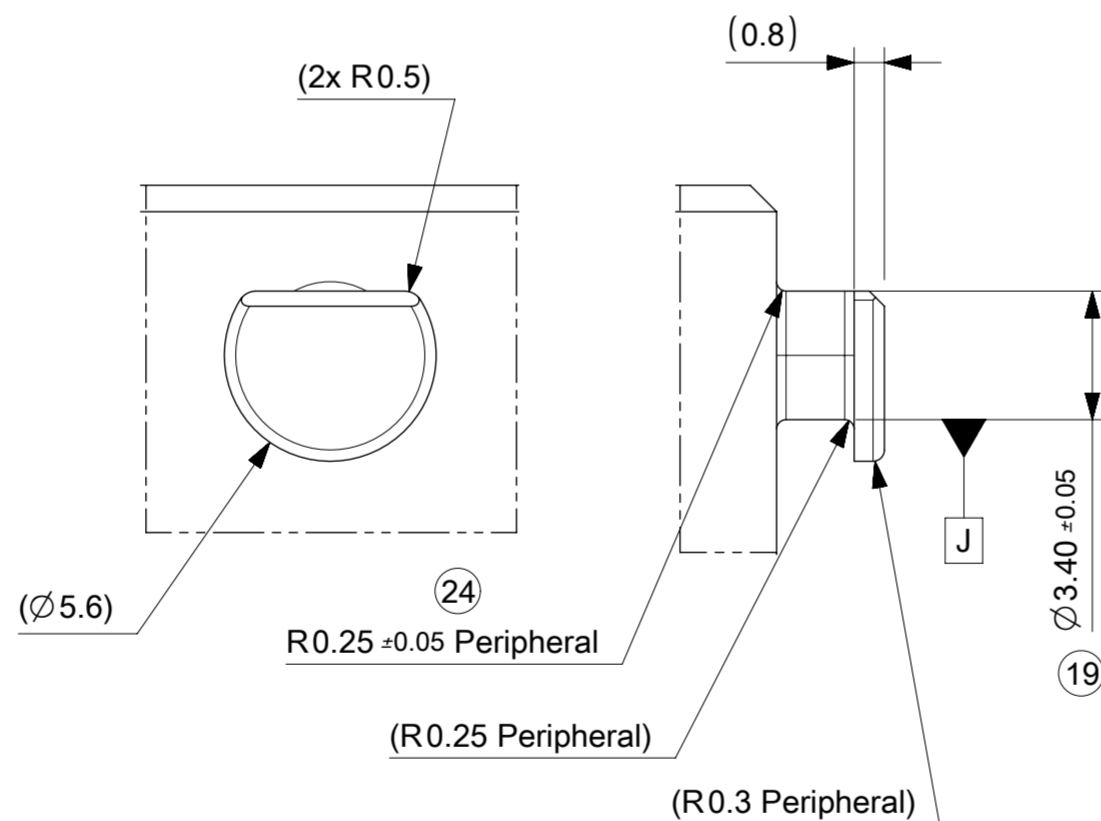

THIS DRAWING CONTAINS INFORMATION THAT IS PROPRIETARY TO MOLEX ELECTRONIC TECHNOLOGIES, LLC AND SHOULD NOT BE USED WITHOUT WRITTEN PERMISSION

DIMENSION UNITS	SCALE	CURRENT REV DESC: NX RE-MASTERING	
mm	1:1		
GENERAL TOLERANCES (UNLESS SPECIFIED)			
ANGULAR TOL	± 2.0°	EC NO: 603689	
4 PLACES	± 0.1	DRWN: GMANIVANNAN 2018/07/17	
3 PLACES	± 0.1	CHK'D: OPLESSIS 2018/08/31	
2 PLACES	± 0.1	APPR: SLAFAURE 2018/09/03	
1 PLACE	± 0.1	INITIAL REVISION:	
0 PLACES	±	DRWN: GDESBRUERES 2008/10/02	
		APPR: OPLESSIS 2008/10/06	
DRAFT WHERE APPLICABLE MUST REMAIN WITHIN DIMENSIONS	FIRST ANGLE PROJECTION	DRAWING	SERIES
		A2-SIZE	98644
DOCUMENT NUMBER		CUSTOMER	REVISION
SD-98644-006		GENERAL MARKET	001 B1
MATERIAL NUMBER		SHEET NUMBER	
N/A		2 OF 3	

**molex**

32 & 48CKT CMC INTERFACE

PRODUCT CUSTOMER DRAWING

LAYOUT FOR TWO INTERFACES T2 (32W)

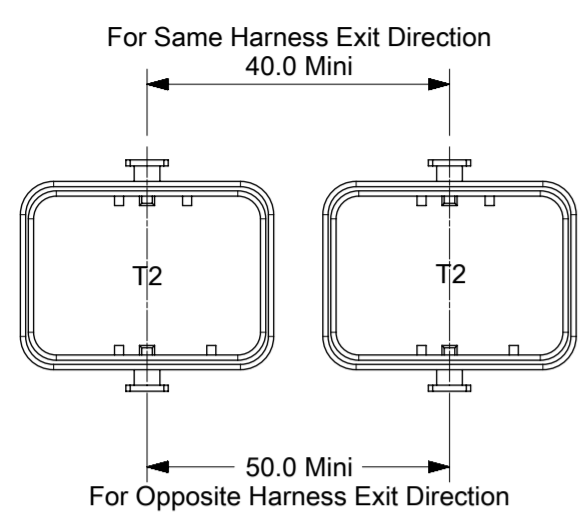

LAYOUT FOR TWO INTERFACES T2 (32W) AND T3 (48W)

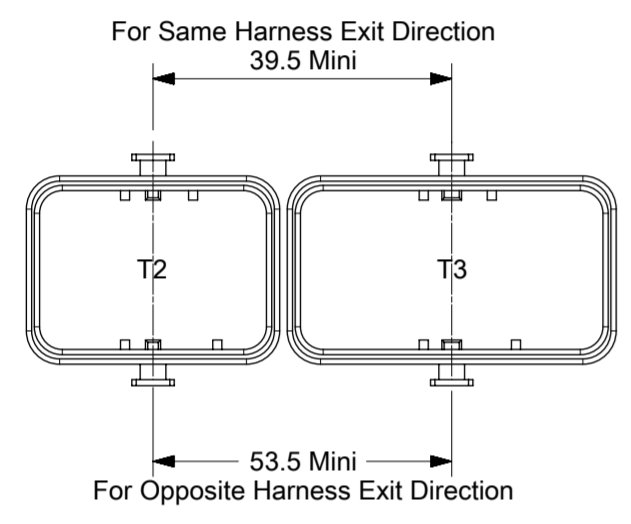

LAYOUT FOR TWO INTERFACES T3 (48W)

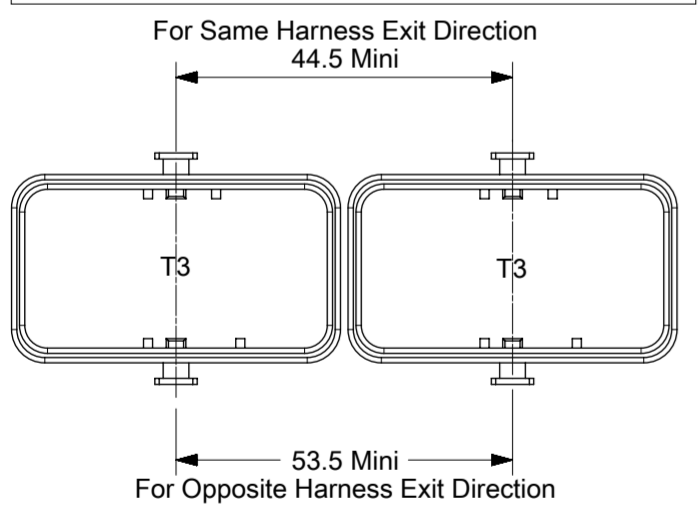

MULTI - HEADERS LAYOUT

CONNECTOR ON HEADER - OVERALL DIMENSIONS

UNLOCKED CONNECTOR - OVERALL DIMENSIONS

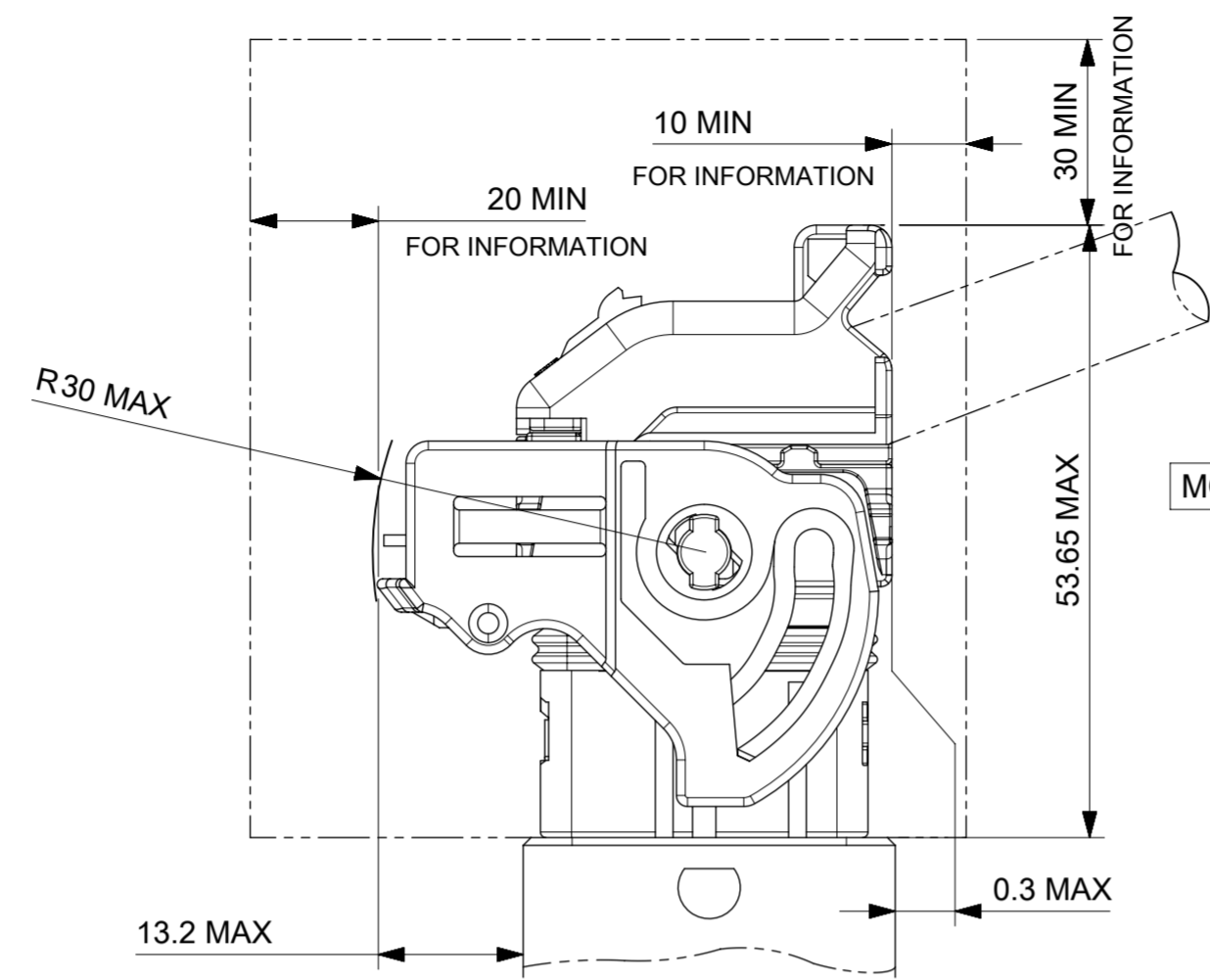

MODULE T2 (32W)

LOCKED CONNECTOR - OVERALL DIMENSIONS

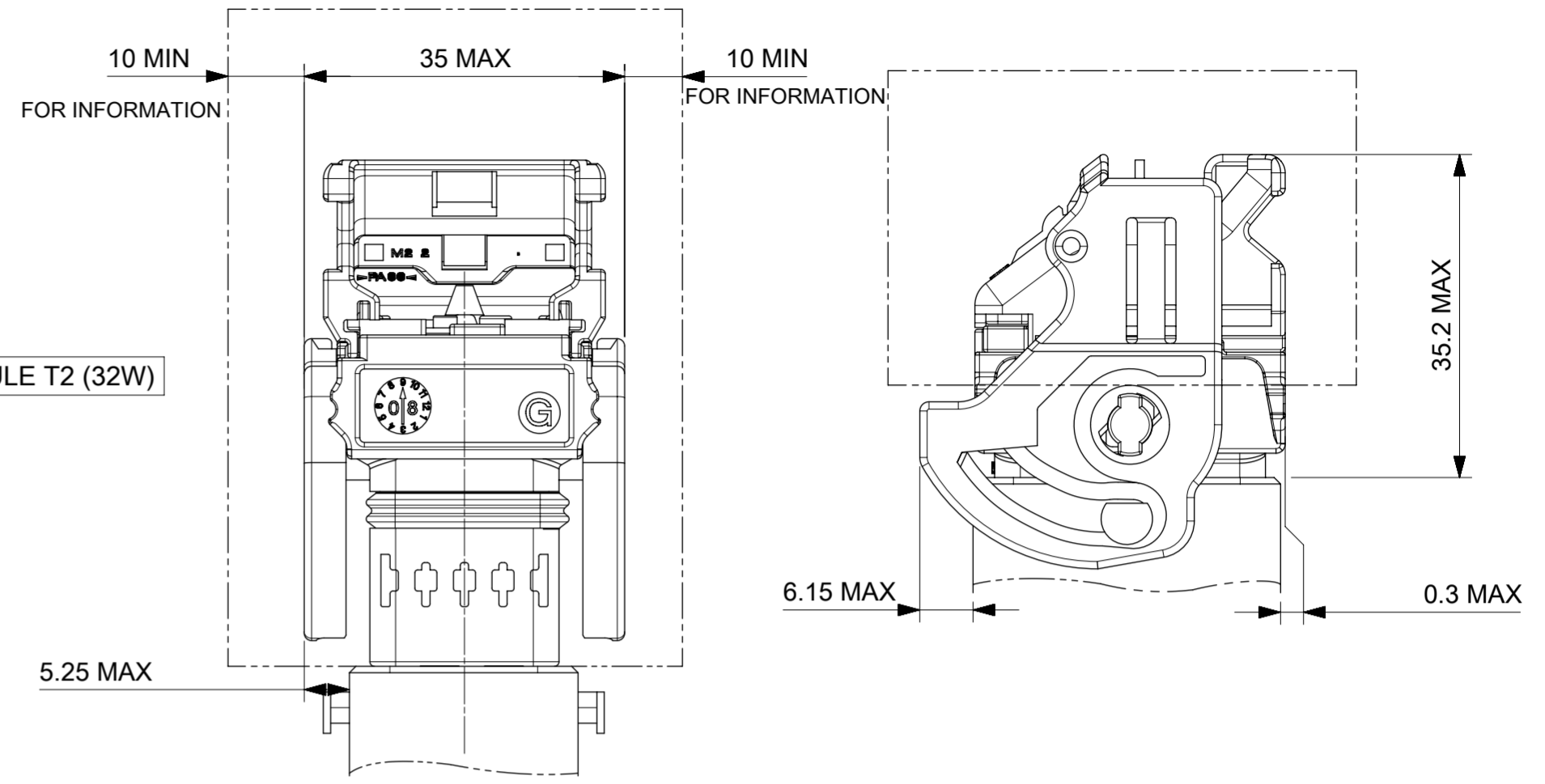

UNLOCKED CONNECTOR - OVERALL DIMENSIONS

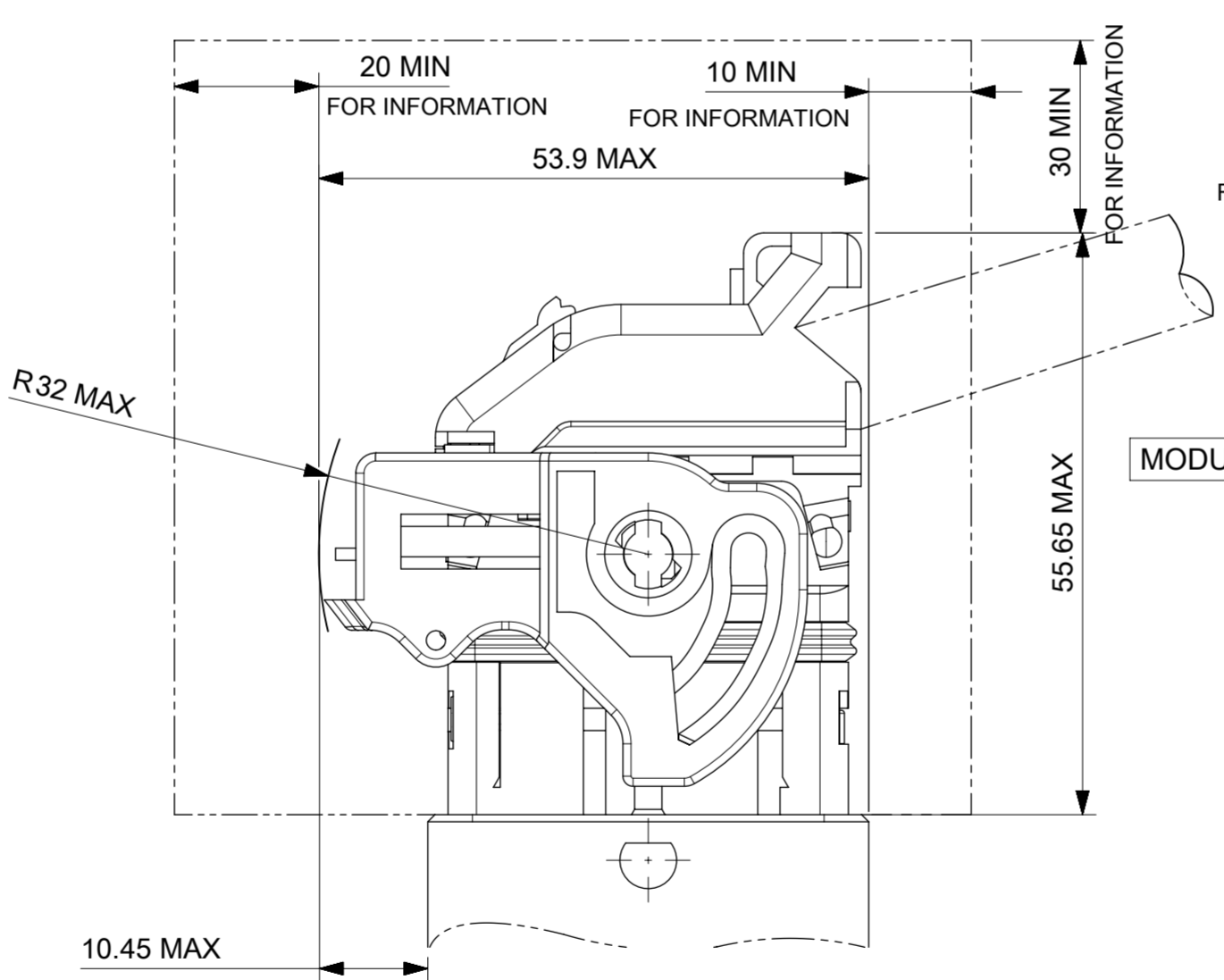

MODULE T3 (48W)

LOCKED CONNECTOR - OVERALL DIMENSIONS

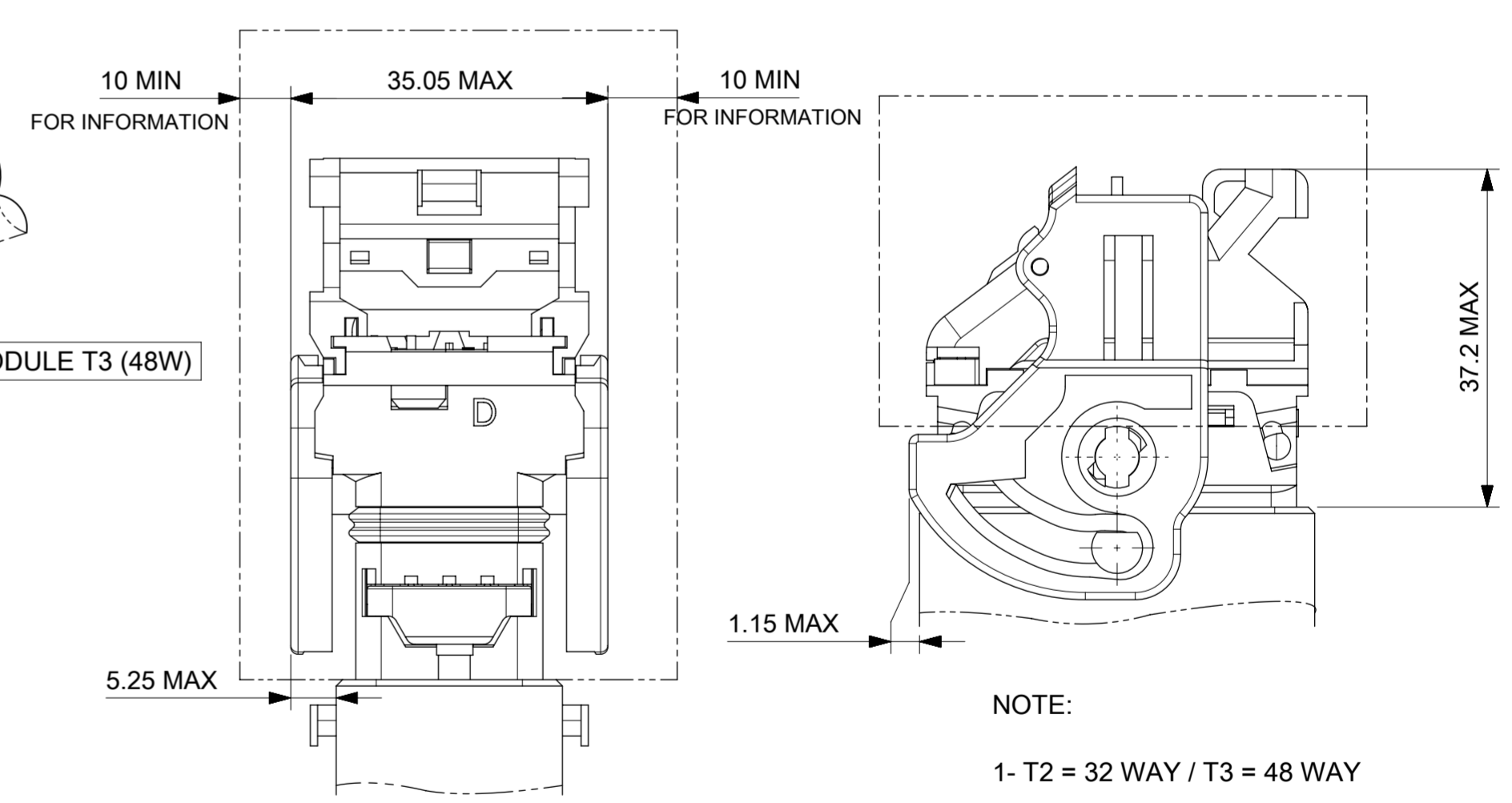

NOTE:  
1- T2 = 32 WAY / T3 = 48 WAY

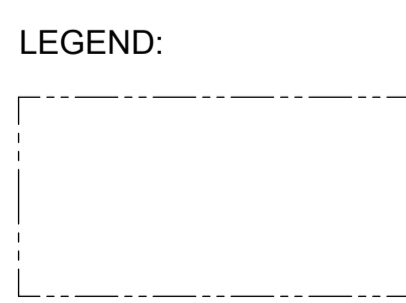

LEGEND:  
FREE VOLUME FOR MANUAL LOCKING AND UNLOCKING  
DIMENSIONS GIVEN FOR INFORMATION ONLY BE  
CONFIRMED BASED UPON VEHICLE CONFIGURATION.

THIS DRAWING CONTAINS INFORMATION THAT IS PROPRIETARY TO MOLEX ELECTRONIC TECHNOLOGIES, LLC AND SHOULD NOT BE USED WITHOUT WRITTEN PERMISSION

DIMENSION UNITS	SCALE	CURRENT REV DESC: NX RE-MASTERING	
mm	1:1		
GENERAL TOLERANCES (UNLESS SPECIFIED)			
ANGULAR TOL	± 2.0°	EC NO:	603689
4 PLACES	± 0.1	DRWN:	SLAFAURE 2018/07/17
3 PLACES	± 0.1	CHK'D:	OPLESSIS 2018/08/31
2 PLACES	± 0.1	APPR:	SLAFAURE 2018/09/03
1 PLACE	± 0.1	INITIAL REVISION:	
0 PLACES	±	DRWN:	GDESBRUERES 2008/10/02
		APPR:	OPLESSIS 2008/10/06
DRAFT WHERE APPLICABLE MUST REMAIN WITHIN DIMENSIONS	FIRST ANGLE PROJECTION	DRAWING	SERIES
		A2-SIZE	98644
DOCUMENT STATUS	P1	RELEASE DATE	2018/09/03 08:17:38
		MATERIAL NUMBER	N/A
		CUSTOMER	GENERAL MARKET
		DOCUMENT NUMBER	SD-98644-006
		DOC TYPE	PSD
		DOC PART	001
		REVISION	B1
		SHEET NUMBER	3 OF 3

NOTES :

- TERMINALS PART NUMBER: SEE SHEET 2.
- APPLICATION SPECIFICATION: RAS-98644-015.
- THE ASSEMBLED FEMALE MODULE IS ASSEMBLED WITH THE COVER PART NUMBER: 0986551003.
- PART WEIGHT: 36 g.

INK JET PRINTING

CUSTOMER DRAWING REVISION LEVEL

DAY IN YEAR/YEAR OF ASSEMBLY

MOLEX PART NUMBER

OVERALL DIMENSION

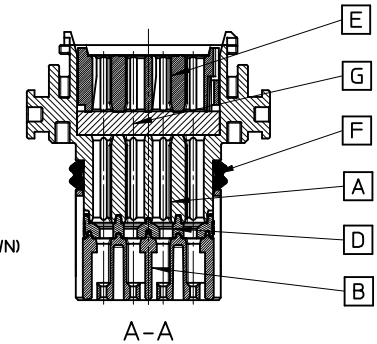
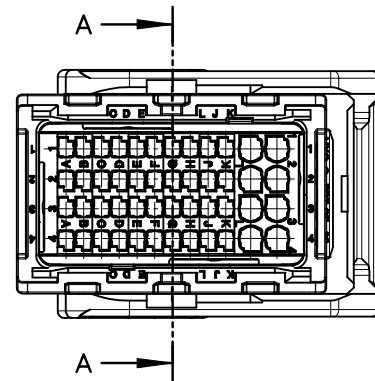
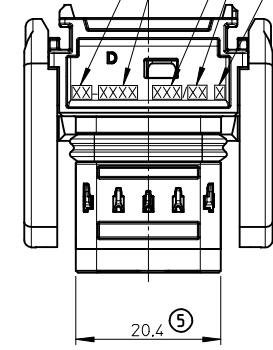
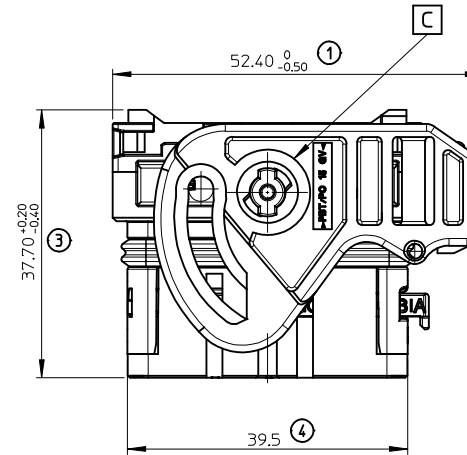
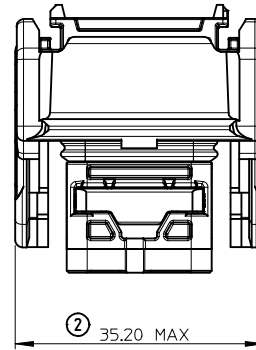
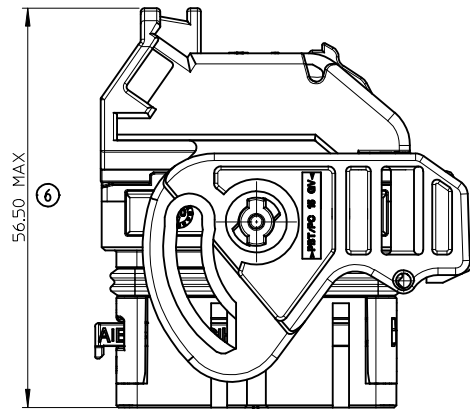

(LEVER NOT SHOWN)

LEFT	0989505003	BROWN	ON REQUEST
RIGHT	0989504003	BROWN	PRODUCTION
WIRE OUTPUT	MATERIAL NO.	CODING	PRODUCT STATUS

(A) TOP HOUSING	PBT GF20	BLACK
(B) BOTTOM HOUSING	PBT GF20	BROWN
(C) LEVER	PBT-PC GF15	GREY
(D) SECONDARY LOCKING	PBT GF30	GREEN
(E) REAR SEAL COVER	PBT GF20	BROWN
(F) PERIMETER SEAL	SILICONE	RED
(G) GEL GROMMET SEAL	SILICONE	BLUE
PART NAME	MATERIAL	COLOR

UPDATED DWG EC NO: GZ014-0045 DRAWN: VERCHERE 2013/09/20 CHKD: APPR: OPLESSIS 2013/10/04	GENERAL TOLERANCES (UNLESS SPECIFIED)		DIMENSION STYLE MM ONLY		SCALE 2:1	DESIGN UNITS METRIC	FIRST ANGLE PROJECTION
	4 PLACES	± ---	± ---	DRAWN BY PGRANDCL	DATE 01/06/25	TITLE SALES DRAWING CMC FEMALE MODULE 48 WAY	
	3 PLACES	± ---	± ---	CHECKED BY PDCHELE	DATE 01/06/25	molex	
	2 PLACES	± 0.10	± ---	APPROVED BY CBOUCHAN	DATE 01/06/25	DOCUMENT NO. SD-98950-040	SHEET NO. 1 OF 2
1 PLACE	± 0.20	± ---	MATERIAL NO. SEE CHART		THIS DRAWING CONTAINS INFORMATION THAT IS PROPRIETARY TO MOLEX INCORPORATED AND SHOULD NOT BE USED WITHOUT WRITTEN PERMISSION		
0 PLACE	± ---	± ---	ANGULAR ± 1 ° DRAFT WHERE APPLICABLE MUST REMAIN WITHIN DIMENSIONS				

# CODING

BROWN

98950-X003

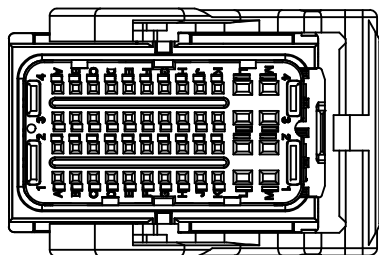

## FEMALE MODULE RIGHT WIRE OUTPUT

98950-400X  
RIGHT MARKING "D"

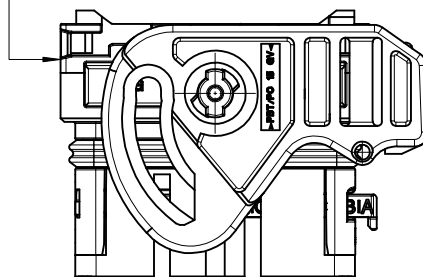

## FEMALE MODULE LEFT WIRE OUTPUT

98950-500X  
LEFT MARKING "G"

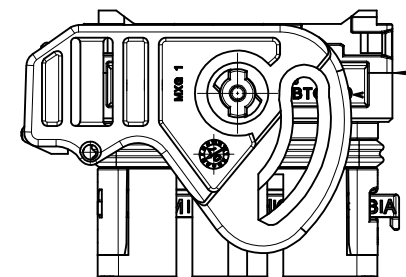

### FEMALE TERMINAL

CAVITIES NUMBER	FEMALE TERMINAL	MOLEX P/N	MIN / MAX WIRE INSULATION DIAMETER
A1 à F1 A2 à F2 A3 à F3 A4 à F4	MOX 0.64 (0.35mm2 to 0.60mm2)	0986581211	Ø1.25 min / Ø1.90 max
	MOX 0.64 (0.75mm2)	0986581212	Ø1.60 min / Ø1.90 max
G1 à G4	MOX 1.5 (0.5mm2 to 1mm2)	0981951212	Ø1.40 min / Ø2.15 max
H1 à H4	MOX 1.5 (> 1mm2 to 2mm2)	0981951213	Ø2.25 min / Ø2.65 max

REV	DESCRIPTION	GENERAL TOLERANCES (UNLESS SPECIFIED)		DIMENSION STYLE		SCALE	DESIGN UNITS	FIRST ANGLE PROJECTION
		mm	INCH	MM ONLY		METRIC		
4 PLACES	± ---	± ---	PGRANDCL	DATE	TITLE	2:1	SALES DRAWING CMC FEMALE MODULE 48 WAY	SHEET NO. 2 OF 2
3 PLACES	± ---	± ---	CHECKED BY	DATE				
2 PLACES	± 0.10	± ---	PDECHELE	01/06/25	APPROVED BY	DATE	DOCUMENT NO.	SD-98950-040
1 PLACE	± 0.20	± ---	CBOUCHAN	01/06/25				
0 PLACE	± ---	± ---	MATERIAL NO.		SEE SHEET 1		THIS DRAWING CONTAINS INFORMATION THAT IS PROPRIETARY TO MOLEX INCORPORATED AND SHOULD NOT BE USED WITHOUT WRITTEN PERMISSION	
		ANGULAR ± 1 °		DRAFT WHERE APPLICABLE MUST REMAIN WITHIN DIMENSIONS				