

REV.	ECN NO.	DATE	SIGN	DESCRIPTION
B	LEN1480590	2014-08-11	Rita	Update Logo

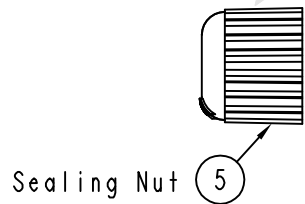

Sealing Nut (5)

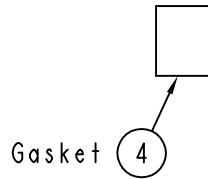

Gasket (4)

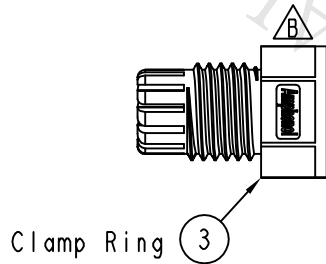

Clamp Ring (3)

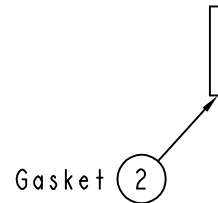

Gasket (2)

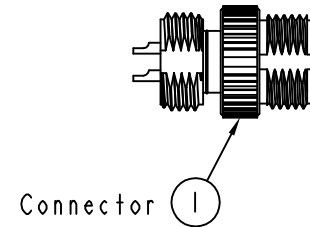

Connector (1)

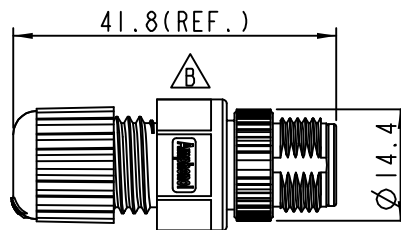

Conn.

Note:

- \* Important Dimension To Check.
- \* Waterproof Rate: IP68
- \* Housing: Black, Nylon+GF
- \* Pin: Copper Alloy, Gold Plated
- \* Nut: Zinc Alloy, Nickel Plated
- \* Gasket: Black, EPDM
- \* Clamp Ring: Black, Nylon
- \* Sealing Nut: Black, Nylon
- \* Seal: Black, EPDM
- \* Seal For Cable OD:  $\varnothing 4.5\text{mm} \sim \varnothing 6.5\text{mm}$

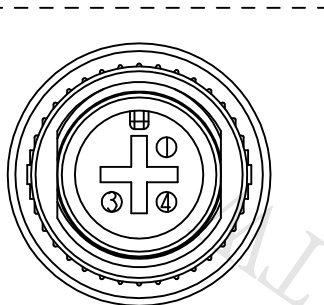

Pin Assignments  
Front View

UNIT: mm	
TOLERANCE	
.X	$\pm 0.25$
.XX	$\pm 0.1$
.XXX	$\pm 0.05$
ANGLES	$\pm 1^\circ$

TITLE M12 Conn Assy Screw 3Pin M Conn M Pin			
SCALE 1:1	SIZE A4	SHEET 1 OF 1	
REV. B	WC-REV. A.5	: Inspection item	

**Amphenol LTW**  
安費諾亮泰企業股份有限公司

ITEM NO 12-03BMMA-SL8001	DRAWN BY Rita	DATE 2014-08-11
DWG NO 12-03BMMA-SL8001	CHECKED BY Kris	DATE 2014-08-11
CUSTOMER ALTW	APPROVED BY Wenmao	DATE 2014-08-11

THIS DOCUMENT IS SUBJECT TO CHANGE WITHOUT NOTICE. IT IS CONFIDENTIAL AND A PROPERTY OF Amphenol LTW. DISCLOSURE TO THIRD PARTY HAS TO BE AUTHORIZED BY Amphenol LTW.