

RCU-G-02.00-AMS-AM

RCU SERIES

# IP68 SEALED USB CABLE PLUG

## SPECIFICATIONS

For complete specifications see [www.samtec.com?RCU](http://www.samtec.com?RCU)

- Insulator Material:** Glass Filled Thermoplastic
- Contact Material:** Phosphor Bronze
- Current Rating:** 4.2 A per pin (1 pin powered)
- Operating Temp Range:** -20 °C to +80 °C
- Shield Material:** Phosphor Bronze
- Wire:** 20 AWG (Power)  
25 AWG (Signal)  
28 AWG (Drain)

Mates with:  
RPCU, RPBU



**Solutionator**  
DESIGN IN A MINUTE

- Easy sealed cable solutions
- Build a standard or flexible custom online
- Calculate performance, current rating, voltage drop
- Live chat with AccliMate™ engineers for custom options
- Variety of shells, pin sizes, signal, power, I/O interfaces
- Assembly and field kits available

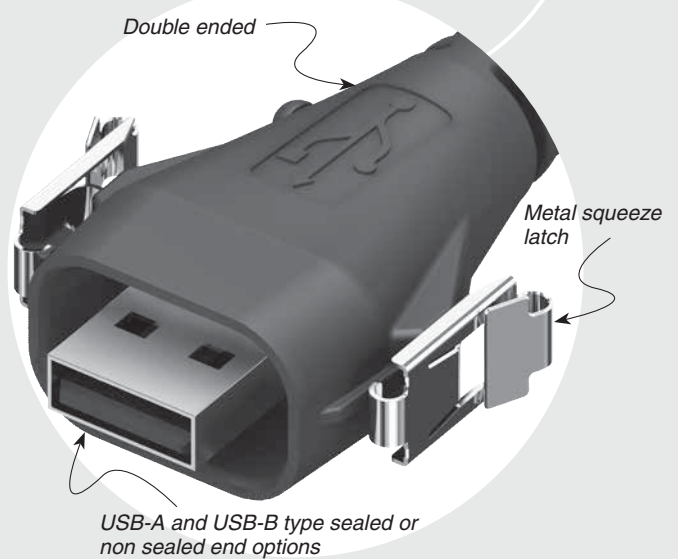

USB-A and USB-B type sealed or non sealed end options

## DUST CAPS

- AMS = DCA-RCU-01-01-A
- BMS = DCA-RCU-01-01-B

## ALSO AVAILABLE (MOQ Required)

- Other wire lengths
- End option 2 with -AMS, -BMS or -BM

### RCU

### PLATING

**-G**  
= 30 μm (0.76 μm)  
Gold on contact,  
Nickel on shell

### WIRE LENGTH

**-01.00**  
= (1 m) 40" Cable  
**-02.00**  
= (2 m) 79" Cable  
Standard lengths

### END 1 OPTION

**-AMS**  
= USB A Type,  
Sealed  
**-BMS**  
= USB B Type,  
Sealed

### END 2 OPTION

**-AM**  
= USB A Type,  
Not Sealed  
**-BC**  
= Blunt Cut

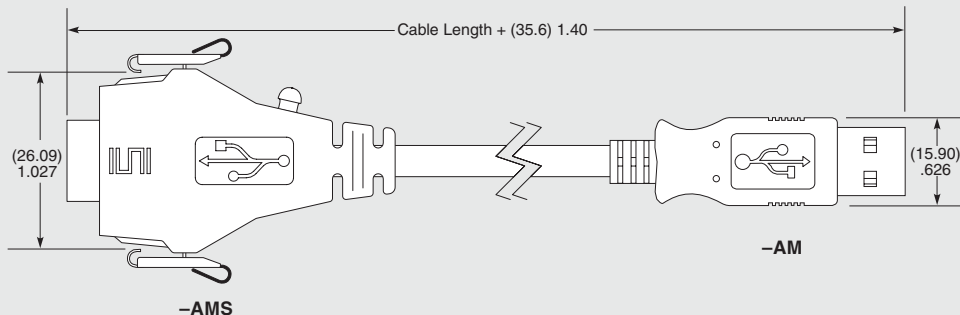

Due to technical progress, all designs, specifications and components are subject to change without notice.