

THIS DRAWING IS A CONTROLLED DOCUMENT

THIS DRAWING IS UNCLASSIFIED DATE 10/28/2001 BY AMP INCORPORATED ALL RIGHTS RESERVED

DIST 66

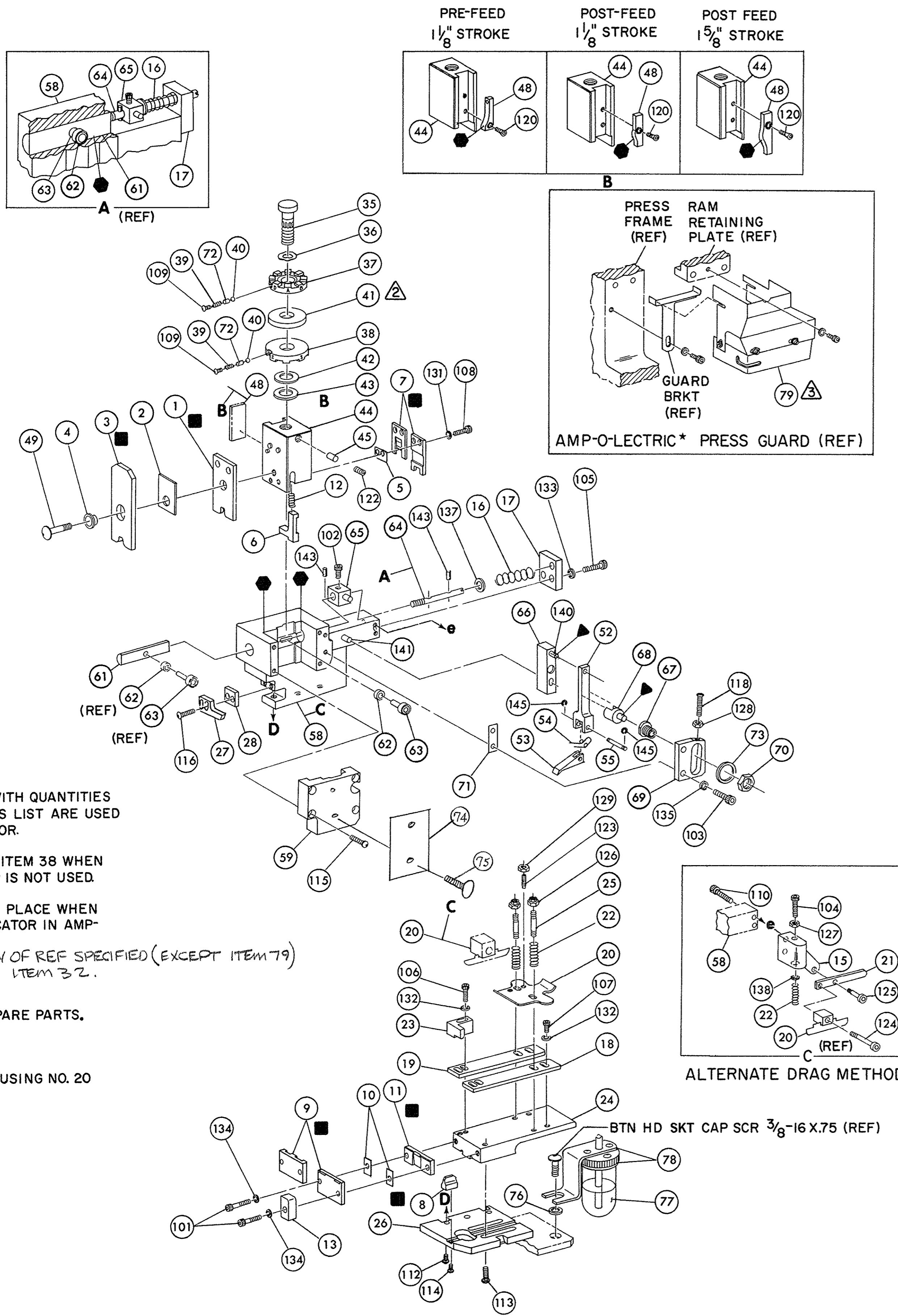

- NOTES:**
- ONLY THE ITEMS WITH QUANTITIES SPECIFIED ON PARTS LIST ARE USED ON THIS APPLICATOR.
  - USED IN PLACE OF ITEM 38 WHEN INSULATION CRIMP IS NOT USED.
  - GUARD MUST BE IN PLACE WHEN OPERATING APPLICATOR IN AMP-O-LECTRIC PRESS.
  - PARTS WITH QTY OF REF SPECIFIED (EXCEPT ITEM 79) ARE USED ON ITEM 32.
- KEY:**
- RECOMMENDED SPARE PARTS.
  - LUBRICATE DAILY USING NO. 20 MACHINE OIL.
  - GREASE LIGHTLY.

\* Trademark of AMP Incorporated

REF	21045-3	RING, RETAINING 'C' (.187 DIA) FEED PIN	145	REF	454220-1	CAP, RAM	59
REF	5-21028-1	PIN, SLOT SPG (.12 DIA X .50) FD ADJ ROD	143	REF	453736-1	HOUSING	58
REF	1-21030-7	PIN, DOWEL (.187 DIA X 1.50) HOUSING	141	REF	240624-1	PIN, FEED FINGER	55
REF	1-21030-1	PIN, DOWEL (.187 DIA X .50) LEVER	140	REF	691499-1	SPRING, FEED FINGER	54
-	22260-5	WASHER, FLAT (NO 6) DRAG SPRING	138	REF	240635-1	FINGER, FEED	53
REF	21899-4	WASHER, FLAT (5/16 DIA) SCR ADJ	137	REF	240634-3	LEVER, TERMINAL	52
REF	21024-5	WASHER, LOCK (NO 10) FEED ADJ PLATE	136				50
2	21024-5	WASHER, LOCK (NO 10) SHEAR PLATES	134	1	7-21002-9	BOLT, CRIMPER	49
REF	21024-5	WASHER, LOCK (NO 10) FEED ROD GUIDE	133	1	690501-3	CAM, POST FEED 1/8" STROKE	48
5	21024-4	WASHER, LOCK (NO 8) STRIP GUIDE	132				47
2	21024-4	WASHER, LOCK (NO 8) SHEAR BLADE	131	1	690191-1	PLUG, NYLON	46
2	21018-4	NUT, HEX MACH (4-40) DRAG	130	1	455674-1	RAM	45
REF	21068-5	NUT, HEX MACH (6-32) FD ADJ PLATE	129	1	690125-1	WASHER, LAMINATED	44
-	21018-7	NUT, HEX MACH (10-32) DRAG SPRING	128	1	690124-1	WASHER, RAM	43
2	21022-2	NUT, HEX SELF-LKG (8-32) DRAG STUD	127			SPACER, DISC	42
-	5-21004-7	SCR, SKT HD SHLD (250 DIA X .25) DRAG ARM	126	2	23241-6	BALL, STEEL	41
-	21004-5	SCR, SKT HD SHLD (250 DIA X 1.00) DRAG	125	2	690170-1	SPRING, COMPRESSION	40
2	4-21078-8	SCR, SKT SET OVAL POINT (4-40 X .75) DRAG	124	1	690142-1	DISC, INSULATION	39
1	21009-2	SCR, SKT SET (1/4-20 X 25) (LOC-WEL) RAM	123	1	2-455829-3	DISC, WIRE	38
1	1-21002-7	SCR, BTN HD SKT CAP (6-32 X .38) CAM	122	1	22480-5	WASHER, SPRING	37
REF	3-21064-2	SCR, RD HD MACH (6-32 X 1.50) FEED ADJ	121	1	690212-1	POST, RAM	36
2	2-21002-2	SCR, BTN HD SKT CAP (8-32 X .50) STRIPPER	120				35
REF	2-21002-9	SCR, BTN HD SKT CAP (10-32 X .75) HSG CAP	119				34
1	22733-8	SCR, BTN HD SKT CAP (8-32 X .38) (LOC-WEL) ANVIL	118	1	458980-2	APPLICATOR, BASIC (SUB ASSY)	33
4	3-21002-3	SCR, BTN HD SKT CAP (1/4-20 X .50) STR GDE PL	117				32
REF	2-22733-9	SCR, BTN HD SKT CAP (1/4-20 X .75) BASE PL	116				31
-	2-21000-4	SCR, SKT HD CAP (6-32 X 1.00) DRAG ADAPTOR	115				30
2	23030-1	SCR, SKT HD CAP (6-32 X .25) (LOC-WEL) CP DISC	114				29
3	2-21000-6	SCR, SKT HD CAP (8-32 X .38) SHEAR BLADE	113	1	3-690451-2	SPACER, STRIPPER	28
2	2-21000-7	SCR, SKT HD CAP (8-32 X .38) STRIP GUIDE	112	2	240639-1	STRIPPER	27
REF	3-21000-7	SCR, SKT HD CAP (10-32 X .75) FD ROD GUIDE	111	REF	455676-1	PLATE, BASE	26
REF	3-21000-9	SCR, SKT HD CAP (10-32 X 1.00) DRAG SPRING	110	2	22354-8	DRAG, STUD	25
REF	3-21000-6	SCR, SKT HD CAP (10-32 X .62) FD ADJ PLATE	109	1	455678-6	PLATE, STRIP GUIDE	24
REF	3-21000-4	SCR, SKT HD CAP (10-32 X .38) PIVOT BLK	108	1	240825-3	PLATE, STRIP HOLD	23
REF	455745-1	GUARD, WINDOW	107	2	4-22281-1	SPRING, DRAG	22
-	465184-9	LUBRICATOR ASSY	106	1	240636-1	LEVER, DRAG	21
-	455985-1	OIL, LUBRICATING	105	1	454177-1	DRAG, STOCK	20
-	454406-1	SPACER, LUB BRACKET	104	1	454204-3	GUIDE, STRIP (REAR)	19
2	21017-2	DRIVE SCREW	103	1	454204-3	GUIDE, STRIP (FRONT)	18
1	461264-1	ID PLATE	102	REF	454178-1	GUIDE, FEED ROD	17
REF	458109-1	WASHER, FLAT (SPECIAL)	101	REF	4-22284-9	SPRING, FEED RETURN	16
REF	690603-1	SPRING, ASSIST	79			ADAPTER, DRAG	15
REF	690517-1	SPACER	78				14
	22594-8	NUT, HEX	77			SPACER, HOLD DOWN	13
	240628-1	PLATE, ADJ	76			SPRING, HOLD DOWN	12
	240626-1	SHAFT, PIVOT	75	1	691901-2	PLATE, REAR SHEAR	11
	240633-1	BUSHING	74	2	1-240645-6	SPACER, SHEAR PLATE	10
	455680-1	LEVER, INTERMEDIATE	73	1	690783-3	PLATE, FRONT SHEAR	9
	240629-1	BLOCK, PIVOT	72	1	7-240655-3	ANVIL	8
	240632-2	SCREW, ADJ	71	1	691157-9	BLADE, SLUG	7
	240659-3	PIN, CAM ROLLER	70			HOLD DOWN, TERMINAL	6
	240658-1	CAM, ROLLER	69	1	3-240641-3	SPACER, SHEAR BLADE	5
	454398-1	ROD, FEED	68	1	238009-1	SPACER, TUBULAR	4
			67	1	1-456134-1	CRIMPER, INSULATION	3
			66	1	455888-4	SPACER, INSULATION	2
			65	1	456407-8	CRIMPER, WIRE	1

QTY	PART NO	DESCRIPTION	ITEM NO

CRIMPING DATA				APPLICATOR WILL APPLY	
PAD LTR	CRIMP HEIGHT	WIRE SIZE	WIRE STRIP LENGTH		
A	.086	14			60546
B	.076	16			
C	.070	18			
D	.066	20			
CRIMP	SIZE	TYPE	FEED	APPL INST	
WIRE	100	F			
INSUL	210	F	.682	A1 8039	
WIRE RANGE	INSULATION RANGE		PRESS NO		
20-14	120-170		56435-5		
REMARKS					
AMP-O-LECTRIC POST FEED					

REMARKS	NO	REV
TO APPLY TERMINAL SPEC 114-2084		
APPL USED ON MACHINE PART NO	MACH SERIAL NO	DISTRIBUTION
CUSTOMER NAME	APPL SERIAL NO	ORIGINAL
ADDRESS	PURCHASE ORDER	CUSTOMER COPY
CITY	ENG APP	FIELD ENG COPY