

EC NO: S2004-0570 DRWN: AAKULKAR 2004/04/28 CHKD: BHOW 2004/04/28 APPR: SLOW 2004/04/29	QUALITY SYMBOLS ▼ - 2 ▽ - 0	GENERAL TOLERANCES (UNLESS SPECIFIED)		SCALE NTS	DESIGN UNITS METRIC	THIRD ANGLE PROJECTION	REVISE ON CAD ONLY
		mm	INCH	DIMENSION STYLE MM ONLY	TITLE ASSEMBLY 5.72MM P-S-P, RECEPT. CONFIG, V/A, P/F, B/L		
DESCRIPTION A	4 PLACES ± --- ± ---	3 PLACES ± --- ± ---	2 PLACES ± 0.08 ± ---	DRAWN BY NRVITTAP	DATE 2004/04/02	MOLEX INCORPORATED	
	1 PLACE ± 0.13 ± ---	ANGULAR ± 3 °		CHECKED BY BHOW	DATE 2004/04/27	MATERIAL NO. SEE TABLE	DOCUMENT NO. E-87876-002
REV	DRAFT WHERE APPLICABLE		MUST REMAIN WITHIN DIMENSIONS		APPROVED BY SLOW	DATE 2004/04/27	SHEET NO. 1 OF 2
THIS DRAWING CONTAINS INFORMATION THAT IS PROPRIETARY TO MOLEX INCORPORATED AND SHOULD NOT BE USED WITHOUT WRITTEN PERMISSION							B

10	9	8	7	6	5	4	3	2	87876
ASSEMBLY PART NUMBER	P-S-P CONFIGURATION			RECESSED POWER CIRCUIT	COMPONENT PART NUMBER				
	POWER BETA	SIGNAL	POWER ALPHA		HOUSING	SIGNAL	POWER STANDARD	POWER RECESS	PACKAGING TRAY
87876-6000	2	8	2	B1,A1	87876-0030	87622-0025	87622-0133	87622-1133	89990-8040

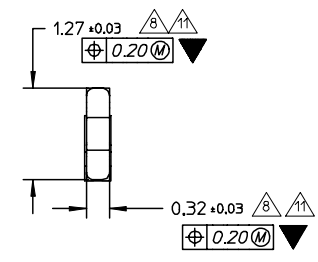
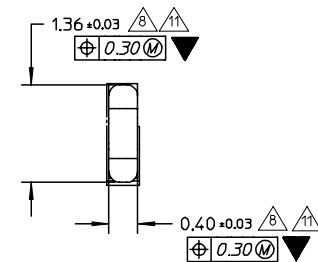
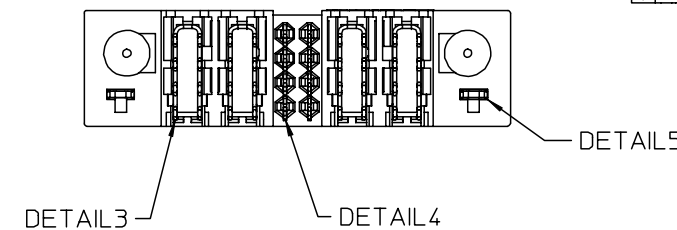
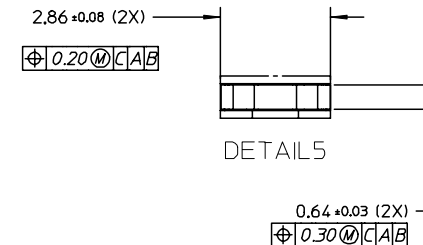
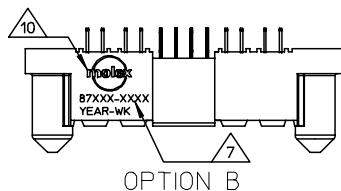

NOTES

- MATERIALS :-  
HOUSING - VECTRA E130i, 30% GLASS FILLED,UL94V-0,COLOR:BLACK.  
SIGNAL TERMINAL - COPPER-NICKEL-SILICON ALLOY,C70250-TM02-SPL.  
POWER TERMINAL - COPPER ALLOY, C19210 HARD (KFC).
- FINISH :-  
SIGNAL & POWER CONTACTS  
534 - 0.76um MIN. GOLD AT CONTACT AREA AND 2.54um MIN TIN  
AT SOLDER TAIL AREA OVER 1.27um MIN NICKEL UNDERPLATE.
- SPECIFICATIONS :-  
PRODUCT SPECIFICATION : PS-87633-006  
APPLICATION SPECIFICATION : AS-87633-007
- SIGNAL TERMINAL RETENTION IN HOUSING MUST BE 0.45KG MIN.
- POWER TERMINAL RETENTION IN HOUSING MUST BE 0.75KG MIN.
- MAXIMUM ALLOWABLE BURR IS 0.08mm.
- LASER CUT MARKING OF PART NUMBER AND YEAR-WEEK CODE AT ASSEMBLY STAGE.
- RELATIVE PATTERNS OF SIGNAL AND POWER SOLDER TAIL ARE TAKEN AS ONE.
- ASSEMBLY FIXTURE OR MACHINE SHALL SUPPORT CONNECTOR P-S-P CONFIGURATION OF UP TO 8 INCHES IN LENGTH.  
SIGNAL PIN COUNT RANGE FROM 4 TO 64 IN MULTIPLE OF 4.
- LASER CUT MARKING ON LOGO IF THE NUMBER OF POWER BLADE IS LESS THAN 3. MARKING LOCATION TO BE DETERMINED BY PROCESS OWNER.  
REFER TO OPTION B FOR ALTERNATE LASER MARK.
- TO USE GAUGE FOR FA QUALIFICATION AND PROCESS CHECK.
- OPTIONAL BOARDLOCK FEATURE FOR SYMMETRICAL POWER CONFIG FULL PROOFING UPON CUSTOMER REQUEST.

EC NO: S2004-0570 DRWN:AAKULKAR004/04/28 CHKD:BHLOW 2004/04/28 APPR:SCLOW 2004/04/29	QUALITY SYMBOLS ▼ = 4 ▽ = 0	GENERAL TOLERANCES (UNLESS SPECIFIED)		SCALE	DESIGN UNITS	THIRD ANGLE PROJECTION	REVISE ON CAD ONLY	
		mm	INCH	NTS	METRIC	DIMENSION STYLE		
		4 PLACES	± ---	± ---	MM ONLY			TITLE
		3 PLACES	± ---	± ---	DRAWN BY DATE			ASSEMBLY
2 PLACES	± 0.08	± ---	NRVITTAP 2004/04/02			5,72MM P-S-P, RECEPT.		
1 PLACE	± 0.13	± ---	CHECKED BY DATE			CONFIG., V/A, P/F, B/L		
ANGULAR ± 3 °		APPROVED BY DATE			MOLEX INCORPORATED			
DRAFT WHERE APPLICABLE		SCLOW 2004/04/27			MATERIAL NO.	DOCUMENT NO.	SHEET NO.	
MUST REMAIN WITHIN DIMENSIONS		THIS DRAWING CONTAINS INFORMATION THAT IS PROPRIETARY TO MOLEX INCORPORATED AND SHOULD NOT BE USED WITHOUT WRITTEN PERMISSION			SEE TABLE	E-87876-002	2 OF 2	