

Boardlocks not shown in this view

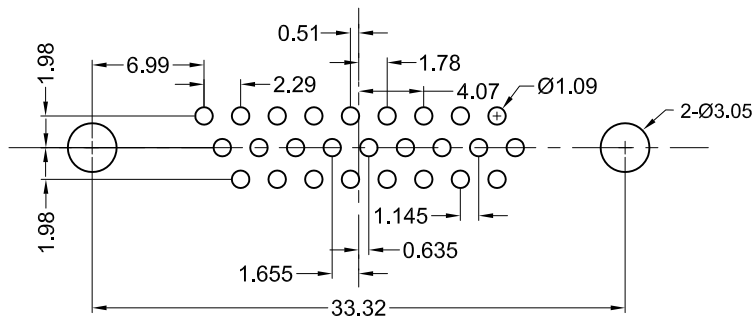

Recommended PCB Layout
(Top View)

Material and Finish

Shell: Steel, Nickel Plated

Insulator: PBT thermoplastic
with glass-fiber reinforcement,
UL94V-0 rated
Color: Black

Contact Material:
Socket - Brass

Contact Plating Options:

Standard: gold flash on
mating end, tin on
termination end, nickel
underplate on entire contact

15 Option: 15u" gold on
mating end, tin on
termination end, nickel
underplate on entire contact

30 Option: 30u" gold on
mating end, tin on
termination end, nickel
underplate on entire contact

Electrical Specifications

Rated Current: 1.5A

Rated Voltage: 30Vac

Insulation Resistance:
more than 1000 megohms at
500V DC

Contact Resistance:
13 milliohms max.

Dielectric Withstanding Voltage:
1000V for 1 minute

Operating Temperature:
-55°C to +75°C

Part Number	Gold Option
K86X-AD-26S-BR	Gold Flash (standard)
K86X-AD-26S-BR15	15u" Gold (15 option)
K86X-AD-26S-BR30	30u" Gold (30 option)



Tolerances
X.X ± 0.25
X.XX ± 0.15
Unless Stated Otherwise

REV.	DATE	DESCRIPTION	REV. BY	CHK. BY	DRAWN BY	DATE
A1	12/29/05	New Drawing	R. Aguirre	H. MA	R. Aguirre	12/29/05
A2	1/16/08	ECO# 07-052	WILL H.	H. MA		
A3	8/29/14	ECO# 14-028	H. MA	P. DalCanto		
A4	12/31/17	ECO# 17-033	G. Serrato	C. Furumasu		

K86X-AD-26S-BR

High Density, D-Sub, Vertical Mount,

26 pin socket, RoHS Compliant

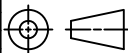

UNITS
mm