

ERK610Z681KYGO

Aliases (C812YG681K440X, ERK610RK3680KYGO)

Obsolete

ERK610 SFTY X1-440 Y2-300, Ceramic, 680 pF, 10%, 440 VAC (X1), 300 VAC (Y2), Y5U, Lead Spacing = 12.5mm

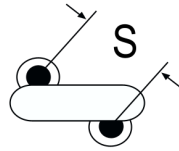
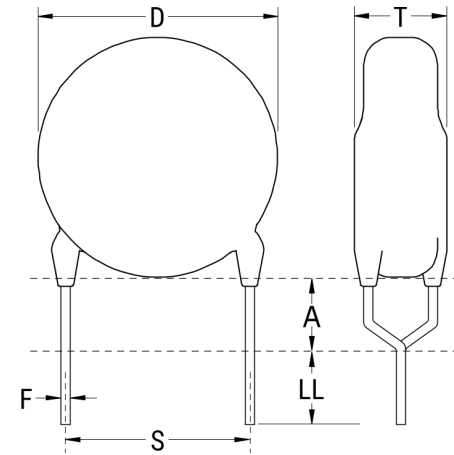

The measurement position of Lead Spacing (S) and Width (V) is critical in straight lead capacitors.

Click [here](#) for the 3D model.

Dimensions

| | |
|----|-----------------|
| D | 9mm MAX |
| T | 6mm MAX |
| S | 12.5mm NOM |
| LL | 2.8mm +1.5mm |
| F | 0.6mm +/-0.05mm |
| A | 6mm MAX |
| V | 2mm +/-0.5mm |

Packaging Specifications

| | |
|-----------|-----------|
| Packaging | Bulk, Bag |
|-----------|-----------|

General Information

| | |
|----------------|---|
| Series | ERK610 SFTY X1-440 Y2-300 |
| Style | Radial Disc |
| Description | Ceramic Single Layer Safety Disc Capacitors |
| RoHS | Yes |
| Termination | Tin |
| Qualifications | UL, CSA, CAN, ENEC, VDE |
| AEC-Q200 | No |

Specifications

| | |
|-------------------------|----------------------------|
| Capacitance | 680 pF |
| Capacitance Tolerance | 10% |
| Voltage AC | 440 VAC (X1), 300 VAC (Y2) |
| Temperature Range | -40/+125°C |
| Temperature Coefficient | Y5U |
| Dissipation Factor | 2.5% |
| Insulation Resistance | 6 GOhms |
| Safety Class | X1/Y2 |