

## Core **ER35/21/11**

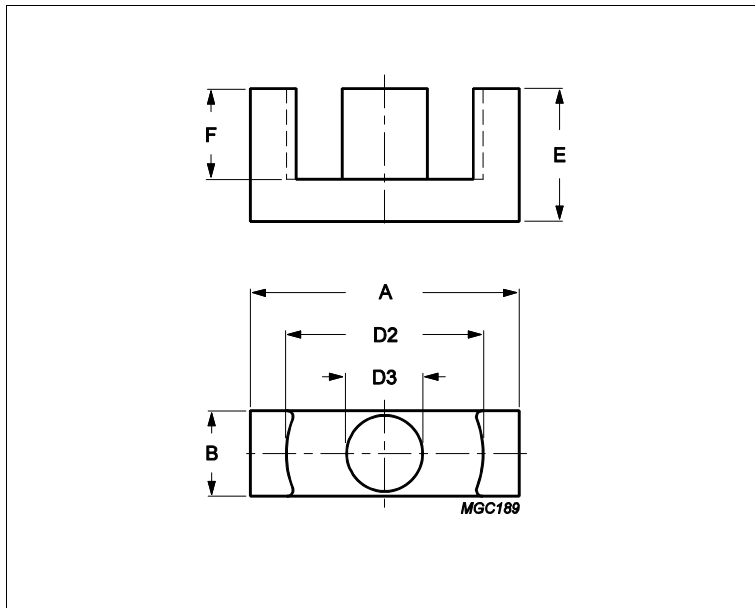

Effective parameters			
	Parameter	Value	Unit
$\Sigma(I/A)$	core factor (C1)	0.849	mm <sup>-1</sup>
<b>Ve</b>	effective volume	9710	mm <sup>3</sup>
<b>Le</b>	effective length	90.8	mm
<b>Ae</b>	effective area	107	mm <sup>2</sup>
<b>Amin</b>	minimum area	100	mm <sup>2</sup>
<b>m</b>	ER35/21/11	≈ 23	g/pcs

Dimensions for product: ER35/21/11						
	Nom	Tol +	Tol -	Max	Min	Unit
<b>A</b>	35.00	0.65	0.65	35.65	34.35	mm
<b>B</b>	11.40	0.35	0.35	11.75	11.05	mm
<b>D2</b>	26.15	0.55	0.55	26.70	25.60	mm
<b>D3</b>	11.30	0.25	0.25	11.55	11.05	mm
<b>E</b>	20.70	0.20	0.20	20.90	20.50	mm
<b>F</b>	14.75	0.35	0.35	15.10	14.40	mm

Inductance factor				
Material	Value	Tol +	Tol -	Unit
3C94	2800	25%	25%	nH/turns <sup>2</sup>

Power loss: 3C94				
Measuring conditions			Max	Unit
100 kHz	200 mT	100 °C	4.900	W/set

Bsat					
Measuring conditions			Material	Min	Unit
25 kHz	250 A/m	100 °C	3C94	320	mT