

SECTIONS

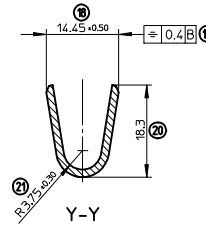

PACKAGING

SEE NOTE 4

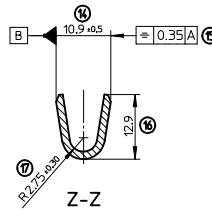
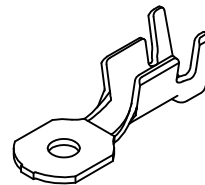
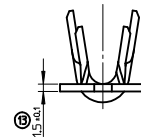

PART SHOWN : 0988611209

PART NUMBER	ØA ±0.1
0988611209	6.35
0988611219	8.6

MARKING :

1 - ENGINEERING CONTROL ID

NOTES :

- 1 - MATERIAL : BRASS
- 2 - PLATING : POST-TIN PLATED
- 3 - CRIMPING RANGE (mm2) : 12 TO 27
- 4 - PACKAGING : PARTS DELIVERED ON LOOSE (800 PER CARDBOARD BOX)

INSPECTION BALLOON NUMBER LOG

PER DRAWING REVISION : A  
 LAST BALLOON NUMBER USED : 21  
 ADDED BALLOON NUMBERS : NONE  
 REMOVED BALLOON NUMBERS : NONE

FIRST RELEASE EC NO: G2013-0309 DRAWN: PBOSQUAIN 2013/10/10 CHKD: JDUCLOS 2017/09/05 APPROV: PLESSIS 2017/09/28	QUALITY SYMBOLS ▽=0 ▽=0 ▽=0	GENERAL TOLERANCES (UNLESS SPECIFIED)		DIMENSION STYLE MM ONLY		SCALE 2:1	DESIGN UNITS METRIC	FIRST ANGLE PROJECTION		
		4 PLACES ±	mm	INCH	DRAWN BY PBOSQUAIN	DATE 2013/10/10	TITLE RING TERMINAL 6-8X17X1.5 12-27			
		3 PLACES ±			CHECKED BY JDUCLOS	DATE 2017/09/05				
		2 PLACES ±			APPROVED BY OPLESSIS	DATE 2017/09/28				
DRAFT WHERE APPLICABLE MUST REMAIN WITHIN DIMENSIONS		ANGULAR ±		SEE CHART		MATERIAL NO.		DOCUMENT NO. SD-98861-003		
SIZE A 1		THIS DRAWING CONTAINS INFORMATION THAT IS PROPRIETARY TO MOLEX INCORPORATED AND SHOULD NOT BE USED WITHOUT WRITTEN PERMISSION								SHEET NO. 1 OF 1

molex

RING TERMINAL  
6-8X17X1.5 12-27

SD-98861-003

1 OF 1