

REVISIONS				
P	LTR	DESCRIPTION	DATE	APVD
	M2	REV PER ECN-22-156403	03JUN2022	RK CSD

**AMP**  
WIRE RANGE

---

12-10 AWG  
STRANDED

1 WIRE INSULATION  $\phi 3.810[\phi.150]$  TO  $\phi 5.588[\phi.220]$ .

2 FINISH:  
BODY AND SLEEVE: TIN/LEAD (93-7) PLATE PER ASTM B545.  
(3% MIN LEAD CONTENT)  
INSULATION: COLOR-NATURAL.

3 MATERIAL:  
BODY AND SLEEVE: COPPER PER ASTM B152  
INSULATION: PVF<sup>2</sup>.

2 STRIPES(180° APART)  
COLOR: YELLOW

3.556  
[.140]  
MIN TYP

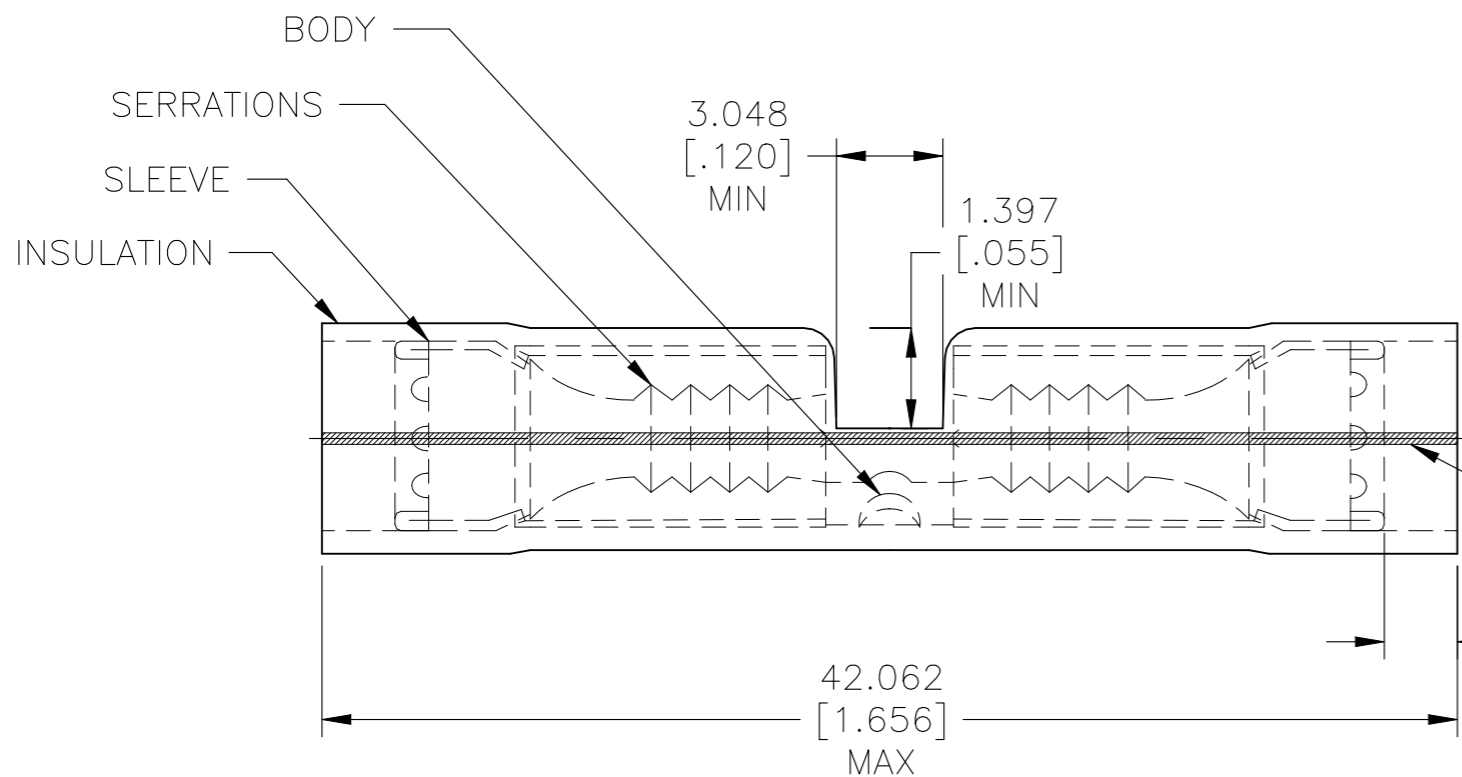

M7928/6-5 CLASS 1	500	LOOSE PIECE	53550-1
MILITARY PART NUMBER AND CLASS PER MIL-T-7928	QTY	PACKAGE TYPE	PART NO.

<b>AMP INCORPORATED CUSTOMER SERVICE SYSTEMS</b>		MAX RECOMMENDED OPERATING TEMPERATURE: 150°C[302°F]	THIS DRAWING IS A CONTROLLED DOCUMENT.		DWN S.S. GOULDEN 9-28-93	<b>STE</b> TE Connectivity					
FOR ADDITIONAL PRODUCT INFORMATION OR COPIES OF DRAWINGS AND TECHNICAL DOCUMENTS	PRODUCT INFORMATION CENTER 1-800-522-6752	VOLTAGE RATING: -	DIMENSIONS: mm [INCHES]	TOLERANCES UNLESS OTHERWISE SPECIFIED:	CHK R. HERSEY 9-28-93	NAME SPLICE, BUTT, PVF <sup>2</sup> , P.I.D.G. WIRE SIZE: 12-10 AWG					
FOR APPLICATION TOOLING INFORMATION	TOOLING ASSISTANCE CENTER 1-800-722-1111	CIRCULAR MIL AREA: 2.62-6.64mm <sup>2</sup> [5,180-13,100] STRANDED		0 PLC ± - 1 PLC ± - 2 PLC ± - 3 PLC ± 0.127[.005] 4 PLC ± - ANGLES ± -	APVD M ELLIS 9-28-93						
FOR ORDER ENTRY	1-800-526-5142	THIS DRAWING IS A CONTROLLED DOCUMENT FOR AMP INCORPORATED. IT IS SUBJECT TO CHANGE AND THE CONTROLLING ENGINEERING ORGANIZATION SHOULD BE CONTACTED FOR THE LATEST REVISION.		MATERIAL 3	FINISH 2	PRODUCT SPEC -	APPLICATION SPEC 114-2157	SIZE A3	CAGE CODE 00779	DRAWING NO C-53550	RESTRICTED TO -
						WEIGHT -	CUSTOMER DRAWING		SCALE 1:1	SHEET 1 OF 1	REV M2