

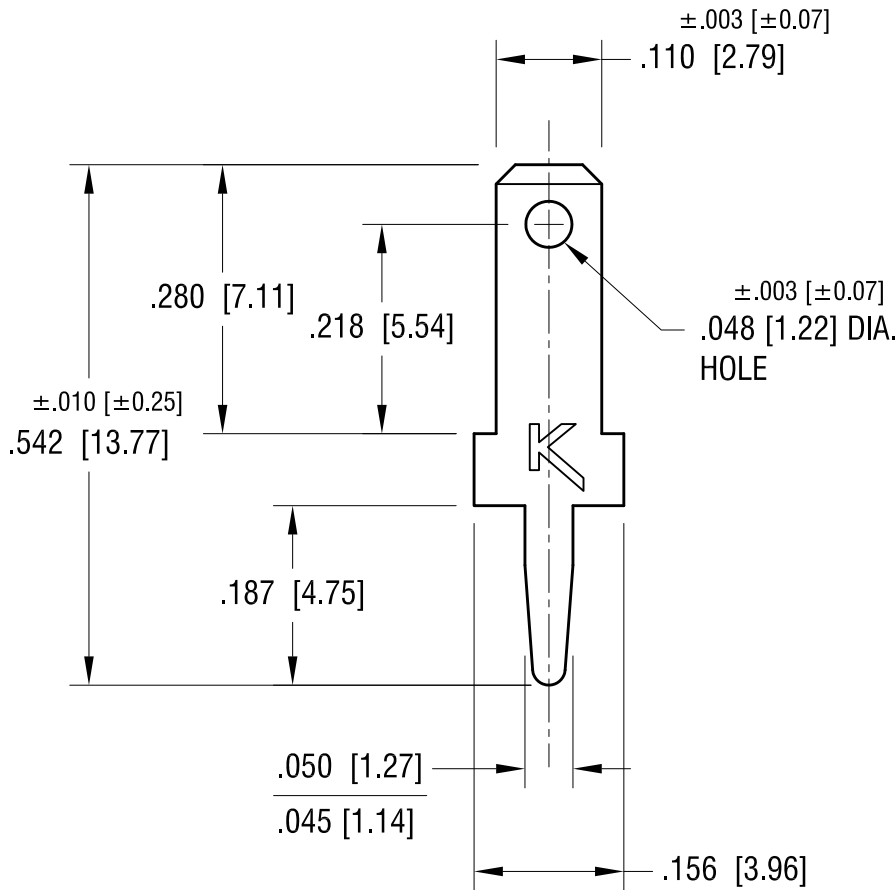

THIS DOCUMENT IS THE PROPERTY OF
KEYSTONE ELECTRONICS CORP. AND
SHALL NOT BE REPRODUCED, DISTRIBUTED
OR USED AS A BASIS FOR MANUFACTURE
WITHOUT PRIOR WRITTEN PERMISSION
FROM KEYSTONE ELECTRONICS CORP.

ACTUAL SIZE



NOTE:

1. MOUNTING HOLE SIZE: .046 [1.17] DIA.
2.  FILE NUMBER: E201546

4.16.16	CHANGE AS PER ECR 16-019	D
8.21.12	CHANGE AS PER ECN 12-112	C
6.16.09	CHANGE AS PER ECN 09-071	B
12.14.98	CHANGE AS PER ECR 98-088	A
DATE	DESCRIPTION	REV.

KEYSTONE ELECTRONICS CORP.			
www.keyelco.com • NEW HYDE PARK NY 11040 • Tel (516)328-7500			
PART NAME		.110 PC QUICK-FIT TERMINAL	
MATERIAL		.020 [0.50] TH'K BRASS	
FINISH		DRN BY	DATE
MATTE TIN PLATE		BOONE	9.25.95
		APP'D	SCALE
		MR	5X
TOLERANCES	INCH [MM]	CODE	DWG NO.
DECIMAL	± .005 [± 0.13]	C	1267
ANGULAR	± 1°		
UNLESS OTHERWISE SPECIFIED			