

OPERATING CHARACTERISTICS AT 25°C AMBIENT

DIALIGHT PART NUMBER	COLOR	LUMINOUS INTENSITY (mcd) @ I <sub>F</sub> = 20 mA			FORWARD VOLTAGE (V) @ I <sub>F</sub> = 20 mA			REVERSE CURRENT (μA) @ V <sub>R</sub> = 5 V	PEAK WAVELENGTH	DOMINANT WAVELENGTH	VIEWING ANGLE (DEG)
		MIN	TYP	MAX	MIN	TYP	MAX	MAX	(TYP)	TYP	TYP
597-3304-607F, -602F	GREEN	2.8	12	—	—	2.1	2.6	100	565	569	130

REV	ECO NO	REVISIONS	DRN	CKD	APP	DATE
A	—	NEW RELEASE	VP	JTD	NO	4/11/2016
B	—	ROHS COMPLIANT PART NUMBER CHANGED	VP	JTD	NO	4/18/2016

ABSOLUTE MAXIMUM RATINGS AT 25°C AMBIENT	VALUE	UNITS
POWER DISSIPATION	100	mW
DC FORWARD CURRENT	30	mA
PEAK FORWARD CURRENT (1/10 DUTY CYCLE, 0.1 ms PULSE WIDTH)	120	mA
REVERSE VOLTAGE	5	V
STORAGE TEMPERATURE	-55 TO +85	°C
OPERATING TEMPERATURE	-55 TO +85	°C
SOLDERING TEMPERATURE, FOR 1/10 SEC	260	°C

NOTES:

- LENS: GREEN
- LED CHIP: GaP ON GaP
- LEADS ARE GOLD (Au) PLATED FINISH.
- PACKAGING: -602F SUFFIX MEANS 20 PCS SAMPLE STRIP  
-607F SUFFIX MEANS 5000 PARTS/REEL, 7 INCH (180mm) DIA. REEL.
- THIS ASSEMBLY CONTAINS ELECTROSTATIC DISCHARGE SENSITIVE DEVICES (ESDS). MAINTAIN ALL PRECAUTIONARY MEASURES DURING ASSEMBLY, HANDLING, AND STORAGE IN ACCORDANCE WITH IPC-A-610.
- MOISTURE SENSITIVITY LEVEL 3.
- TAPE AND REEL LEDS MAY REQUIRE RE-TAPING AFTER TWELVE MONTHS.
- PIN NUMBERS FOR REFERENCE ONLY, DESIGNATION NON-EXISTENT ON PART.

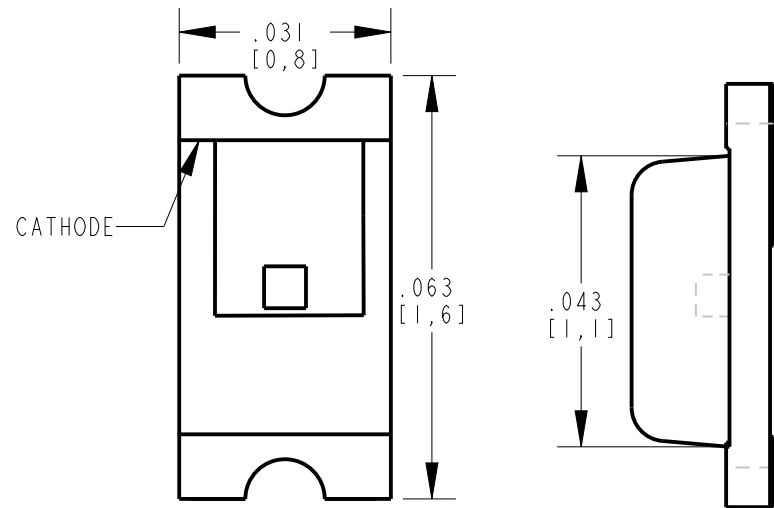

SCALE 35.000

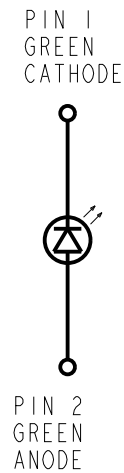

LED SCHEMATIC

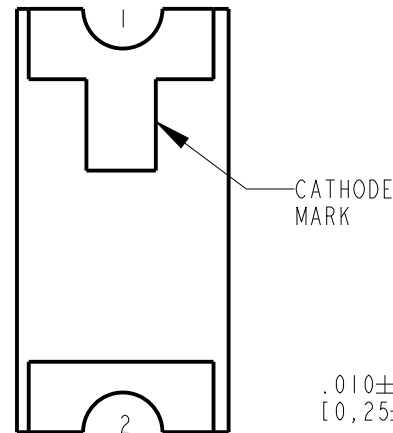

.010±.001  
[0,25±0,02]

.028±.002  
[0,7±0,05]

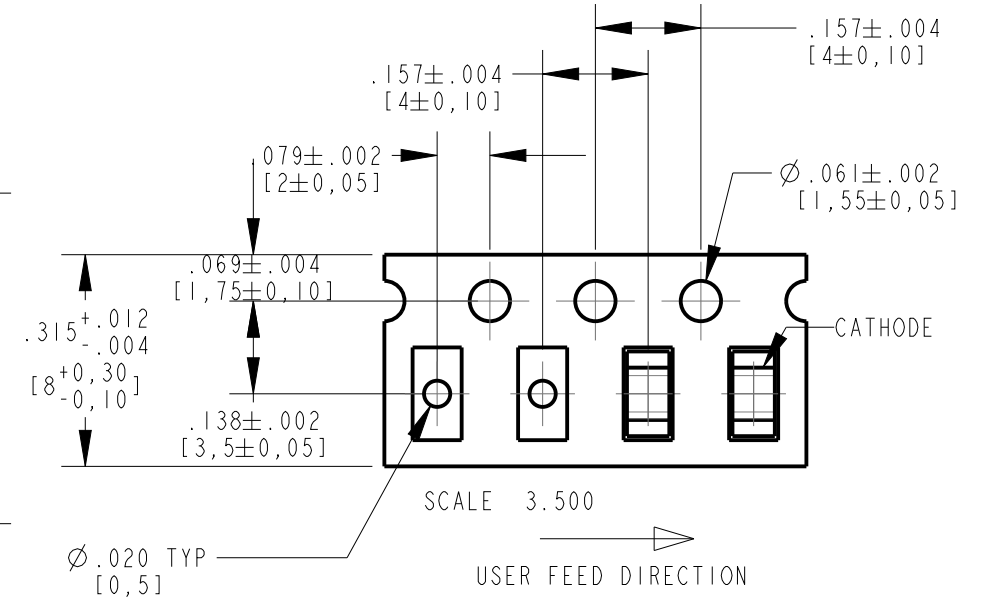

PACKAGE DIMENSIONS OF TAPE AND REEL

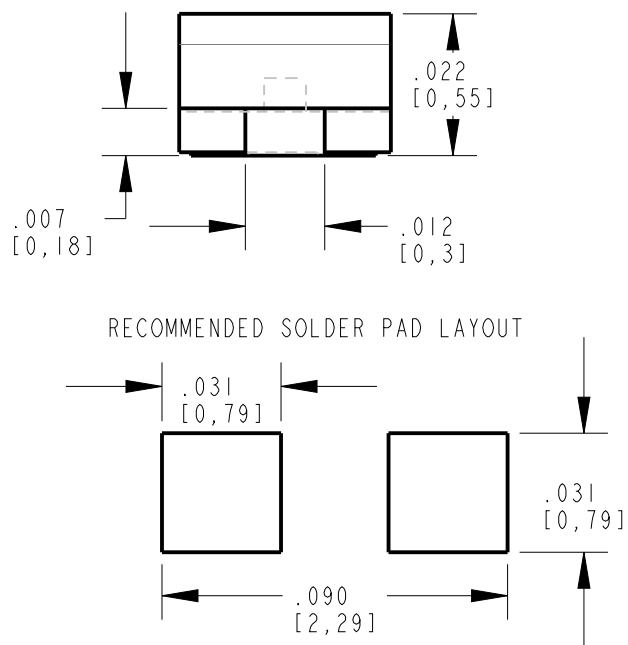

SCALE 20.000

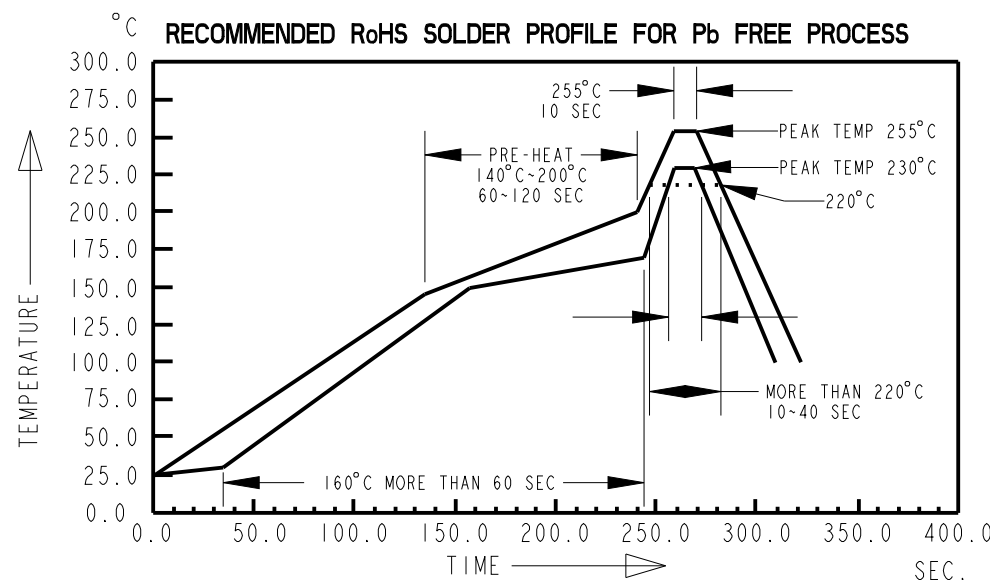

THIS DRAWING AND THE CONTENTS HEREIN ARE CONFIDENTIAL AND THE SOLE PROPERTY OF DIALIGHT. REPRODUCTION OF THIS DRAWING OR CONSTRUCTION OF ANY PARTS WITHIN THIS DRAWING ARE FORBIDDEN WITHOUT THE WRITTEN CONSENT OF DIALIGHT.

SCALE: 5.000	DRAWING NUMBER	REV
ALL DIM'S IN: INCHES (MM)	C-18264	B
TOLERANCES: UNLESS OTHERWISE SPECIFIED	TITLE GREEN COLOR	
FRACTIONS: ±1/64	0603 SM LED RoHS COMPLIANT	
DECIMALS (.XX): ±.01	MATERIAL	
DECIMALS (.XXX): ±.005	Dialight	
DECIMALS (.XXXX): ±.0005	1501 ROUTE 34 SOUTH FARMINGDALE, NJ 07727	
ANGLES: ±1°	FSCM 83330	
FINISH:	SHEET 1 OF 1	FAMILY TABLE: