

## SUMMARY

### # Wires



Image is for illustrative purpose only

Series	3K
Termination type	Female solder mixed / multi
IP rating	68
AWG wire size	30.00 - 22.00
Cable Ø	10.10 - 10.50 mm
Status	active

### Download

[Request a quote](#)

[Catalog](#)

## TECHNICAL DETAILS

### Mechanics

Shell Style/Model	PH*: Free receptacle, cable collet
Keying	1 key (alpha=0, plug: male contacts, receptacle: female contacts)
Housing Material	Brass (chrome plated [SAE AMS 2460]) shell and collet nut, nickel plated [SAE AMS QQ N 290] brass latch sleeve and mid pieces
Weight	81.71 g

### Performance

Configuration	
Insulator	L: PEEK (UL 94 / V-0/1.5)
Rated Current	2 Amps

### Others

Endurance (Shell): 5000 mating cycles  
Temp (min / max): -55°C / +200°C  
Humidity (max): <=95% [at 60 deg C / 140 F]  
Vibration: 15 g [10 Hz - 2000 Hz]

LEMO products and services are provided "as is". LEMO makes no warranties or representations with regard to LEMO product & services or use of them, express, implied or statutory, including for accuracy, completeness, or security. The user is fully responsible for his products and applications using LEMO components.

Shock Resistance: 100 g [ 6 ms]  
Climatical Category: 50/175/21  
Shielding (min): 95 dB (10 MHz)  
Shielding (min): 80 dB (1 GHz)  
Salt Spray Corrosion: >1000 hr

## DRAWINGS

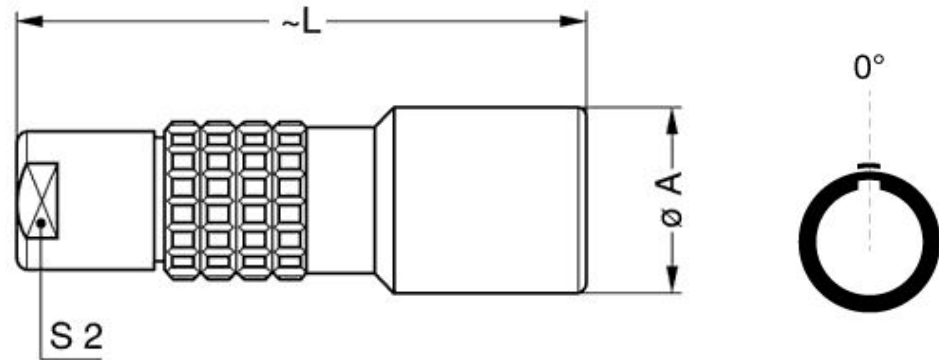

### Dimensions

	A	L	S2
mm.	23	65	15
in.	0,91	2,56	0,59

## RECOMMENDED BY LEMO

### Tools

Die Tool: [DPE.99.103.8K](#)  
Spanner wrench: [DCD.3E.030.PA150](#)

### Cables

*LEMO products and services are provided "as is". LEMO makes no warranties or representations with regard to LEMO product & services or use of them, express, implied or statutory, including for accuracy, completeness, or security. The user is fully responsible for his products and applications using LEMO components.*