

CUSTOMER PRINT

PART NUMBER: 6380-XPG-3XXW(CCX)

- NOTES:**  
 1. ALL PARTS TO BE BULK PACKED.  
 2. CONTACTS SHIPPED UNASSEMBLED

KIT P/N	GROMMET SIZE
6380-XPG-3DCW	DAISY CHAIN
6380-XPG-311W	CABLE O.D. .09-.14 [2.3-3.5mm]
6380-XPG-315W	CABLE O.D. .15-.17 [3.8-4.3mm]
6380-XPG-318W	CABLE O.D. .18-.20 [4.6-5.1mm]
6380-XPG-321W	CABLE O.D. .21-.23 [5.3-5.8mm]

KIT P/N	NO. OF CONTACTS
6380-2PG-3XXW	2 #16
6380-3PG-3XXW	3 #16
6380-4PG-3XXW	4 #16
6380-XPG-3XXW	

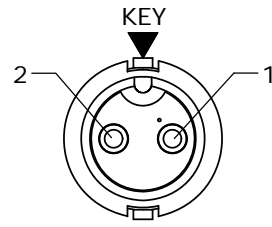

**FACE VIEW**  
6380-2PG-3XXW

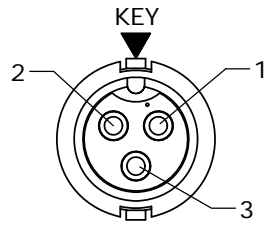

**FACE VIEW**  
6380-3PG-3XXW

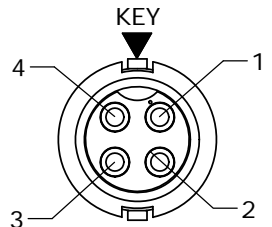

**FACE VIEW**  
6380-4PG-3XXW

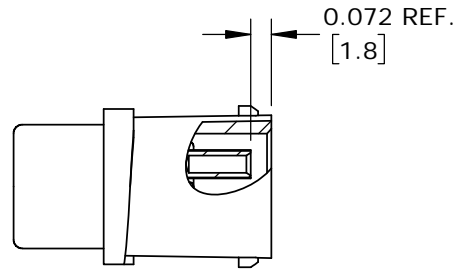

**ASSEMBLY CONTACT REFERENCE**  
FOR CUSTOMER REFERENCE ONLY

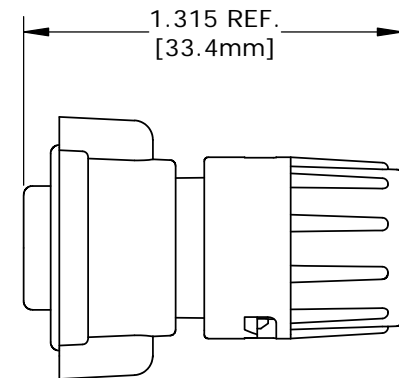
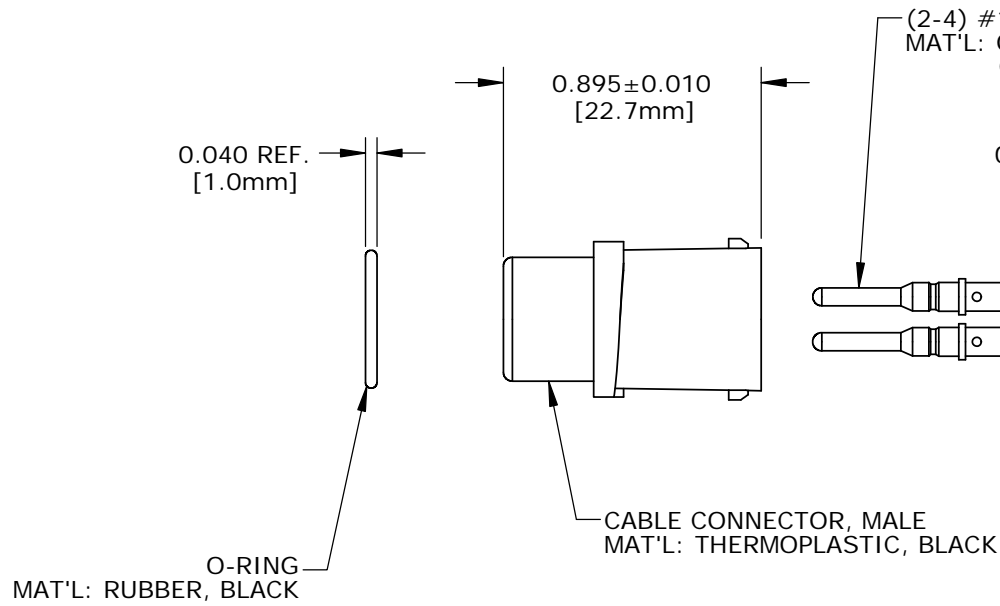

**SHOWN ASSEMBLED KIT**  
FOR CUSTOMER REFERENCE ONLY

**GROMMET, DAISY CHAIN**  
FOR 6380-XPG-3DCW  
MAT'L: RUBBER, BLACK

(2-4) #16 PIN CONTACTS  
MAT'L: GOLD PLATED  
COPPER ALLOY

WINGED COUPLING RING  
MAT'L: THERMOPLASTIC, BLACK  
SEE CHART FOR OTHER  
COLORED COUPLING RING

**SINGLE GROMMET**  
MAT'L: SANTOPRENE, BLACK  
6380-XPG-311W .125 I.D. FOR CABLES .09-.14 [2.3-3.5mm] O.D.  
6380-XPG-315W .160 I.D. FOR CABLES .15-.17 [3.8-4.3mm] O.D.  
6380-XPG-318W .190 I.D. FOR CABLES .18-.20 [4.6-5.1mm] O.D.  
6380-XPG-321W .225 I.D. FOR CABLES .21-.23 [5.3-5.8mm] O.D.

ASS'Y P/N	COUPLING RING COLOR
6380-XPG-3XXWCC1	WHITE
6380-XPG-3XXWCC2	RED
6380-XPG-3XXWCC3	BLUE
6380-XPG-3XXWCC4	LIGHT GREY
6380-XPG-3XXWCC5	YELLOW
6380-XPG-3XXWCC6	MAROON
6380-XPG-3XXWCC7	GREEN

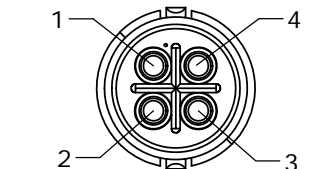

**WIRE VIEW**  
6380-4PG-3XXW SHOWN

GROMMET SIZE  
FOR SINGLE  
GROMMET OR  
"DC" FOR  
DAISY CHAIN

NO. OF CONTACTS

**CUSTOMER APPROVAL**

THIS DOCUMENT CONTAINS CONFIDENTIAL INFORMATION PROPRIETARY TO CONXALL CORPORATION. ANY REPRODUCTION, DISCLOSURE, OR USE OF THIS DOCUMENT / INFORMATION IS EXPRESSLY PROHIBITED UNLESS AUTHORIZED IN WRITING BY CONXALL CORPORATION.

APPROVED BY: \_\_\_\_\_

DATE: \_\_\_\_\_

**RoHS COMPLIANT**

C	SS	05-13-19	ADDED WINGED COUPLING RING COLOR CHART TO DRAWING PER DOR 19-E149SL #6
B	AN	11-04-13	GROMMET O.D. 0.465 WAS .48, ADDED COUPLING RING DIM. 0.434, ADD TOLERANCES, MATERIALS AND ASSEMBLED VIEW. PER ECR 8561
A	BZ	03-26-10	DRAWING CREATED PER DOR 10-E149SL
REV.	INIT.	DATE	DESCRIPTION
	BZ	03-26-10	ALL INFORMATION ILLUSTRATED IS THE PROPERTY OF "CONXALL CORPORATION". UNAUTHORIZED DUPLICATION OR DISTRIBUTION OF THIS DOCUMENT IS PROHIBITED.
			ALL UNITS ARE IN FEET, INCHES, FRACTION OF INCHES AND DECIMALS.
APPROVED BY:		TITLE: CABLE CONNECTOR KIT (2-4) #16 PIN CONTACTS MINI-CON-X WITH WINGED COUPLING RING	
SCALE: NTS	SIZE: B	SHEET: 1 OF 1	CUSTOMER: STANDARD PRODUCT
FILE: 6380-XPG-3XXW(CCX)	DIRECTORY: SLW	PART NUMBER: 6380-XPG-3XXW(CCX)	REV: C

DIMENSIONS IN BRACKETS [ ] ARE METRIC