

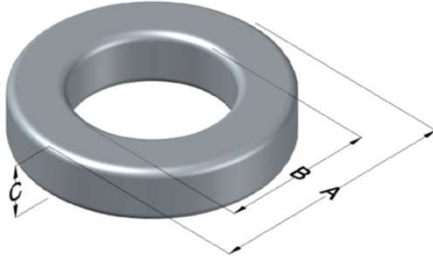

0077076A7

110 Delta Drive
 Pittsburgh, PA 15238
 NAFTA Sales: (1)800-245-3984
 HK Sales : (852)3102-9337
 magnetics@spang.com
 www.mag-inc.com



| Kool M μ Permeability (μ) | A _L (nH/T ²) | Core Marking | | | Coating Color |
|---|--|---------------|----------------|---------------------|------------------|
| | | Lot Number | Part Number | Inductance Grade | |
| 60 | 56 ± 8% | XXXXXX | 77076A7 | N/A | Black |

| Dimensions | Uncoated | | Coated Limits | | | Packaging |
|------------|----------|-------|---------------|-------|-----|--|
| | (mm) | (in) | (mm) | (in) | | |
| OD (A) | 35.81 | 1.410 | 36.70 | 1.445 | max | Cardboard cut-outs Box Qty= 220 pcs |
| ID (B) | 22.35 | 0.880 | 21.54 | 0.848 | min | |
| HT (C) | 10.46 | 0.412 | 11.35 | 0.447 | max | |

| Electrical Characteristics | | | Physical Characteristics | | | | | | |
|---|---------------------------|-----------|--|-------------------------------|---|---|---------------------------------------|---|---------------|
| Watt Loss @ 100kHz, 100mT max (mW/cm ³) | DC Bias min (oersteds) | | Voltage Breakdown wire to wire min (V _{AC}) | Break Strength min (kg) | Window Area W _a (mm ²) | Cross Section A _e (mm ²) | Path Length L _e (mm) | Volume V _e (mm ³) | Weight (g) |
| | 750 | 80% 39 | | | | | | | |

| Winding Information | | | | | Temperature Rating | |
|--|------|-------------------|------|---------------------------------|--------------------|-------------------|
| Winding Length Per Turn | | | | Wound Coil Dimensions (mm) | | Curie Temp: 500°C |
| Winding Factor | (mm) | Winding Factor | (mm) | 40% Winding Factor | OD | 41.1 |
| | | | | | HT | 18.0 |
| 0% | 37.9 | 40% | 48.8 | Completely Full Window | Max OD | 43.3 |
| 20% | 43.4 | 45% | 50.5 | | Max HT | 26.8 |
| 25% | 44.7 | 50% | 52.0 | Surface Area (mm ²) | | |
| 30% | 46.0 | 60% | 55.4 | Unwound Core | 3,500 | |
| 35% | 47.6 | 70% | 59.2 | 40% Winding Factor | 5,500 | |
| Notes: | | | | | | |
| Coating Temp (Continuous up to): 200°C | | | | | | |

