

PANEL THICKNESS	X dimension
0.75-1.25 [.030-.049]	19.2-.01 [.756]
1.25-2.0 [.049-.079]	19.4-.01 [.764]
2.0-3.0 [.079-.118]	19.8-.01 [.780]

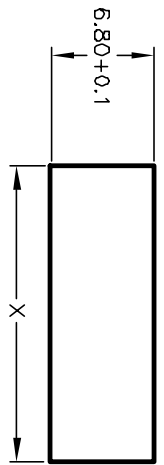

PANEL CUTOUT  
NOT TO SCALE

SWITCH FUNCTION	POS. 1	POS. 2
<DN>	DN	OFF
1-1a	OPEN	

< >=Momentary

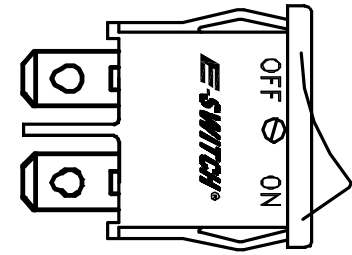

CIRCUIT: SPST

NOTES:

1. ALL DIMENSIONS IN MM
2. GENERAL TOLERANCE: X.X=±0.4; X.XX=±0.25
3. TERMINAL NUMBERS FOR REF ONLY
4. RATING: 4(1)A @250VAC, 6A @250VAC  
10A @125VAC
5. MATERIALS: TERMINALS: COPPER ALLOY W/SILVER PLATING  
CONTACTS: COIN SILVER
6. MECHANICAL LIFE: >50,000 CYCLES
7. ELECTRICAL LIFE: >10,000 CYCLES
8. CONTACT RESISTANCE: < 20 milli-OHMS (INITIAL)
9. INSULATION RESISTANCE: > 1000 MEGA-OHMS @ 500VDC
10. DIELECTRIC STRENGTH: >1500VAC 1 MINUTE (INITIAL)  
>3000V BETWEEN POLES

- ▲ 11. HOUSING & ACTUATOR COLOR:  
HOUSING: BLACK  
ACTUATOR: RED

**E-SWITCH®**

R6B BLK RED E F

REV.	ECN No.	DESCRIPTION	DATE	CHKD
A	12435	RELEASED FOR PRODUCTION	9/19/02	CJB

TITLE	SCALE	DATE	DR	DWG	REV
R6B BLK RED E F	1.5:1	9/19/02	CJB	M060353	A

THE INFORMATION CONTAINED IN THIS DOCUMENT IS PROPRIETARY TO E-SWITCH AND IS NOT TO BE COPIED OR TRANSFERRED