



ANATECH ELECTRONICS INC
RF & Microwave Filters & Products

3500 MHz Ceramic Bandpass Filter

Part Number: AM3500B1490



Electrical specifications

Center Frequency: 3500 MHz
Bandwidth: 100 MHz
VSWR: 15 dB min
Passband: 3450-3550 MHz
Passband Insertion Loss: 2.5 dB max
Passband Ripple: 1.0 dB max
Rejection1: 50 dB min at 3200 MHz
Rejection 2: 50 dB min at 3800 MHz
Power Handling: 1 Watt
Input / Output Impedance: 50 Ohms

Mechanical

Mounting Method: SMT
Dimensions: 22.86 x 12.70 x 4.83 mm

Environmental

Operating Temperature: -30°C to +70°C
Storage Temperature: -50°C to +90°C

This product is RoHs compliant.

Outline Drawing:

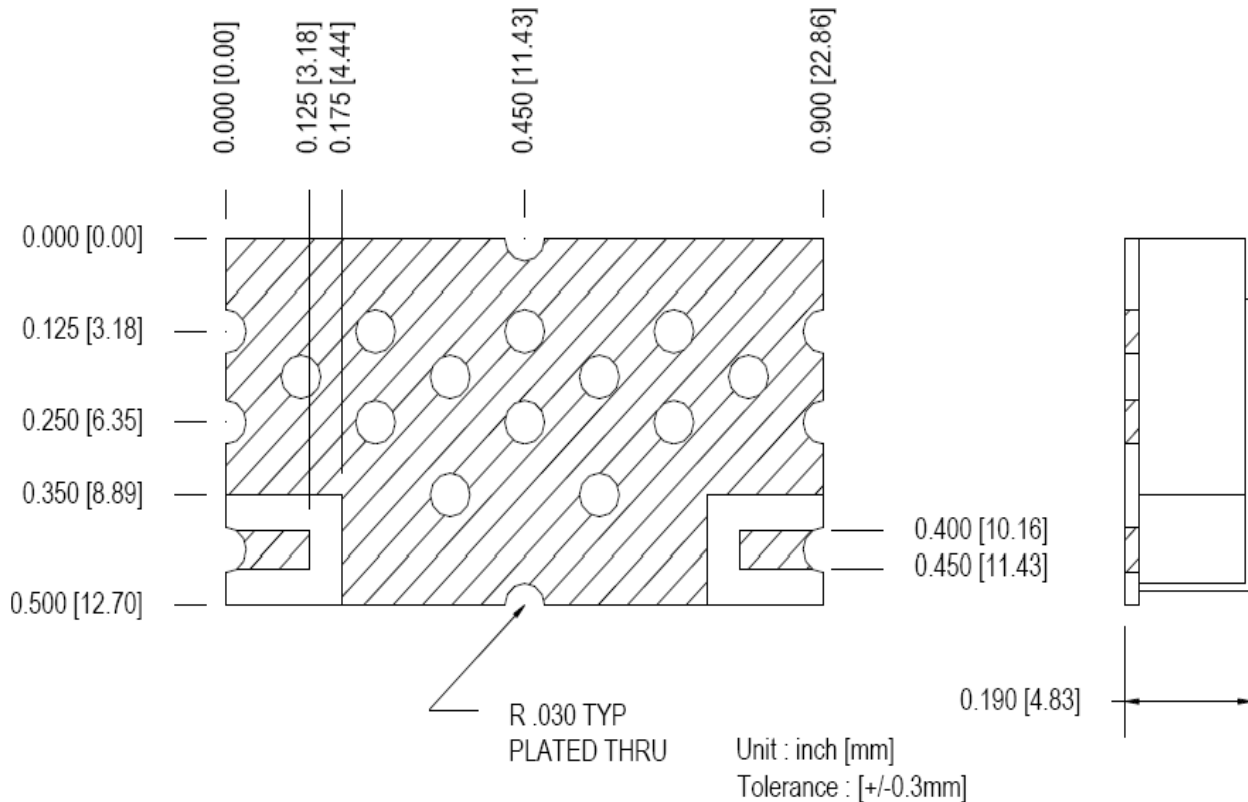



Simulation Plot :

