

|                        |                                      |
|------------------------|--------------------------------------|
| <b>DRAWING NUMBER:</b> | <b>15-216-X-XX</b>                   |
| <b>PRODUCT GROUP:</b>  | TERMINALS                            |
| <b>SUB-GROUP:</b>      | MILITARY NON-INSULATED TERMINALS     |
| <b>DESCRIPTION:</b>    | NON-INSULATED DOUBLE TURRET TERMINAL |

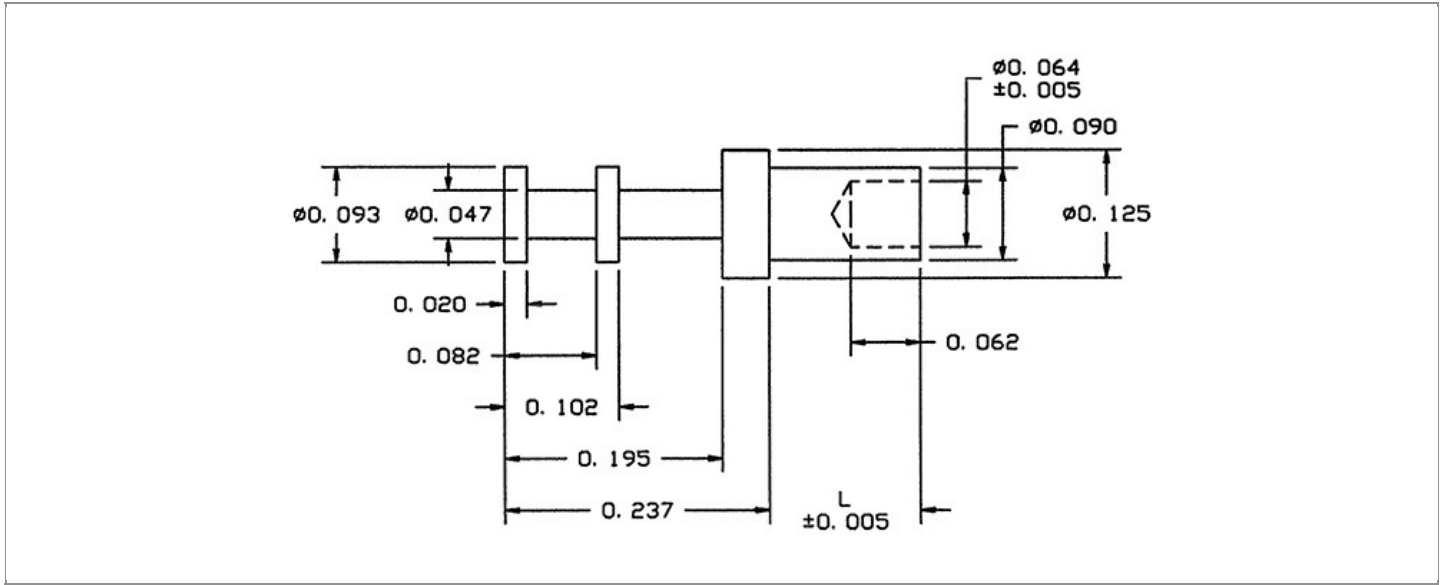

| BOARD / PANEL MOUNTING METHOD | MOUNTING HOLE SIZE | DRILL SIZE | FEED THRU COMBINATION |
|-------------------------------|--------------------|------------|-----------------------|
| SWAGE MOUNT                   | 0.094" ± 0.001     | 3/32"      | N/A                   |

**PART NO. STRUCTURE:**

|             |   |           |   |        |
|-------------|---|-----------|---|--------|
| 15-216      | - | X         | - | XX     |
| PART SERIES |   | DIMENSION |   | FINISH |

**MATERIAL OPTIONS:**

15-216-X-XX

| COMPONENT | MATERIAL | MATERIAL AND SPECIFICATION                 |
|-----------|----------|--|
| TERMINAL  | BRASS    | BRASS PER ASTM B16, ALLOY C36000, 1/2 HARD |

**DIMENSION OPTIONS:**

15-216-X-XX

| DIMENSION | K   | OVERALL LENGTH | SHANK LENGTH (L) | BOARD/PANEL THICKNESS |
|-----------|-----|----------------|------------------|-----------------------|
| 2         | N/A | 0.342"         | 0.105"           | 1/16"                 |
| 3         | N/A | 0.372"         | 0.135"           | 3/32"                 |
| 4         | N/A | 0.402"         | 0.165"           | 1/8"                  |

FINISH - PLATING OPTIONS:

15-216-X-**XX**

| FINISH CODE | COMPONENT | FINISH          | FINISH AND SPECIFICATION   |
|-------------|-----------|-----------------|--|
| 05          | TERMINAL  | ELECTRO-SOLDER  | 0.000300"MIN. ELECTRO-SOLDER PER SAE-AMS-P-81728 OVER 0.000100"MIN. COPPER PER SAE-AMS-2418          |
| 088         | TERMINAL  | BRIGHT TIN-LEAD | 0.000300"MIN. BRIGHT TIN-LEAD (Sn93%-Pb7%) PER ASTM B545 OVER 0.000100"MIN. COPPER PER SAE-AMS-2418  |
| 095         | TERMINAL  | HOT SOLDER DIP  | 0.000100"MIN. HOT SOLDER DIP USING Sn60 PER IPC-J-STD-006 OVER 0.000100"MIN. COPPER PER SAE-AMS-2418 |

TOLERANCES:\*

| DECIMAL | FRACTIONAL | ANGULAR | DRAWING ORIGATION DATE | LAST MODIFICATION DATE |
|---------|------------|---------|------------------------|------------------------|
| ± 0.005 | N/A        | ± 3 °   | 10/22/2002             | 3/1/2017               |

\*All dimensions are in inches.

RoHS COMPLIANCE:

15-216-2-XX

| PART NUMBER  | RoHS COMPLIANT |
|--------------|----------------|
| 15-216-2-05  | NO             |
| 15-216-2-088 | NO             |
| 15-216-2-095 | NO             |

15-216-3-XX

| PART NUMBER  | RoHS COMPLIANT |
|--------------|----------------|
| 15-216-3-05  | NO             |
| 15-216-3-088 | NO             |
| 15-216-3-095 | NO             |

15-216-4-XX

| PART NUMBER  | RoHS COMPLIANT |
|--------------|----------------|
| 15-216-4-05  | NO             |
| 15-216-4-088 | NO             |
| 15-216-4-095 | NO             |

MILITARY REFERENCE SPECIFICATIONS:

15-216-2-XX

| PART NUMBER  | MIL SPECIFICATION | MIL PART NUMBER                            | COMMERCIAL ITEM DESCRIPTION (CID) SPECIFICATION | CID PART NUMBER               |
|--------------|-------------------|--|---|-------------------------------|
| 15-216-2-05  | MIL-T-55155/12    | M55155/12XH04<br>(M55155/12-4S; SE12XC04S) | A-A-59126/12                                    | AA59126/12XH04                |
| 15-216-2-088 | MIL-T-55155/12    | M55155/12XJ04                              | A-A-59126/12                                    | AA59126/12XJ04 (AA59126/1204) |
| 15-216-2-095 | MIL-T-55155/12    | M55155/12XI04                              | A-A-59126/12                                    | AA59126/12XI04                |

15-216-3-XX

| PART NUMBER  | MIL SPECIFICATION | MIL PART NUMBER                            | COMMERCIAL ITEM DESCRIPTION (CID) SPECIFICATION | CID PART NUMBER               |
|--------------|-------------------|--|---|-------------------------------|
| 15-216-3-05  | MIL-T-55155/12    | M55155/12XH05<br>(M55155/12-5S; SE12XC05S) | A-A-59126/12                                    | AA59126/12XH05                |
| 15-216-3-088 | MIL-T-55155/12    | M55155/12XJ05                              | A-A-59126/12                                    | AA59126/12XJ05 (AA59126/1205) |
| 15-216-3-095 | MIL-T-55155/12    | M55155/12XI05                              | A-A-59126/12                                    | AA59126/12XI05                |

Continued on next page...

MILITARY REFERENCE SPECIFICATIONS CONTINUED:

15-216-4-XX

| PART NUMBER  | MIL SPECIFICATION | MIL PART NUMBER                            | COMMERCIAL ITEM DESCRIPTION (CID) SPECIFICATION | CID PART NUMBER               |
|--------------|-------------------|--|---|-------------------------------|
| 15-216-4-05  | MIL-T-55155/12    | M55155/12XH06<br>(M55155/12-6S; SE12XC06S) | A-A-59126/12                                    | AA59126/12XH06                |
| 15-216-4-088 | MIL-T-55155/12    | M55155/12XJ06                              | A-A-59126/12                                    | AA59126/12XJ06 (AA59126/1206) |
| 15-216-4-095 | MIL-T-55155/12    | M55155/12XI06                              | A-A-59126/12                                    | AA59126/12XI06                |

TOOLING:

| INSTALLATION TOOL:<br>ARBOR PRESS | INSTALLATION TOOL:<br>ANVIL<br>(ARBOR PRESS OPERATED) | INSTALLATION TOOL: PRESS-FIT /<br>ROLL SWAGE / RIVET PUNCH<br>(ARBOR PRESS OPERATED) | INSTALLATION TOOL:<br>FLARE SWAGE PUNCH<br>(ARBOR PRESS OPERATED) |
|-----------------------------------|---|--|---|
| TM1                               | TA125-94-23   | TP90-64  | TFLP90-175  |

NOTES:

|                        |
|------------------------|
| <b>DATASHEET NOTES</b> |
|------------------------|

N/A

|                          |
|--------------------------|
| <b>INSTRUCTION NOTES</b> |
|--------------------------|

SEE GENERAL SWAGING INSTALLATION INSTRUCTION ON CONCORD ELECTRONICS' WEBSITE [WWW.CONCORD-ELECTRONICS.COM](http://WWW.CONCORD-ELECTRONICS.COM)