

THIS DRAWING IS UNPUBLISHED. RELEASED FOR PUBLICATION 20
 © COPYRIGHT 20 BY TYCO ELECTRONICS CORPORATION. ALL RIGHTS RESERVED.

LOC	DIST	REVISIONS					
AD	00	P	LTR	DESCRIPTION	DATE	DWN	APVD
		O		REV PER EC 0S12-0230-04	14SEP2004	BC	RP
		A		REV PER ECO-09-006023	12MAR2009	BC	GG
		B		REV PER ECO-15-003703	10MAR2015	SZ	SZ

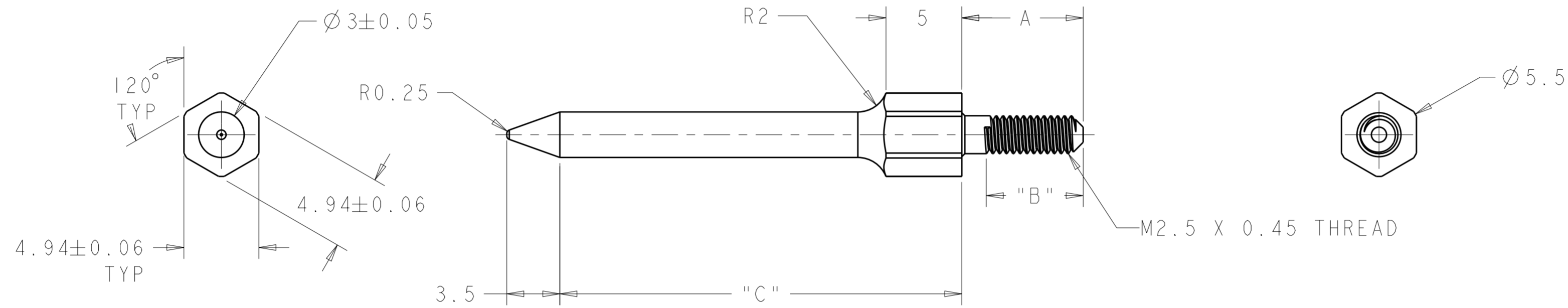

46.5	6.1 - 8.0	8.00	10.00	1469269-8
26.5	6.1 - 8.0	8.00	10.00	1469269-6
26.5	4.1 - 6.0	6.00	8.00	1469269-4
26.5	3.0 - 4.0	4.00	6.00	1469269-2
C	PCB THICKNESS	B MIN	A	PART NUMBER

<small>THIS DRAWING IS A CONTROLLED DOCUMENT FOR TYCO ELECTRONICS CORPORATION. IT IS SUBJECT TO CHANGE AND THE CONTROLLING ENGINEERING ORGANIZATION SHOULD BE CONTACTED FOR THE LATEST REVISION.</small>		DWN 18DEC2002 D. SZCZESNY CHK 14SEP2004 R. PATTERSON APVD 14SEP2004 R. PATTERSON		Tyco Electronics Harrisburg, PA 17105-3608	
DIMENSIONS: mm		TOLERANCES UNLESS OTHERWISE SPECIFIED: 0 PLC ±0.2 1 PLC ±0.2 2 PLC ±0.13 3 PLC ±0.050 4 PLC ±0.0100 ANGLES ± FINISH		NAME REAR ALIGNMENT POST, ATCA	
MATERIAL BRASS		FINISH NICKEL		SIZE A2	
CUSTOMER DRAWING		SCALE 4:1		SHEET 1 OF 1 REV B	